

# The City of Waltham

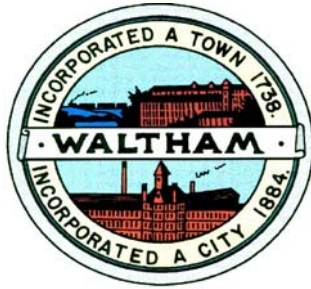

**Invites  
Interested Parties  
To propose the best offer and or bid  
For the service or product herewith described:**

**WATER SERVICE RELOCATIONS,  
1480 / 1490 / 1531 TRAPELO ROAD**

**The bid opening will be held: Thursday November 7, 2013 at 10:00 AM**

*Phone: 781-314-3244, Fax: 781-314-3245*

# **Table of Contents:**

- **Invitation to Bid**
- **Intent of the Project**
- **Agreement**
- **Instructions**
- **General Conditions**
- **Specifications**
- **Compliance**
- **Bid Price**

# Invitation to Bid

**The City of Waltham**  
**Purchasing Department**

**REQUEST FOR BID (RFB)**

Under the rules of M.G.L. Chapter 30B, the Chief Procurement Officer of the City of Waltham Purchasing Department hereby requests sealed bids for:

**WATER SERVICE RELOCATIONS 1480 / 1490 / 1531 TRAPELO ROAD**

Price Proposals will be received at the office of the Purchasing Agent, City Hall, 610 Main Street, Waltham MA 02452, until,

**Thursday November 7, 2013 at 10:00 AM**

At which time and place the bids will be publicly opened and read.

Specifications and information available on line by visiting the Waltham Purchasing Department web site at [www.city.waltham.ma.us/open-bids](http://www.city.waltham.ma.us/open-bids)

**BIDS MUST BE SIGNED AND ENCLOSED IN A SEALED ENVELOPE AND MARKED:**

**BID FOR: *WATER SERVICE RELOCATIONS***

A 5% Bid Bond or Certified Check must accompany each bid submitted and made payable to, and become the property of the City of Waltham, if the successful bidder refuses or neglects to comply with the terms of the Contract.

If the Bidder is a corporation, state your correct corporate name and State of incorporation. If Bidder is a partnership, state names and addresses of partners. If Bidder is a trust or other legal entity, state correct names and addresses of trustees or names and address of those legally authorized to bid and enter into contracts.

**EXCEPTION OR ALTERNATES TO SPECIFICATIONS, TERMS OF SALE, AND DISCOUNTS AVAILABLE, MUST BE INCLUDED IN THE BID PRIOR TO OPENING DATE.**

# Intent of Project

The City of Waltham seeks a contractor to relocate from the existing 8-inch water main to the existing 12-inch water main as shown on the accompanying diagram. Work is for two residential properties and one city sewer pumping station. The 8-inch water main runs along the southern side of the street. The 12-inch water main runs along the northern side of the street. The water service lines will have to pass over/under the 8-inch to attach to the 12-inch while still maintaining cover for the residential properties.

A permit will be required from CPW prior to excavation and it is a restricted street, work is permitted from 9 a.m. to 4 p.m. (Traffic Rules/Regulations Article IV; Sec. 4) Due to the time restrictions for day work, night work may be an option. Interested parties are strongly advised to visit the site prior to submitting a quote.

Utilities are marked using the best information available but must be verified by the contractor.

**AGREEMENT**

**CITY OF WALTHAM**

**ARTICLE 1.** This agreement, made this \_\_\_\_\_ day of \_\_\_\_\_, 2013 by and between the CITY OF WALTHAM, party of the first part, hereinafter called the CITY, by its MAYOR, and

\_\_\_\_\_

\_\_\_\_\_

hereinafter called the CONTRACTOR.

**ARTICLE 2.** Witnesseth, that the parties to this agreement, each in consideration of the agreement on the part of the others herein contained, do hereby agree, the CITY OF WALTHAM for itself, and said contractor for his heirs, executors, administrators and assigns as follows:

To furnish all equipment, machinery, tools and labor, to furnish and deliver all materials required to be furnished (except as otherwise specified) and deliver in and about the project and to do and perform all work in strict conformity with the provisions of this Contract and of the Notice to Bidders, bid, Project Manual, and Drawings hereto annexed. The said Notice to Bidders, bid, Project Manual, and Drawings are hereby made a part of this contract as fully and to the same effect as if the same had been set forth at length and incorporated in the contracts.

**ARTICLE 3.** In consideration of the foregoing premises the CITY agrees to pay and the CONTRACTOR agrees to receive as full compensation for everything furnished and done by the CONTRACTOR under this contract, including all work required by not included in the items herein mentioned, and also for all loss or damage arising out of the nature of the work aforesaid, or from the action of the elements, or from any unforeseen obstruction or difficulty encountered in the prosecution of the work, and for all expenses incurred by or in consequence of the suspension or discontinuance of the work specified, and for well and faithfully completing the work, and the whole thereof, as herein provided, such prices as are set forth in the accompanying bid.

Date for final completion of the project is Sixty (60) days from the date of the Notice-to-Proceed.

This Agreement entered into as of the day and year first written above.

CITY OF WALTHAM, MASSACHUSETTS

**FOR THE CITY**

\_\_\_\_\_  
Jeannette A. McCarthy, MAYOR,  
City of Waltham  
Date: \_\_\_\_\_

\_\_\_\_\_  
John B. Cervone, City Solicitor  
Date: \_\_\_\_\_

APPROVED AS TO FORM ONLY

\_\_\_\_\_  
Stephen Casazza, City Engineer  
Date: \_\_\_\_\_

\_\_\_\_\_  
Joseph Pedulla, Purchasing Agent  
Date: \_\_\_\_\_

\_\_\_\_\_  
Paul Centofanti, Auditor  
Date: \_\_\_\_\_

I CERTIFY THAT SUFFICIENT FUNDS  
ARE AVAILABLE FOR THIS CONTRACT

**FOR THE COMPANY**

\_\_\_\_\_  
CONTRACTOR (Signature),  
Date: \_\_\_\_\_

\_\_\_\_\_  
Company

\_\_\_\_\_  
Address

# Instructions



## INSTRUCTIONS FOR BIDDERS

1. **READ ALL DOCUMENTS.**

Bidders should familiarize themselves with all the documents contained herein; it is mandatory that all Bids be in compliance with all the provisions contained in said documents.

2. **FORMS AND ATTACHMENTS.**

Bids are to be completed on the forms provided **ONLY** and enclosed in a sealed envelope marked on the outside "BID (title)" and the name and address of bidder. Attachments submitted in addition to the Waltham Purchasing Department produced forms may not be considered.

3. **PRINTED OR TYPED RESPONSE.**

All information must be typewritten or printed in ink, including the price the bidder offers in the space as provided on the bid form.

4. **CORRECTIONS.**

Bids that are submitted containing cross outs, white outs or erasures, will be rejected.

All corrections or modifications to the original bid are to be submitted in a separate envelope, properly marked on the outside, "CORRECTION/ MODIFICATION TO BID (title)" and submitted prior to the bid opening.

**ALL DOCUMENTS SUBMITTED WITH YOUR RESPONSE WILL BE INCORPORATED INTO THE CONTRACT.**

5. **PRICE IS ALL INCLUSIVE.**

Bid prices shall encompass everything necessary for furnishing all items, materials, supplies or services as specified, and in accordance with the specifications, including proper packing, cost of delivery, and in the case of services, completion of same, as per specifications.

6. **PRICE DISCREPANCY.**

In the event of a discrepancy between the Unit Price and the Extension, the Unit Price shall prevail.

7. **EXPLANATIONS, EXCEPTIONS**

Explanations, exceptions or other information pertinent to the specifications may be made in writing and included in the same envelope with the bid.

8. **BID DEPOSITS.**

Bid deposits are to be made payable to the City of Waltham. In the event that the successful bidder fails to execute a Contract within (10) days of the receipt of said contract, such security shall be retained by the city as liquidated damages. Unsuccessful bidders' deposits will be returned immediately following the award to said successful bidder.

9. **WITHDRAW.**

A Bid may be withdrawn by written request prior to the schedule for the Bid Opening. No withdrawals are permitted after the bid opening date and time. Withdrawals after the bid opening date will cause the forfeit of the bid Deposit.

10. **AWARD.**

Bids will be awarded not later than (90) ninety days after the scheduled bid opening date, unless otherwise stated, in the specifications. Unless otherwise specified, bids will be evaluated on the basis of, completeness of your RFP response, responsiveness, responsibility, best price and experience.

11. **AWARD CRITERIA.**

Qualified and responsive proposals will be evaluated based on Price, Technical, and Compliance requirements:

12. **DISCOUNTS.**

Discounts for prompt payments will be considered when making awards.

13. **TAX EXEMPT.**

Purchases by the City of Waltham is exempt from any Federal, State or Massachusetts Municipal Sales and/or Excise Taxes.

14. **SAMPLES.**

The City of Waltham may require the submission of samples either before or after the awarding of a contract. Samples are to be submitted, at no charge to the City, so as to ascertain the product's suitability. If specifically stated in the Bid that samples are required, said samples must be submitted with the Bid prior to the Official Bid Opening. Failure to submit said samples would be cause for rejection of Bid. All samples must be

called for and picked up within (30) thirty days of award or said samples will be presumed abandoned and will be disposed of.

15. **ACTIVE VENDOR LIST.**

Vendors who wish to remain on the Active Bid List must either submit a Bid, No Bid, or a letter requesting same, no later than the Official Bid Opening. This is applicable to those vendors who have received the Invitation to Bid.

16. **FUNDS APPROPRIATION.**

**THE CONTRACT OBLIGATION ON BEHALF OF THE CITY IS SUBJECT TO PRIOR APPROPRIATION OF MONIES FROM THE GOVERNMENTAL BODY AND AUTHORIZATION BY THE MAYOR.**

17. **THE AWARDING AUTHORITY RESERVES THE RIGHT TO REJECT ANY OR ALL BIDS, OR ANY PART OF ANY BID, WHICH IN THE OPINION OF THE AWARDING AUTHORITY, IS IN THE BEST INTERESTS OF THE CITY OF WALTHAM.**

18. **THE TAX ATTESTATION CLAUSE, CERTIFICATION OF NON-COLLUSION AND THE CERTIFICATE OF VOTE AUTHORIZATION,** are required by statute and are an integral part of the Invitation for Bid and must be completed and signed by the person submitting the Bid, or by the person/persons who are officially authorized to do so. Failure to do so may disqualify the bid.

19. **STANDARD OF QUALITY.**

Where, in the specifications, one certain kind, type, catalog number, brand or manufacturer of material is named, it shall be regarded as the required standard of quality. Where two or more are named, these are presumed to be equal and the Bidder may select one or the other. If the Bidder proposes to offer a substitute as an equal, he shall so indicate on the Bid Form, the kind, type, catalog number, brand, or manufacturer of material that is offered as an equal, and describe where it differs from the specifications. Substituted items must be capable of performing all the functions and/or operational features described or indicated in the specifications. Failure to indicate the description of any substitute item on the Bid will be interpreted to mean that the Bidder will furnish the item or service as specified.

**20. MODIFICATION.**

No agreement, understanding, alteration or variation of the agreement, terms or provisions herein contained shall bind the parties, hereto unless made and executed in writing by the parties hereto.

**21. ASSIGNMENT.**

The final payment for work done under this Contract shall be made only after the Contractor has signed a statement under the penalty of perjury, certifying that he has completed the work described in the final estimate. Neither party hereto shall assign this Contract or sublet it in part or as a whole without the prior written consent of the other party hereto. The Contractor shall not assign any sum or sums due or becoming due to him hereunder without the prior written consent of the City.

**22. DELIVERIES:**

a) The Contractor shall pay all freight and delivery charges. The Waltham Purchasing Department does not pay for shipping and packaging expenses. Items must be delivered as stipulated in the specifications. All deliveries must be made to the inside of city buildings. Sidewalk deliveries will not be accepted. City personnel are not required to assist in the deliveries and contractors are cautioned to notify their shippers that adequate assistance must be provided at the point of delivery, when necessary.

b) All items of furniture must be delivered inside the building, set up, in place and ready for use. Deliveries are to be made between the hours of 8:30 a.m. and 3:00 p.m., Monday through Friday, except on holidays.

c) All damaged items, or items which do not comply with specifications will not be accepted and title therefore will not vest to the Waltham Purchasing Department until such items are accepted and signed for, in good order, by the receiving department.

d) The contractor must replace, without further cost to the Waltham Purchasing Department, such damaged or non-complying items before payment will be made.

**23. LABELING.**

All packages cartons or other containers must be clearly marked with (a) building and room destination; (b) description of contents of item number from specifications; (c) quantity; (d) City of Waltham Purchase Order Number and (e) Vendor's name and order number.

**24. GUARANTEES.**

Unless otherwise stipulated in the specifications, furniture, equipment and similar durable items shall be guaranteed by the contractor for a period of not less than one year from the date of delivery and acceptance by the receiving department. In addition, the manufacturer's guarantee shall be furnished. Any items provided under this contract which are or become defective during the guarantee period shall be replaced the contractor free of charge with the specific understanding that all replacements shall carry the same guarantee as the original equipment. The contractor shall make such replacement immediately upon receiving notice from the Purchasing Agent.

**25. SINGLE VENDOR.**

The Waltham Purchasing Department desires to award a single contract based on the Grand Total Price. However, where applicable, the City reserves the right to make multiple awards on a unit price basis if, in the opinion of the Waltham Purchasing Department, it is in the best interest of the Waltham Purchasing Department.

**26. CHANGE ORDERS.**

Change orders are not effective until, if, as and when signed by the Mayor and no work is to commence until the change orders are fully executed.

**28. BID OPENING INCLEMENT WEATHER**

If, at the time of the originally scheduled bid opening, City Hall is closed to inclement weather or another unforeseeable event, the bid opening will be extended until 2:00 PM on the next normal business day. Bids will be accepted until that date and time.

# **GENERAL CONDITIONS**

## GENERAL CONDITIONS

**1. INFORMATION**

All information shall come from the Office of the City Purchasing Agent. The Contractor shall inquire at this office for any information needed. Wherever the words “or equal as approved” are used, it is to be understood that the opinion of the City Purchasing Agent shall govern.

**2. SUITS**

The Contractor shall assume defense of and shall indemnify and hold the City and its agents harmless from all suits and claims against the City and its sub-contractors arising from the use of any invention, patent right labor or employment, or from any act of omission or neglect of the City, its agents, employees or any subcontractor in performing the work, under this contract.

**3. LAWS AND REGULATIONS**

The Contractor shall conform to all the applicable rules, regulations, laws and ordinances of the City of Waltham, the Commonwealth of Massachusetts, the United States of America and all agencies having jurisdiction over this contract.

**4. PROTECTION OF PROPERTY**

The Contractor shall take all proper precautions to protect the City’s property from damage and unnecessary inconvenience. Any City property damaged by the Contractor in carrying out the provisions of this contract shall be restored to its original condition, by and at the expense of the Contractor.

**5. PROTECTION OF PERSONS**

The Contractor shall take all proper precautions to protect persons from injury, unnecessary inconvenience, and shall be responsible for his failure to do so. The Contractor agrees to hold the City harmless from any and all liabilities of every nature and description, which may be suffered through bodily injury, including death, to any person, by reason of negligence of the Contractor, his agents or employees, or any subcontractor.

**6. CONTRACT DURATION.**

This contract is for the period required to complete the project, to the City’s satisfaction, excluding the guarantee period.

7. INSURANCE

A. **WORKMAN'S COMPENSATION:** The Contractor shall provide insurance for the payment of compensation and furnishing of other benefits under Chapter 152 of the General Laws of the Commonwealth of Massachusetts to all persons to be employed under this contract, the premiums for which shall be paid by the Contractor. Contractors shall provide insurance on a primary basis and the contractor's policy shall be exhausted before resorting to other policies. The contractor's policy is the primary one not the contributory.

B. **COMPREHENSIVE GENERAL LIABILITY**

Bodily Injury:	\$1,000,000 Each Occurrence
	\$2,000,000 Aggregate
Property Damage:	\$1,000,000 Each Occurrence
	\$2,000,000 Aggregate

C. **AUTOMOBILE (VEHICLE) LIABILITY**

Bodily Injury	\$2,000,000 Each Occurrence
Property Damage	\$1,000,000 Aggregate

D. **UMBRELLA POLICY**

General liability	\$1,000,000
-------------------	-------------

Your bid response must include a Certificate of Insurance with the above limits as a minimum. In addition, the Certificate of Insurance must have the following text contained in the bottom left box of the Certificate: *"The City of Waltham is a named additional insured for all insurances under the contract, excluding Automobile and Workers Compensation coverage"*. **Failure by the contractor to provide a current and updated insurance policy, during the entire duration of the contract, may result in additional legal liability.** The Certificate of Insurance must be mailed directly to:

Office of the Purchasing Agent  
Purchasing Department  
City of Waltham  
610 Main Street  
Waltham, MA 02452



**8. LABOR AND MATERIALS BOND**

The Contractor agrees to execute and deliver to the City, a Labor and Materials or Payment Bond equal to 50% of the contract value. This contract shall not be in force until said bond has been delivered and accepted by the City. Bond to be issued by a company licensed by the Commonwealth of Massachusetts.

**A LETTER FROM A SURETY COMPANY CERTIFYING THAT THE CONTRACTOR IS QUALIFIED AND CAPABLE OF OBTAINING THE ABOVE BONDS MUST BE INCLUDED WITH HIS/HERS BID.**

**9. PERSONNEL:**

The Contractor shall employ a competent supervisor and all properly licensed personnel necessary to perform the services required in this contract. The City Purchasing Agent shall have the right to require the Contractor to remove and/or replace any of the personnel for nonperformance or for unprofessional behavior. The City Purchasing Agent may require the Contractor to submit a weekly performance record of the areas and of the work performed, on forms approved by the City Purchasing Agent. The Contractor or his supervisor shall be available to inspect such work as required by the City Purchasing Agent.

**10. PREVAILING WAGES**

The Contractor is required to pay the prevailing wages as determined under the provisions of Chapter 149, Sections 26 and 27D of the Massachusetts General Laws, including the submission of weekly payrolls to the awarding authority. The Prevailing Wage Schedule is too large to attach here. The prevailing wage schedule can be found at [www.city.waltham.ma.us/open-bids](http://www.city.waltham.ma.us/open-bids).

**11. MATERIALS**

The City or its Agent reserves the right to approve or reject any supplies, material or equipment used by the Contractor. The Contractor agrees to replace any supplies, material or equipment used by the Contractor. The Contractor agrees to replace any rejected supplies, materials or equipment, to the satisfaction of the City or its Agents.

**12. TERMINATION OF CONTRACT**

This contract may be terminated by the City upon deliverance to the Contractor of a five-day written notice of said termination.

**13. CONTRACT OBLIGATIONS**

Contract obligations on behalf of the City are subject to an annual appropriation to cover the contract obligation.

**14. BIDDER EXPERIENCE EVALUATION**

Each bidder shall submit with his bid, all the information relative to their experience and qualifications in performing the work required under this contract and shall have been in business for a minimum of five (5) years, in order for their bid to be considered.

**15. NOT-TO-EXCEED AMOUNT**

The bid amount proposed in your company's response is a "not-to- Exceed" amount unless the City makes changes, in writing, to the scope of work to be performed. The Change Order must be signed and approved by the City's Purchasing Agent, City Auditor, Law Department and the Mayor prior to the commencement of the change order work. No work is to begin until the proper approvals have been obtained. A change order will be priced at the unit price. Failure to comply with this procedure will result in the cancellation of the contract and the non-payment of services provided

**16. FINANCIAL STATEMENTS.**

The City may require, within five (5) days after the bid opening, a complete and detailed Financial Statement prepared by a Certified Public Account, to determine a bidder's financial stability.

**17. BREACH OF CONTRACT/ NON PERFORMANCE**

If the Contractor shall provide services in a manner, which is not to the satisfaction of the City, the City may request that the Contractor refurnish services at no additional cost to the City until approved by the City. If the Contractor shall fail to provide services, which are satisfactory to the City, the City in the alternative may make any reasonable purchase or Contract to purchase services in substitution for those due from the Contractor. The City may deduct the cost of any substitute Contract for nonperformance of services together with incidental and consequential damages from the Contract price

and shall withhold such damages from sums due or to become due to the Contractor. If the damages sustained by the City exceed sums due or to become due, the Contractor shall pay the difference to the City upon demand. The Contractor shall not be liable for any damages sustained by the City due to the Contractor's failure to furnish services under the terms of this Contract if such failure is in fact caused by the occurrence of a contingency the nonoccurrence of which was a basic assumption under which this Contract was made, including a state of war, embargoes, expropriation of labor strike or any unanticipated federal, state or municipal governmental regulation of order, provided that the Contractor has notified the City in writing of such cause within seven (7) days after its occurrence.

**18 RIGHT TO AUDIT**

The City of Waltham has the right to review and audit documents related to this contract. This right extends to any subcontractor, supplier or other entity used by the prime contractor to fulfill the obligations under this contract.

**19. CITY ORDINANCE. APPROVAL OF CONTRACTS BY MAYOR, SEC. 3-12 OF THE CITY ORDINANCES.**

All contract made by any department, board or commission where the amount involved is two thousand dollars (\$2,000) or more shall be in writing, and no such contract shall be deemed to have been made or executed until the approval of the Mayor is affixed thereto. Any construction contract shall, and all other contracts may, where the contract exceed five thousand dollars (\$5,000) be required to be accompanied by a bond with sureties satisfactory to the Mayor.

**NOTE**

**Failure to submit any of the required documents, in this or in other sections, with your bid response package may cause the disqualification of your proposal**

# Specifications

## SCOPE OF WORK:

- Work shall conform to the attached details.
- The lump sum price shall include:
  - traffic management plan and schedule
  - saw cut existing bituminous/asphalt roadway
  - excavation for water services
  - new 1" water service taps on 12" water main (3 locations)
  - installation of ~ 80-feet of 1" copper water service pipe (3 locations)
  - No(s): 1480/1490 pass over/under the 8" main to the 12" main
  - No. 1531 cut/cap on the 8" main and tap 12" main, install 1" water service into new curb box and transition existing iron service into new installation this must be coordinated with Pump Station staff /activities.
  - new curb stop boxes (3 locations)
  - No(s): 1480/1490 existing curb boxes are to remain / utilized
  - suitable backfill
  - compaction
  - resetting of existing curb (two locations)
  - temporary 3" pavement for trench repair
  - permanent resurfacing (4 1/2" deep in three lifts) at a later date
  - permanent replacement of 4" thick concrete sidewalk (with fibremesh)
  - replacement of any damaged landscaping incl. loam and seed
  - safety signing and other traffic management devices
  - all equipment, materials and labor to complete the work
- Protect stone walls, to prevent damage do not touch / no work shall occur.
- All trenches must be backfilled at the end of the day. No plates may be left overnight.
- Traffic police shall be paid by the *contractor* and reimbursed dollar for dollar following proof of payment. Proposal shall include a \$3,000 allowance for police.
- The City of Waltham shall verify the purpose of water gates on both of the water mains / area in case of emergency.
- The contractor shall take ties to newly installed water service connections.

## PAYMENT:

Payment shall be made upon receipt of invoices for work this season (Fall/Winter 2013) and another payment following permanent pavement in the Spring of 2014.

# Compliance

(Required Documents.)

# Compliance

The compliance documents in this section must be completed, signed and returned **with your bid package.**

## Purchasing Department

City of Waltham  
610 Main Street  
Waltham, MA 02452

Failure to submit the completed documents will cause the disqualification of the proposal.

### Section Index

	Check when Complete
• Non-collusion form and Tax Compliance form.....	_____
• Corporation Identification Form.....	_____
• Certificate of Vote Authorization.....	_____
• Certificate of Insurance (showing all limits of WC &GL).....	_____
• Three (3) References.....	_____
• 5% Bid Bond or Certified Check.....	_____
• Debarment Certificate .....	_____
• Prevailing Wage Certificate.....	_____
• Right-to-know Law.....	_____
• OSHA 10 Certificate for all Assigned Employees (MGL ch30, §39M and Ch 149)	_____

**Before the commencement of the Job, the contractor must provide to the above office:**

- Performance Bond for 50% of the contract value and naming the City of Waltham ***(letter must be included with your response)***

Your Company's Name: \_\_\_\_\_

Service or Product Bid \_\_\_\_\_

**NOTE:** Failure to submit any of the required documents, in this or in other sections, with your bid response package may cause the disqualification of your proposal.

**NON-COLLUSION FORM AND TAX COMPLIANCE FORM**

**CERTIFICATE OF NON-COLLUSION**

The undersigned certifies under penalties of perjury that this bid or proposal has been made and submitted in good faith and without collusion or fraud with any other person. As used in this certification, the word "person" shall mean any natural person, business, partnership, corporation, union, committee, club, or other organization, entity or group of individuals. The undersigned certifies that no representations made by any City officials, employees, entity, or group of individuals other than the Purchasing Agent of the City of Waltham was relied upon in the making of this bid

\_\_\_\_\_, \_\_\_\_\_  
(Signature of person signing bid or proposal)      Date

\_\_\_\_\_  
(Name of business)

---

**TAX COMPLIANCE CERTIFICATION**

Pursuant to M.G.L. c. 62C, & 49A, I certify under the penalties of perjury that, to the best of my knowledge and belief, I am in compliance with all laws of the Commonwealth relating to taxes, reporting of employees and contractors, and withholding and remitting child support.

\_\_\_\_\_, \_\_\_\_\_  
Signature of person submitting bid or proposal      Date

\_\_\_\_\_  
Name of business

**NOTE**

Failure to submit any of the required documents, in this or in other sections, with your bid response package may cause the disqualification of your proposal.



**CERTIFICATE OF VOTE OF AUTHORIZATION**

Date:

I \_\_\_\_\_, Clerk of \_\_\_\_\_ hereby certify that at a meeting of the Board of Directors of said Corporation duly held on the \_\_\_\_\_ day of \_\_\_\_\_ at which time a quorum was present and voting throughout, the following vote was duly passed and is now in full force and effect:

VOTED: That \_\_\_\_\_ (*name*) is hereby authorized, directed and empowered for the name and on behalf of this Corporation to sign, seal with the corporate seat, execute, acknowledge and deliver all contracts and other obligations of this Corporation; the execution of any such contract to be valid and binding upon this Corporation for all purposes, and that this vote shall remain in full force and effect unless and until the same has been altered, amended or revoked by a subsequent vote of such directors and a certificate of such later vote attested by the Clerk of this Corporation.

I further certify that \_\_\_\_\_ is duly elected/appointed \_\_\_\_\_ of said corporation

SIGNED:

(Corporate Seal)

\_\_\_\_\_  
Clerk of the Corporation:

Print Name: \_\_\_\_\_

\_\_\_\_\_  
**COMMONWEALTH OF MASSACHUSETTS**

County of \_\_\_\_\_

Date:

Then personally appeared the above named and acknowledged the foregoing instrument to be their free act and deed before me, \_\_\_\_\_

Notary Public;

My Commission expires: \_\_\_\_\_

## CORPORATION IDENTIFICATION

The bidder for the information of the Awarding Authority furnishes the following information.

**If a Corporation:**

Incorporated in what state \_\_\_\_\_

President \_\_\_\_\_

Treasurer \_\_\_\_\_

Secretary \_\_\_\_\_

Federal ID Number \_\_\_\_\_

**If a foreign (out of State) Corporation** – Are you registered to do business in Massachusetts?

Yes \_\_\_\_\_, No \_\_\_\_\_

If you are selected for this work you are required under M.G.L.ch. 30S, 39L to obtain from the Secretary of State, Foreign Corp. Section, State House, Boston, a certificate stating that you Corporation is registered, and furnish said certificate to the Awarding Authority prior to the award.

**If a Partnership: (Name all partners)**

Name of partner \_\_\_\_\_

Residence \_\_\_\_\_

Name of partner \_\_\_\_\_

Residence \_\_\_\_\_

**If an Individual:**

Name \_\_\_\_\_

Residence \_\_\_\_\_

**If an Individual** doing business under a firm's name:

Name of Firm \_\_\_\_\_

Name of Individual \_\_\_\_\_

Business Address \_\_\_\_\_

Residence \_\_\_\_\_

Date \_\_\_\_\_

Name of Bidder \_\_\_\_\_

By \_\_\_\_\_

Signature

\_\_\_\_\_

Title

Business Address

(POST OFFICE BOX NUMBER NOT ACCEPTABLE)

City

State

Telephone Number

Today's Date

**CORI CHECK VERIFICATION**

**NOTICE TO ALL CONTRACTORS**

ALL CONTRACTORS AWARDED A CONTRACT MUST PROVIDE THE WALTHAM PURCHASING DEPARTMENT WRITTEN CONFIRMATION OF ITS FULL COMPLIANCE WITH M.G.L. CHAPTER 71, SECTION 38R, WHICH REQUIRES CORI CHECKS FOR ALL SCHOOL EMPLOYEES AND VOLUNTEERS, AS WELL AS ANY AND ALL CONTRACTORS OF ANY KIND, OR LABORERS WHO PERFORM WORK ON SCHOOL GROUNDS, AND WHO MAY HAVE DIRECT AND UNMONITORED CONTACT WITH CHILDREN PLEASE SIGN BELOW TO INDICATE THAT THE ABOVE MASSACHUSETTS GENERAL LAW HAS BEEN ADDRESSED BY YOUR COMPANY.

PLEASE SIGN BELOW TO INDICATE THAT THE ABOVE MASSACHUSETTS GENERAL LAW HAS BEEN ADDRESSED BY YOUR COMPANY

---

COMPANY NAME: \_\_\_\_\_

ADDRESS: \_\_\_\_\_

Signature \_\_\_\_\_, Date \_\_\_\_\_

Print Name \_\_\_\_\_, Title \_\_\_\_\_

**NOTE**

Failure to submit any of the required documents, in this or in other sections, with your bid response package may cause the disqualification of your proposal.

**PROVIDE THREE (3) SERVICE APPROPRIATE REFERENCES**

1. Company Name:

Address:

Contact Name:

Phone #

Type of service/product provided to this Company:

Dollar value of service provided to this Company:

2. Company Name:

Address:

Contact Name:

Phone #

Type of service/product provided to this Company:

Dollar value of service provided to this Company:

3. Company Name:

Address:

Contact Name:

Phone #

Type of service/product provided to this Company:

Dollar value of service provided to this Company:

**NOTE**

**Failure to submit any of the required documents, in this or in other sections, with your bid response package will be cause for the disqualification of your company.**

**WEEKLY PAYROLL RECORDS REPORT &  
STATEMENT OF COMPLIANCE**

In accordance with Massachusetts General Law c. 149, §27B, a true and accurate record must be kept of all persons employed on the public works project for which the enclosed rates have been provided, A Payroll Form has been printed on the reverse of this page and includes all the information required to be kept by law. Every contractor or subcontractor is required to keep these records and preserve them for a period of three years from the date of completion of the contract.

In addition, every contractor and subcontractor is required to submit, on a weekly basis, a copy of his or her weekly payroll records to the awarding authority. For every week in which an apprentice is employed, a photocopy of the apprentice's identification card must be attached to the payroll report. Once collected, the awarding authority is also required to preserve those reports for three years.

In addition, each such contractor, subcontractor, or public body shall furnish to the awarding authority directly, within fifteen days after completion of its portion of the work, a statement, executed by the contractor, subcontractor or public body who supervises the payment of wages, in the following form:

---

**STATEMENT OF COMPLIANCE**

\_\_\_\_\_, 200\_\_

I \_\_\_\_\_, \_\_\_\_\_  
(Name of signatory party) (Title)

I do hereby state that I pay or supervise the payment of the persons employed by

\_\_\_\_\_ on the \_\_\_\_\_  
(Contractor, subcontractor or public body) (Building or project)

and that all mechanics and apprentices, teamsters, chauffeurs and laborers employed on said project have been paid in accordance with wages determined under the provisions of sections twenty-six and twenty-seven of chapter one hundred and forty nine of the General Laws.

Signature \_\_\_\_\_, Title \_\_\_\_\_

Print \_\_\_\_\_

WEEKLY PAYROLL REPORT FORM

Company Name: \_\_\_\_\_  
 Project Name: \_\_\_\_\_  
 Awarding Auth.: \_\_\_\_\_  
 Work Week Ending: \_\_\_\_\_

Prime Contractor  
 Subcontractor  
 List Prime Contractor: \_\_\_\_\_

Employer Signature: \_\_\_\_\_  
 Print Name & Title: \_\_\_\_\_

Final Report

Employee Name & Address	Work Classification	(A) Hours Worked							(B) Hourly Base Wage	(C) Employer Contributions			(F) [B+C+D+E] Hourly Total Wage (prev. wage)	(G) [A*F] Weekly Total Amount		
		S	M	T	W	T	F	S		(C) Health & Welfare	(D) Pension	(E) Supp. Unemp.				

NOTE: Every contractor and subcontractor is required to submit a copy of their weekly payroll records to the awarding authority.

**RIGHT TO KNOW LAW**

Any vendor who receives an order or orders resulting from this invitation agrees to submit a Material Safety Data Sheet (MSDS) for each toxic or hazardous substance or mixture containing such substance, pursuant to M.G.L. c. 111F, §§8,9 and 10 and the regulations contained in 441 CMR 21.06 when deliveries are made. The vendor agrees to deliver all containers properly labeled pursuant to M.G.L. c. 111F §7 and regulations contained in 441 CMR 21.05. Failure to furnish MSDS and/or labels on each container may result in civil or criminal penalties, including bid debarment and action to prevent the vendor from selling said substances, or mixtures containing said substances within the Commonwealth. All vendors furnishing substances or mixtures subject to Chapter 111F or M.G.L. are cautioned to obtain and read the laws, rules and regulations referenced above. Copies may be obtained from the State House Bookstore, Secretary of State, State House, Room 117, Boston, MA (617) 727-2834.

---

Authorized Signature Indicating Compliance with the Right-to-know laws:

---

Signature

Date

---

Print Name

**NOTE**

Failure to submit any of the required documents, in this or in other sections, with your bid response package may cause the disqualification of your proposal.

## DEBARMENT CERTIFICATION

In connection with this bid and all procurement transactions, by signature thereon, the respondent certifies that neither the company nor its principals are suspended, debarred, proposed for debarment, declared ineligible, or voluntarily excluded from the award of contracts, procurement or non procurement programs from the Commonwealth of Massachusetts, the US Federal Government and /or the City of Waltham. "Principals" means officers, directors, owners, partners and persons having primary interest, management or supervisory responsibilities with the business entity. Vendors shall provide immediate written notification to the Purchasing Agent of the City of Waltham at any time during the period of the contract of prior to the contract award if the vendor learns of any changed condition with regards to the debarment of the company or its officers. This certification is a material representation of fact upon which reliance will be placed when making the business award. If at any time it is determined that the vendor knowingly misrepresented this certification, in addition to other legal remedies available to the city of Waltham, the contract will be cancelled and the award revoked.

---

Company Name \_\_\_\_\_

Address \_\_\_\_\_

City \_\_\_\_\_, State \_\_\_\_\_, Zip Code \_\_\_\_\_

Phone Number (\_\_\_\_) \_\_\_\_\_

E-Mail Address \_\_\_\_\_

Signed by Authorized Company Representative:

\_\_\_\_\_

Print name \_\_\_\_\_,

Date \_\_\_\_\_



**10 HOURS OSHA TRAINING CONFIRMATION**

**Chapter 306 of the Acts of 2004**

**CONSTRUCTION PROJECTS**

**AN ACT RELATIVE TO THE HEALTH AND SAFETY ON PUBLIC**

The undersigned hereby certifies that all employees to be employed at a worksite for construction, reconstruction, alteration, remodeling, repair, installation, demolition, maintenance or repair of any public work or any public building estimated to cost more than \$10,000.00 have successfully completed a course in construction safety and health approved by the **United States Occupational Safety and Health Administration** that is at least **10 hours** in duration at the time the employee begins work and who shall furnish documentation of successful completion of said course with the first payroll report for each employee and will comply with all laws and regulations applicable to awards of subcontracts subject to section 44F.

Company Name: \_\_\_\_\_

Address: \_\_\_\_\_

Signature: \_\_\_\_\_

Title: \_\_\_\_\_

Print Name \_\_\_\_\_

\_\_\_\_\_  
Date

***See Chapter 306 of the Acts of 2004***

**NOTE**

**Failure to submit any of the required documents, in this or in other sections, with your bid response package will be cause for the disqualification of your company.**

# **BID PRICE FORM**

**(Follows)**

**PRICE SHEET**

My company offers the following unit price inclusive of all the expenses, installation, delivery, training etc. as described in the specifications of this document for the ***WATER SERVICE RELOCATIONS 1480 / 1490 / 1531 TRAPELO ROAD***

<b>Base Bid Amount</b>	\$ _____
Plus Police Details Allowance of	\$ _____ \$ 5,000.00
<b>GRAND TOTAL</b>	\$ _____

---

**Company Name:** \_\_\_\_\_

**Company Address:** \_\_\_\_\_

**Company Contact:** \_\_\_\_\_

**Email Contact:** \_\_\_\_\_

**Phone Contact:** \_\_\_\_\_

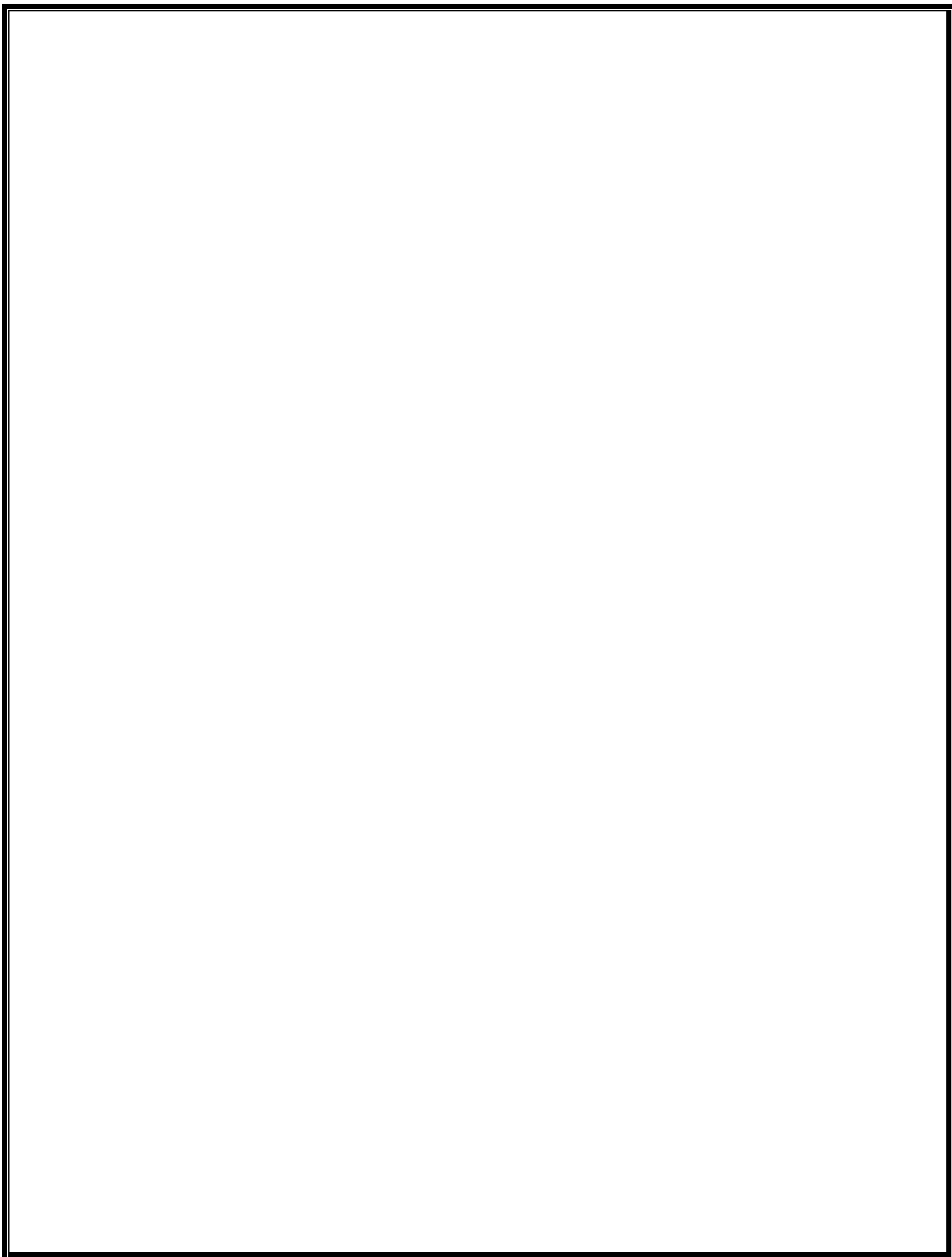

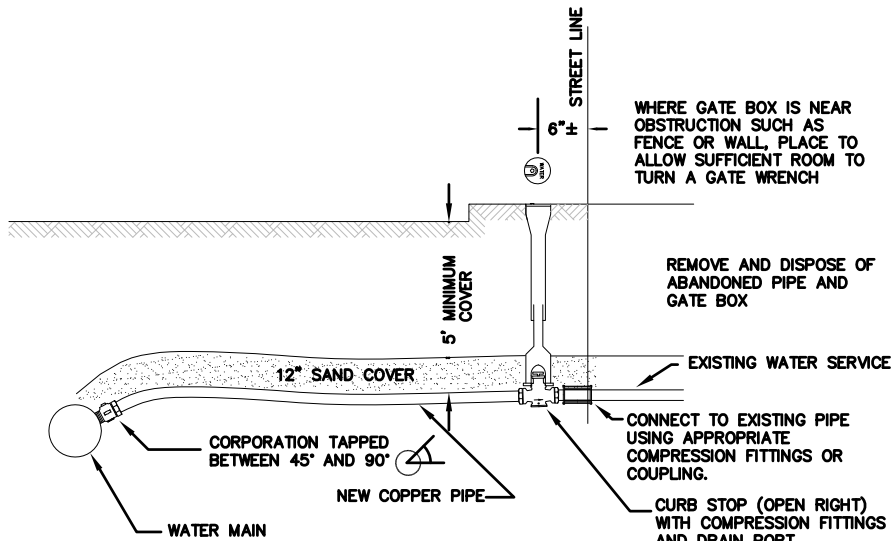

WATER SERVICE DETAIL

PRIOR TO FINISH PAVING, CUT SQUARE EDGES AT EXISTING PAVEMENT, AT LEAST SIX INCHES BEYOND OUTERMOST DISTURBED PAVEMENT.

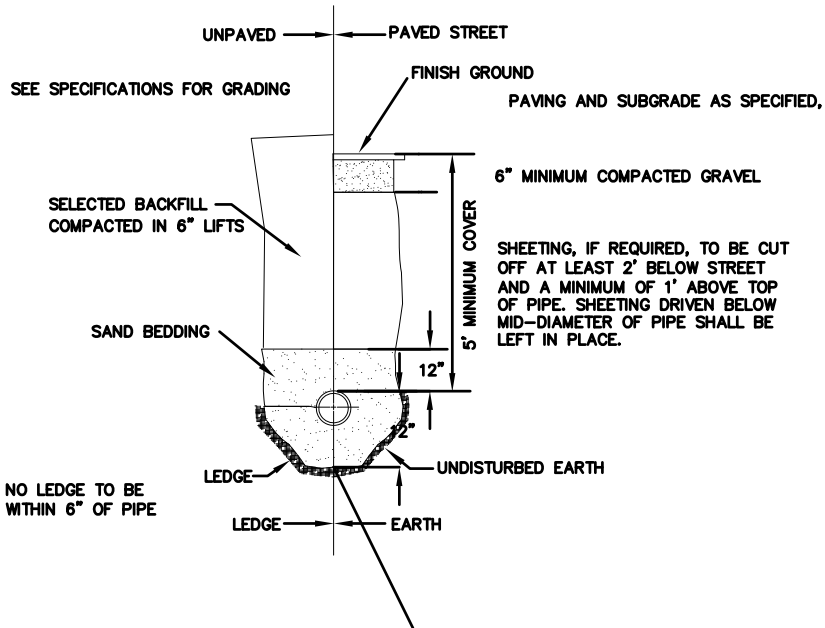

WATER TRENCH DETAIL

DWG FILE: \\Powervault\nasshare\Scans\CBS\Details\standard detail 2013.dwg

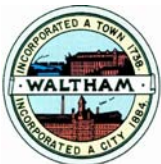

CITY OF WALTHAM, MA.  
ENGINEERING DEPARTMENT

STANDARD DETAILS

WATER DETAILS (1)

302.100

Sheet No.  
302.100

Scale  
NTS

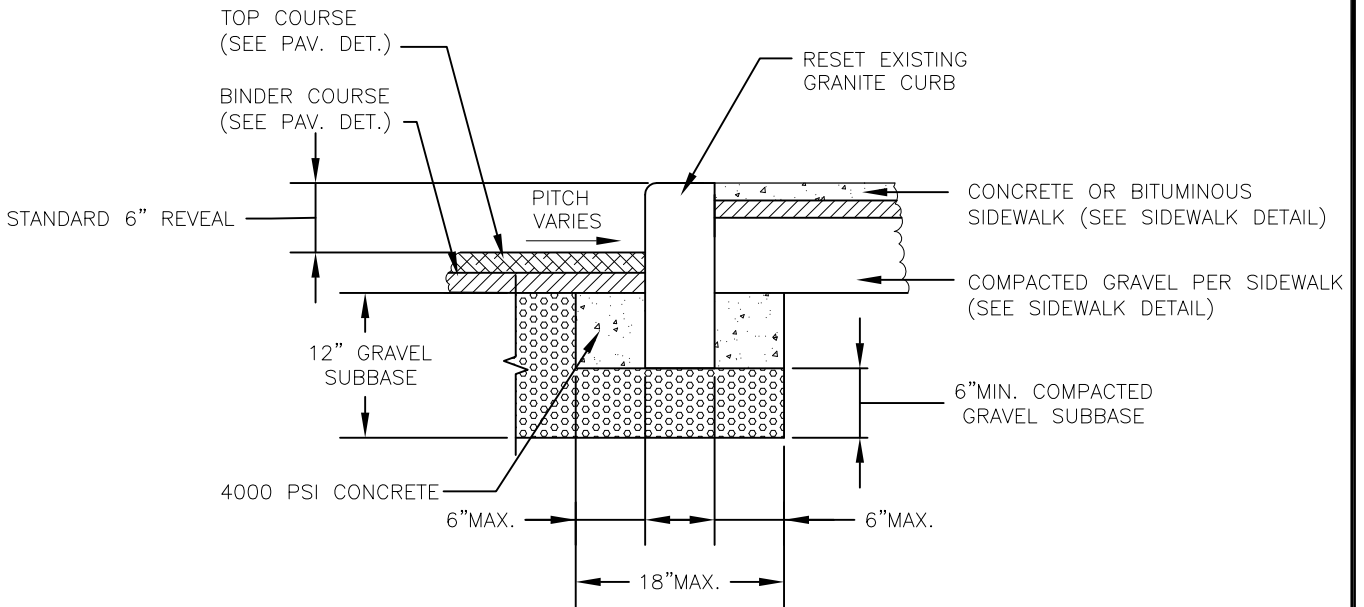

### GRANITE CURB DETAIL

NOT TO SCALE

DWG FILE: \\Powervault\ncasshare\Scans\CBS\Details\standard detail 2013.dwg

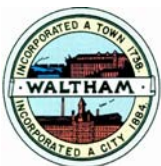

CITY OF WALTHAM, MA.  
ENGINEERING DEPARTMENT

STANDARD DETAILS

GRANITE CURB DETAIL

504.000 - 504.101

Sheet No.  
504.000

Scale  
NTS

# TRAPELO ROAD UTILITY PLAN

### Legend

- |                         |                      |                   |                     |
|-------------------------|----------------------|-------------------|---------------------|
| <b>Water Structures</b> |                      | <b>WaterLines</b> |                     |
| ●                       | Gate Valve - Hydrant | —                 | Fire                |
| ⊕                       | Gate Valve           | —                 | Water Main          |
| ⊕                       | Hydrant              | —                 | Service             |
| ⊕                       | Pipe-End, Plug       | <b>DrainLines</b> |                     |
| <b>Sewer Structures</b> |                      | —                 | Catch Basin Lateral |
| ■                       | Pump Station         | →                 | Gravity             |
| ⊕                       | Sewer Manhole        | →                 | Culvert             |
| <b>Drain Structures</b> |                      | —                 | Leaching Galley     |
| □                       | Area Drain           | →                 | Open Ditch          |
| ⊕                       | Drain Manhole        | →                 | Roof Drain          |
| □                       | Catch Basin          | <b>SewerLines</b> |                     |
| □                       | Headwall             | —                 | Force Main          |
| ⊕                       | Inlet                | →                 | Gravity Main        |
| ⊕                       | Junction             | →                 | Service             |
| ●                       | Outfall, Outlet      | —                 | Stream              |
| ⊕                       | Separator            | —                 | Easement Lines      |
|                         |                      | ■                 | Building Footprints |
|                         |                      | ■                 | Water Bodies        |
|                         |                      | ■                 | Wetland Area        |
|                         |                      | ■                 | Vegetated Area      |

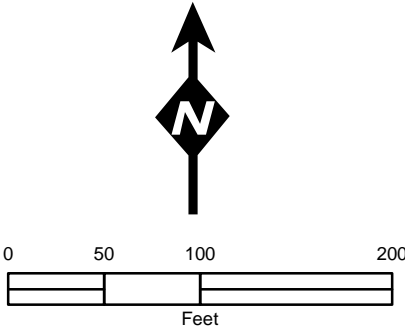

1 inch = 100 feet

Map No.

**6**

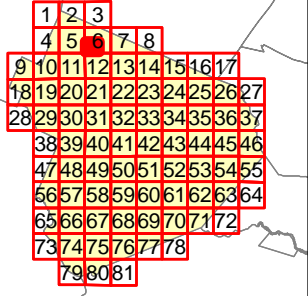
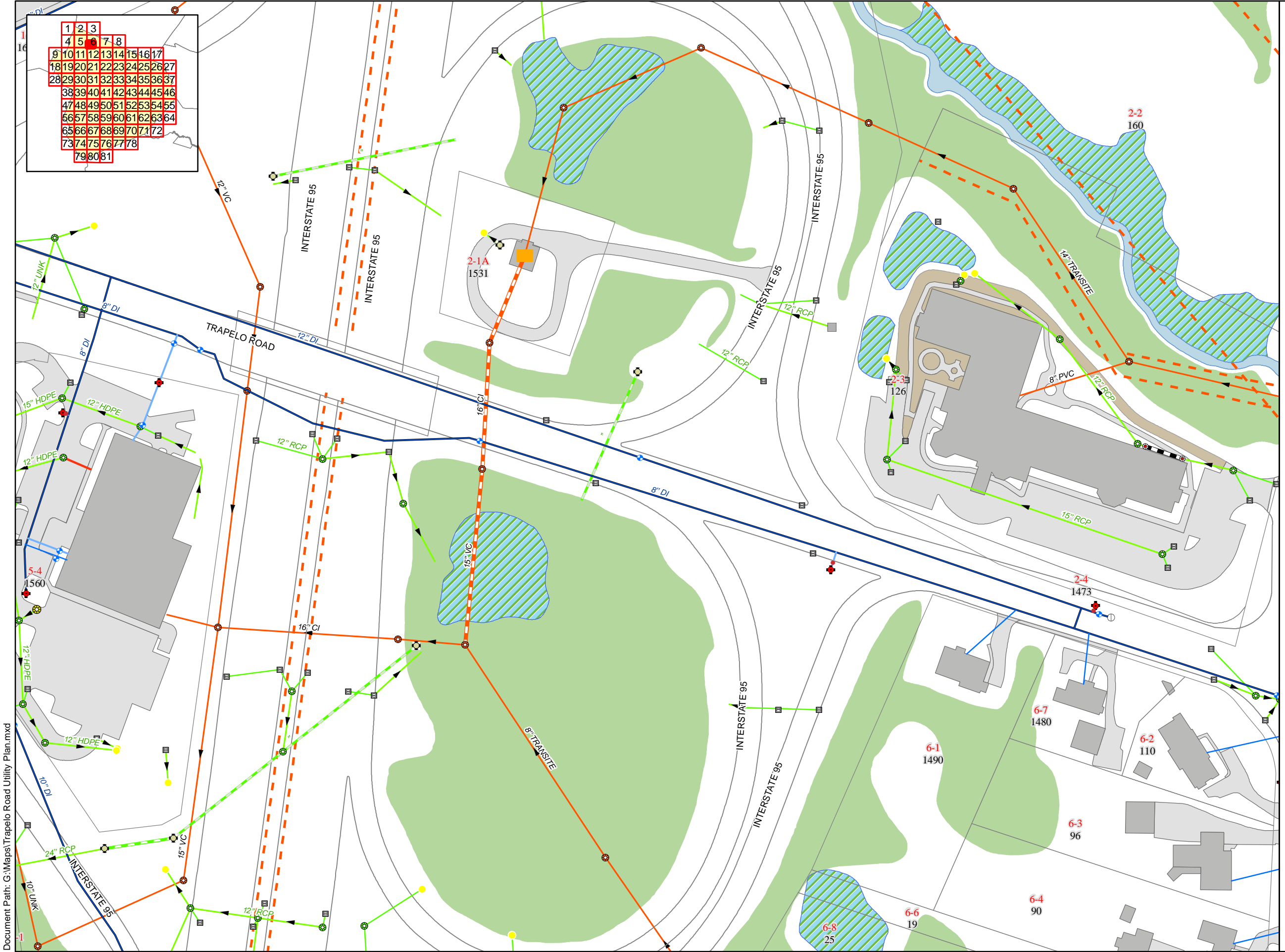



WALTHAM  
SMITH ST/TRAPELO RD  
GENERAL PLAN  
SHEET 1 OF 3

REV.	DATE	DESCRIPTION
△	7/31/08	DRIVEWAY WIDTH
△	8/7/08	ADD SIDEWALK, WALL, FULL DEPTH PVMT. SECTION AND ADJUSTED AS-BUILT SEWER LATERAL LOCATIONS

HIGHWAY GUARD TYPE SS

TRAPELO RD.  
STA. 50+80 LT. TERMINAL SECTION  
STA. 50+80 LT. TO STA. 51+40 LT.  
STA. 51+40 LT. TANGENT END

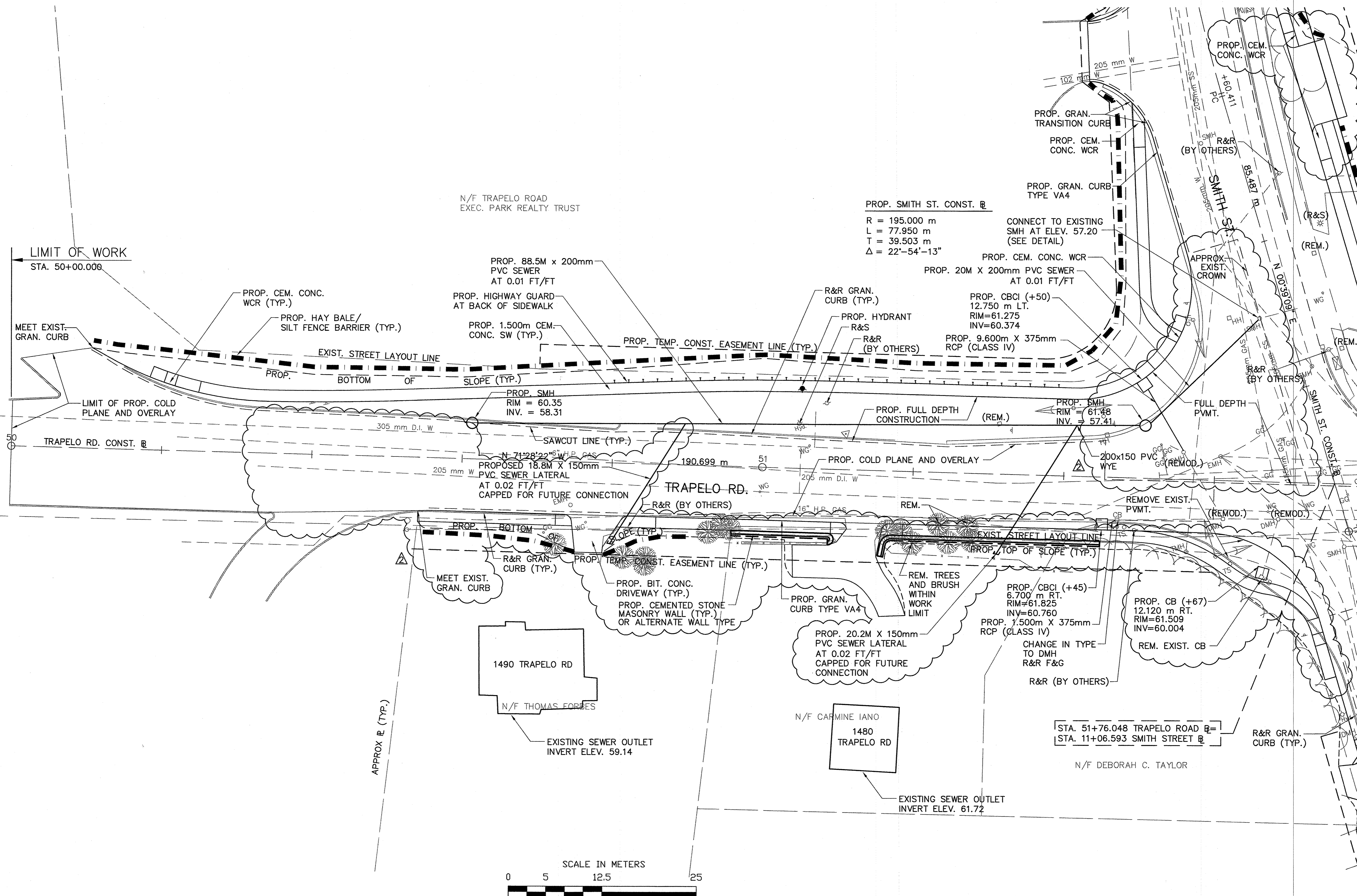
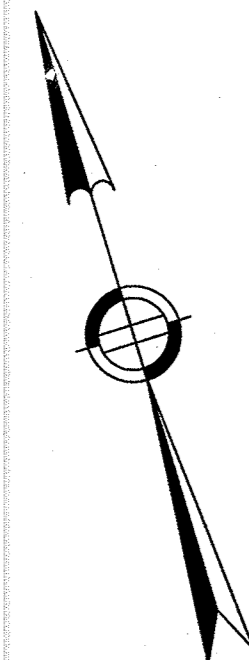

J:\Project\9461\Trans\Construction\Rev\08-07-08\9461TGP.dwg 8/13/2008 9:55:58 AM EDT



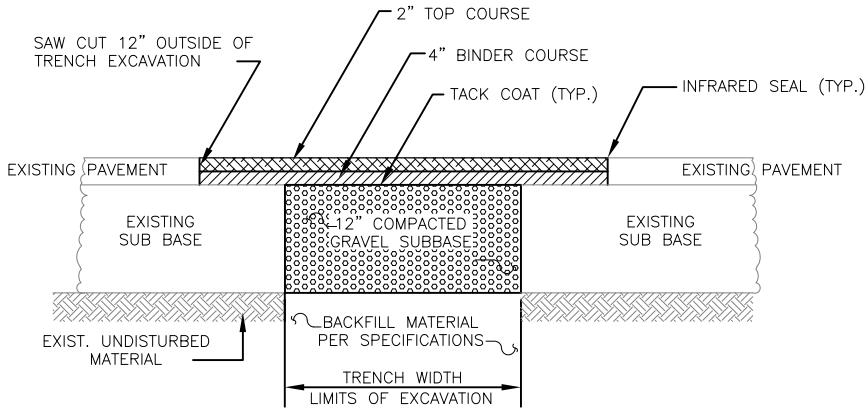

**PERMANENT PAVEMENT DETAIL**

NOT TO SCALE

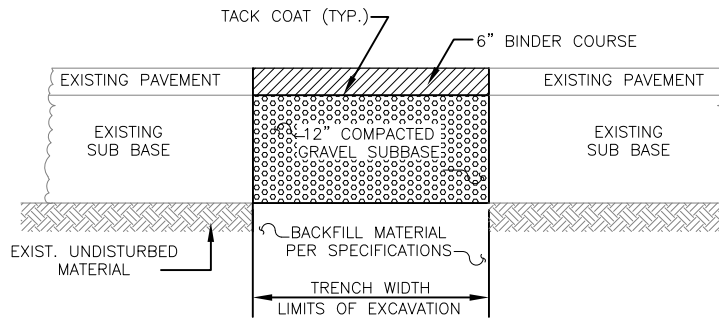

**TRENCH PAVEMENT DETAIL**

NOT TO SCALE

GENERAL PAVING NOTES:

1. THE CONTRACTOR SHALL MAINTAIN TEMPORARY PAVEMENT FOR A MINIMUM OF 90 DAYS EXCEPT IF TEMPORARY PAVEMENT IS PLACED AFTER OCTOBER 1, THEN IT SHALL BE MAINTAINED UNTIL APRIL 15 OF THE FOLLOWING YEAR.
2. PERMANENT PAVEMENT SHALL BE PLACED BETWEEN APRIL 15 AND NOVEMBER 15 OF EACH CALENDAR YEAR.
3. THE CONTRACTOR SHALL SAW CUT 12" OUTSIDE OF TRENCH EXCAVATION. TEMPORARY PAVEMENT SHALL BE REMOVED AND DISPOSED OF. THE GRAVEL SHALL BE FINE GRADED, EMULSION PLACED ON ALL JOINTS, AND PERMANENT PAVEMENT PLACED IN TWO COURSES.
4. CONTRACTOR SHALL MATCH EXISTING ROADWAY GRADES.
5. INFRARED SEAL SHALL BE PLACED AT ANY JOINT BETWEEN EXISTING PAVEMENT AND PULVERIZED OR COLD PLANED AND OVERLAYED PAVEMENT AND AT ALL PERMANENT TRENCH PATCHES.

DWG FILE: \\Powervault\nasshare\Scans\CBs\Details\standard detail 2013.dwg

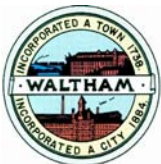

**CITY OF WALTHAM, MA.  
ENGINEERING DEPARTMENT**

**STANDARD DETAILS**

**BIT. CONCRETE PAVEMENT**

**460.000**

Sheet No.  
**460.000**

Scale  
**NTS**

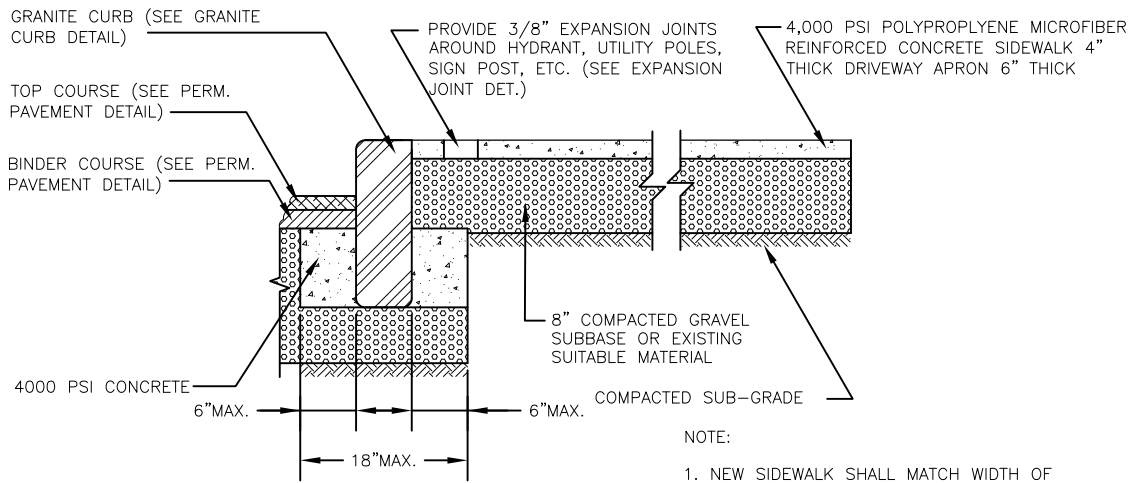

**CONCRETE SIDEWALK DETAIL**  
NOT TO SCALE

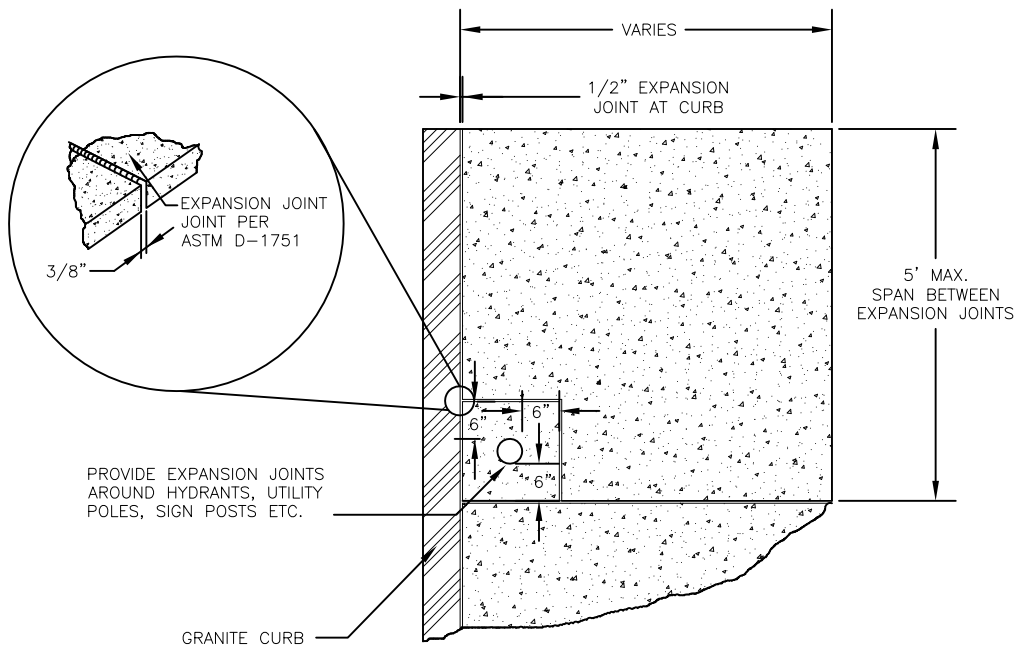

**CONCRETE SIDEWALK EXPANSION JOINT DETAIL**  
NOT TO SCALE

DWG FILE: \\Powervault\nasshare\Scans\CBS\Details\standard detail 2013.dwg

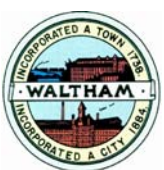

CITY OF WALTHAM, MA.  
ENGINEERING DEPARTMENT

STANDARD DETAILS		Sheet No. 701.000.1
CONCRETE SIDEWALK		Scale NTS
701.000.1		