

**The City of Waltham, Massachusetts**



**Invites,  
in accordance with  
the Massachusetts General Law Chapter 30b,  
Interested Parties  
To propose the best plan**

**For the:**

**Design for a New Traffic Signal  
at the Intersection of  
Beaver Street and Warren Street., 2019**

Your response is due to the Purchasing Office no later than

**10:00 am Thursday October 31, 2019**

**Last day for written Questions: 12.00 Noon October 22, 2019**  
**(to [jpedulla@city.waltham.ma.us](mailto:jpedulla@city.waltham.ma.us))**

**Site Inspection and Briefing: 10:00 am Monday October 21, 2019**  
**(Meet at the Intersection Beaver St. and Warren Street.)**

## **CONTRACT**

### **ARTICLE 1: DEFINITIONS**

**Approval; Approved:** A signed written communication from the Authorized Representative of the City of Waltham to the Designer expressing the City of Waltham's approval of services or documents prepared by the Designer, which approval shall not relieve the Designer from any of its professional responsibilities under this Contract; item with respect to which such written approval has been given.

**Attachment A:** Attachment A, attached hereto and incorporated herein by reference, is the Scope of Services for this project.

**Authorized Representative:** The Authorized Representative(s) of the City of Waltham is (are) the person(s) named in the signature page of this Contract or such other person or persons as the chief executive officer of the City of Waltham may designate in writing.

**City of Waltham:** The City of Waltham named in this Contract.

**Basic Fee:** The Basic Fee is the Designer's fee specified in Article 5 of this Contract.

**Basic Services:** All services required to be performed by the Designer under this Contract except those for which reimbursement is made or provision for additional compensation provided for under Articles 6 and 7.

**Construction Contract:** One or more contracts between the City of Waltham and a general contractor for the construction of the Project.

**Construction Cost:** The cost of constructing the Project inclusive of all demolition, and construction work, all supportive and preparatory construction work required for the Project, all general contractors, subcontractors, suppliers, materials, equipment, general conditions, insurance, overhead and profit and all other allowances. The Construction Cost includes change orders during the construction administration phase of the Project.

**Construction Cost Estimate:** The written estimate of the Construction Cost of the Project prepared by the Designer at various phases of the Project on the basis of the *Uniformat II Elemental Classification for Building Specifications, Cost Estimating and Cost Analysis* dated October 1999 published by the U.S. Department of Commerce NIST to the level of detail specified in this Contract. The following contingencies are included in the Construction Cost Estimate: estimating, phasing and temporary work, and escalation.

**Consultant:** A subcontractor of the Designer.

**Contract:** This Contract for Designer's Services.

**Contract Schedule:** A critical path management or Gantt schedule for the activities of the Designer and its Consultants required by this Contract.

**Estimated Construction Cost:** The Construction Cost as estimated in the Construction Cost. Estimate prepared by the Designer at various phases of the Project to the level of detail and in the format specified in this Contract.

**Fixed Limit Construction Cost:** The maximum Construction Cost established by the City of Waltham as set forth in the Scope of Services.

**Laws:** Applicable statutes, acts, rules, regulations, requirements, orders, directions, ordinances, judgments, decrees, and injunctions of or by the United States of America, the City of Waltham of Massachusetts; and any political subdivisions of either of them; and any agency, department, commission, board, bureau, or instrumentality of any of them.

**Neutral:** An impartial third party not having an interest in with the City of Waltham and any construction contractor on the Project, or the Project.

**Notice to Proceed:** A written communication from the Chief Procurement Officer of the City of Waltham directing the Designer to perform services for the particular phase of the Project as set forth in such communication.

**Permits:** Governmental, quasi-governmental and other necessary permits and approvals, including the filing of notices or information with governmental or quasi-governmental entities and authorities that are necessary for the implementation of the Project at the site. The term "Permits" shall include permits and approvals from utility companies and also include permissions, approvals and consents by private parties necessary for the design and construction of the Project, such as an approval by a landlord or other holder of an interest in the Project site.

**Program:** The program prepared for the Project in accordance with the provisions of M.G.L. c. 29, § 7k or any other pre-design document prepared for the Project in accordance with any other statute, appropriation, authorization or administrative directive consistent therewith.

**Project:** The Project identified in this Contract.

**Qualified Testing Laboratory:** A testing laboratory licensed by the City of Waltham or otherwise qualified to perform specific analyses of samples.

**Record Drawings:** The Drawings prepared by the Designer and its Consultants pursuant to this Contract which incorporate the changes made during the construction period and which incorporate information on the marked-up prints, As-Built Drawings and other data furnished by the general contractor and subcontractors.

**Resident Engineer:** The on-site representative of the City of Waltham for the Project.

## **ARTICLE 2: RESPONSIBILITIES OF THE CITY OF WALTHAM**

**2.1 Approvals.** The City of Waltham shall without unreasonable delay either i) render to the Designer any Approval required by this Contract or ii) notify the Designer in writing why such Approval is being withheld. The City of Waltham shall not unreasonably withhold any Approval, acceptance, or consent required under this Contract.

**2.2 Payment.** For satisfactory performance of all of the Designer's obligations under this Contract, the City of Waltham shall compensate the Designer in accordance with the provisions of Articles 5, 6, 7, 8, and 9 of this Contract.

**2.3 Intentionally Left Blank**

**2.4 Bid Evaluation.**

**60 points of the evaluation are based on the technical aspect of the proposal.**

**40 Points are based on price.**

**2.5 No Waiver.** The City of Waltham's review, Approval, acceptance of, or payment for, any of the services furnished by the Designer shall not be construed as a waiver of any rights under this Contract or of any cause of action arising out of the performance of this Contract. The City of Waltham's Approval shall not in any way relieve the Designer from performing all work required under this Contract in accordance with the standard of care set forth in Section 3.3 herein.

**2.6 Right to Rescind Approval of Consultant.** The City of Waltham may rescind the City of Waltham's prior consent to a Consultant if a Consultant or subcontractor is incompetent, irresponsible or otherwise unsatisfactory, and the Designer shall remove such Consultant or subcontractor from the work. If a Consultant is so removed, the Designer shall provide another Consultant with similar credentials and qualifications (including but not limited to MBE/WBE) that meets with the Approval of the City of Waltham. The removal of such Consultant or sub consultant shall not relieve the Designer from its responsibilities for services of its Consultants and sub consultants under this Contract.

**ARTICLE 3: DESIGNER'S BASIC SERVICES -- GENERAL**

- 3.1 General.** The Designer shall perform professional services in accordance with the terms of this Contract. The Designer shall be responsible for the professional accuracy and coordination of all designs, drawings, specifications, cost estimates, and other services and submittals furnished by Designer and by its Consultants in accordance with the standard of care set forth below in paragraph 3.3. The Basic Fee shall compensate Designer for all of Designer's obligations specified in this Contract except as otherwise specifically provided herein.
- 3.2 Staffing; Time of Essence.** The Designer's personnel who shall provide services under this Contract are those listed in Attachment C. The Designer shall provide sufficient personnel to complete the services required by this Contract in a continuous and timely manner, and shall meet the Approved Contract Schedule agreed upon in accordance with Section 4.1 of this Contract. Time is of the essence of this Contract.
- 3.3 Standard of Care, Compliance with Laws.** The Consultant agrees that the services provided hereunder shall conform to the standard of care and practice exercised by design professionals or consultants engaged in performing comparable services; that the personnel furnishing said services shall be qualified and competent to perform adequately the services assigned to them; and that the recommendations, guidance and performance of such personnel shall reflect such standards of care and practice. In addition to and without limiting the foregoing, the Designer agrees that the work and services performed hereunder shall conform to the standards set forth in this Contract and will endeavor to conform to all applicable Laws.
- 3.4 Quality Assurance.** The Designer shall demonstrate to the Authority the presence and implementation of quality assurance procedures. The Designer shall identify individual(s) responsible for bid document review and cost estimating, as well as methods utilized to determine the completeness, accuracy, and coordination of drawings, specifications, cost estimates, and other data and documentation.
- 3.5 Fixed Limit Construction Cost.** The Designer shall determine the materials, equipment, component systems and types of construction included in the design of the Project so that it may be awarded within the Fixed Limit Construction Cost without alternates (unless Approved by the City of Waltham) and without allowances of any nature. Such determination shall be subject to the Approval of the City of Waltham, which shall not be unreasonably withheld. If within three (3) months after approval of Construction Documents, in final form, the bids of the lowest responsible and eligible bidders exceed the Fixed Limit Construction Cost, the Designer shall, if so instructed in writing by the City of Waltham, provide such revised construction drawings and specifications and Construction Cost Estimates as the City of Waltham shall require for the purpose of bringing the cost within the Fixed Limit Construction Cost; provided that Designer may in connection with such revision make adjustments in the scope of the project subject to the written approval of the City of Waltham, which approval shall not be unreasonably withheld. The Designer shall not be paid additional compensation for such services.
- 3.6 Designer to Evaluate Data.** The Designer shall analyze and evaluate the information furnished by the City of Waltham pursuant to Section 2.3 above. If items or data of the type identified in Section 2.3 are not available or are, in the reasonable opinion of the Designer, insufficient to permit the Designer properly to perform its services hereunder, the Designer shall submit a written request to the City of Waltham for permission to obtain the services of one or more Consultants to perform the necessary
- 3.7**

services, in which case unless the services are included in the Scope of the Contract, the Designer shall be reimbursed in accordance with Article 7 (Reimbursable Costs and Expenses), or to perform the services with the Designer’s own employees, in which case the Designer shall be compensated in accordance with Article 6 (Additional Services; Additional Compensation). In no case shall the Designer commence or authorize a Consultant to commence such services without the prior Approval of the City of Waltham.

**3.7 Corrections by City of Waltham.** The Designer shall furnish appropriate competent professional services for each of the phases of the Project to the point where detail checking or reviewing by the City of Waltham is not necessary. Any changes, corrections, additions, or deletions made by the City of Waltham shall be incorporated into the design of the Project unless specific written objections thereto are made by the Designer and Approved by the City of Waltham. The decision of the City of Waltham shall be final in matters pertaining to this section, but the Designer shall not be responsible for any such decision by the City of Waltham that is inconsistent with generally accepted standards of professional practice provided that the Designer advised the City of Waltham in writing of the inconsistency at the time the decision was made.

**3.8 Employment of Consultants.** Subject to the provisions of this Contract and the Approval of the City of Waltham, whenever the services of the following Consultants are required, the Designer shall employ them and be responsible for their work and the coordination and supervision thereof: structural engineers, electrical engineers, mechanical engineers, civil engineers, plumbing engineers, sanitary engineers, architects, landscape architects, code specialists, cost estimators, specification writers, interior designers, and [insert others, if required]:

---

---

---

---

Consultants shall be registered in Massachusetts in their respective disciplines if registration is required by the applicable Laws. If the City of Waltham directly employs an independent cost estimator, Owner's Project Manager, and/or other consultant(s), the Designer and its Consultants shall work directly with the City of Waltham's consultant(s) to ensure that optimum cost, scheduling, and ease of construction objectives are met.

**3.9 Approval of Consultants.** Except as specifically provided in this Contract, the Designer shall not employ Consultants, or sublet, assign or transfer any part of its services or obligations under this Contract without the prior Approval of the City of Waltham. To obtain such Approval, the Designer must submit the items required by M.G.L. c. 7, §38H. The Designer shall provide the City of Waltham with complete copies of its contracts with each of its Consultants within 14 calendar days of the execution of such contracts.

**3.10 Consultants Barred from Construction Work.** The Designer shall not employ in any element of design, specification, estimating, evaluation or other work under this Contract any person or firm that expects to be a bidder, subcontractor or supplier for the construction of the Project or any part thereof. The Designer shall obtain from every Consultant a written representation that such

Consultant is aware that it is prohibited from serving as a bidder, subcontractor, or supplier for the construction of the Project or any part thereof.

**3.11 Prompt Payments to Consultants.** The Designer shall, within 14 calendar days after receiving payment from the City of Waltham, either make payment to each Consultant whose work was included in the work for which such payment was received or notify the City of Waltham in writing of the reason why such payment is not being made within such time period.

**3.12 Proprietary Items.** Without limitation, the Designer, Designer's employees and Consultants shall adhere to the provisions of M.G.L. c. 30, § 39M, which provides in part:

*"Specifications for such contracts, and specifications for contracts awarded pursuant to the provisions of said sections forty-four A to forty-four L of said chapter one hundred and forty-nine, shall be written to provide for full competition for each item of material to be furnished under the contract; except, however, that said specifications may be otherwise written for sound reasons in the public interest stated in writing in the public records of the City of Waltham or promptly given in writing by the City of Waltham to anyone making a written request therefore, in either instance such writing to be prepared after reasonable investigation. Every such contract shall provide that an item equal to that named or described in the said specifications may be furnished; and an item shall be considered equal to the item so named or described if, in the opinion of the City of Waltham: (1) it is at least equal in quality, durability, appearance, strength and design, (2) it will perform at least equally the function imposed by the general design for the public work being contracted for or the material being purchased, and (3) it conforms substantially, even with deviations, to the detailed requirements for the item in the said specifications. For each item of material, the specifications shall provide for either a minimum of three named brands of material or a description of material which can be met by a minimum of three manufacturers or producers, and for the equal of any one of said name or described materials."*

The City of Waltham becomes the sole proprietor of all design and bid documents including specifications, drawings, plans, submittals and all other information for which the Designer has been paid to produce.

The Designer shall refer to the law and consult with the City of Waltham for procedures regarding proprietary items. The City of Waltham may waive the provisions of this law for "*sound reasons in the public interest.*" No such waiver shall bind the City of Waltham unless made in writing and executed by the City of Waltham.

**3.13 ADA, Handicap Access and Nondiscrimination Laws.** Consistent with the standard of care and practice stipulated in Section 3.3 above, the Designer shall perform its services under this Agreement in strict compliance with all Laws relating to architectural accessibility, including without limitation, the applicable sections of the Americans with Disabilities Act of 1990 ("ADA", 42 U.S.C. sections 12101 *et. seq.*), the ADA Accessibility Guidelines for Buildings and Facilities ("ADAAG"), and the regulations of the Massachusetts Architectural Access Board ("MAAB", 521 CMR 1.1 *et. seq.*). The Designer recognizes that the City of Waltham is a Public Entity subject to Title II of the Americans with Disabilities Act, may be recipients of federal funds under the Rehabilitation Act of 1973, and are subject to the MAAB regulations referenced above. The Designer hereby assumes the Public Entities' obligations, including those that exist under the MAAB, ADAAG and/or the Rehabilitation Act of 1973 to design a facility accessible to and usable by people with disabilities. The Designer shall provide the City of Waltham with designs that provide access to all programs, activities and services to be conducted within the facilities to be designed in accordance with the scope of work of the Contract

and to document compliance with the above referenced standards, as well as any variance or waivers of the above requirement the Designer may have obtained on behalf of the public entities. The Designer shall not seek any such variance or waiver of the above requirements without the express, written authorization of the City of Waltham. The Designer shall exercise due care and diligence in accordance with the standard of care set forth in paragraph 3.3 above, in performing the work required under this Contract to protect, indemnify and defend the City of Waltham from claims for failure to comply with the laws, rules and regulations pertaining to architectural accessibility for people with disabilities.

- 3.14 Permits Generally.** Unless otherwise instructed by the City of Waltham in writing, the Designer shall obtain all Permits required to implement Designer's design at the site other than standard building permits customarily obtained by the general contractor. The Designer shall obtain the prior Approval of the City of Waltham of all permit applications, notices, and accompanying documentation before filing them with the appropriate governmental entity or other party. The Designer shall provide the City of Waltham with a certified list of all Permits required to implement the design at the site as soon as possible during design development, shall schedule target dates for the procurement of such Permits, and shall regularly update such list and schedule during the term of this Contract. The Designer shall certify in writing at the time that construction documents (or changes thereto) are submitted to the City of Waltham that the Designer has identified all Permits required to implement the Project and that those not identified in writing as being the responsibility of the City of Waltham have been identified in the specifications as being the general contractor's responsibility. Notwithstanding the foregoing, any required attendance by the Designer at any public hearing in connection with any Permit shall be considered an Additional Service to be compensated in accordance with Article 6 of this Contract, and any Permit application fee shall be considered a Reimbursable Expense to be reimbursed in accordance with the provisions of Article 7.
- 3.15 Permits Related to Change Orders.** The Designer shall also provide to the Awarding Authority a written certification of all Permits required to implement change order work at the site when the Designer submits for approval any change order request to the City of Waltham during the construction phase of the Project, whether the change order request was made by the Designer, the City of Waltham, or the general contractor.
- 3.16 Special Consultants.** The Designer shall retain the services of a Qualified Testing Laboratory, special field inspectors, and other special Consultants not referenced in Section 3.8 above when required for the Designer's services for the Project. The identity of such Consultants shall be approved in advance by the City of Waltham, which Approval shall not be withheld unreasonably. When such a special Consultant's services are required, including the services of a Qualified Testing Laboratory functioning under the jurisdiction of both a Massachusetts registered engineer and licensed inspectors, a detailed description of the proposed services shall be prepared by the Designer and shall be subject to the Approval of the City of Waltham. Consultant fee proposals shall be obtained by the Designer from at least three such consultants and submitted to the City of Waltham together with the Designer's recommendation for selection before any work shall be approved. The City of Waltham may waive the requirement for three proposals for good cause. Each such Consultant whose fee for such services exceeds \$25,000 shall demonstrate coverage by liability insurance in an amount not less than its fee. The cost for services of any Approved special Consultant not listed in Section 3.8, in the Scope of Services or in the Designer Selection Board advertisement for the Project shall be reimbursed as provided in Article 7. For solicitation, inspection, analysis, coordination, and evaluation of such

Consultants' services, and for assuming liability therefore, the Designer shall be compensated as provided in Article 7.

- 3.17 Copyrights, Patents, Intellectual Property Rights.** The Designer hereby grants to the City of Waltham an irrevocable royalty-free license to use for any purpose the following items developed or made part of the work or services performed under this Contract: all drawings, designs, specifications, photographs, images, notes, materials and other work and ideas of the Designer and its Consultants and subcontractors related to the performance of this Contract which are or may be covered by copyright, patent, or other intellectual property Laws or as to which Designer and its Consultants and subcontractors may assert any rights or establish any claim under any such Laws. The Designer agrees on behalf of itself and its Consultants and subcontractors that the City of Waltham shall have unlimited royalty-free rights, for the benefit of the City of Waltham and any public entity to which the City of Waltham may grant the right to share such rights, in any and all drawings, designs, specifications, photographs, images, notes, materials and other work and ideas developed in the performance of this Contract, including the right to use the same on any City of Waltham projects. The Designer shall incorporate by reference this provision into all contracts with its Consultants and subcontractors on this Project including, but not limited to, architects, engineers, estimators, designers and photographers. The Designer and its Consultants and subcontractors shall not be responsible for changes made in the documents without the Designer's authorization, nor for the City of Waltham's use of the documents on projects other than the Project, unless this is a contract for design services for a master plan or prototype. The City of Waltham assumes the risk resulting from any such changes made in the documents without the Designer's authorization, or for the City of Waltham's use of the documents on projects other than the Project.
- 3.18 Security and Confidentiality.** The Designer and its Consultants and subcontractors shall maintain the confidentiality of Project records, including, but not limited to, all prints, plans, policies, procedures, studies, specifications and drawings, which relate to internal layout and structural elements, electrical and mechanical systems, security measures, emergency preparedness, threat or vulnerability assessments, and any other records relating to the security or safety of persons or buildings, structures, facilities, utilities, transportation or other infrastructure located within the City of Waltham, the disclosure of which, in the reasonable judgment of the City of Waltham, is likely to jeopardize the safety of persons or property. Without limiting the foregoing, if the Project is a designated "Security Sensitive Information" project, the Designer shall execute a separate Security Sensitive Information Procedures and Confidentiality Agreement and shall comply with such document protection requirements as may be referenced in said agreement.
- 3.19 Test Bores.** The Designer is required to perform as many soil investigations as necessary to determine the suitability of building the required platform/base upon which the poles, masts or footings will be installed.
- 3.20 Surveys and Data.** The Designer shall provide surveys of the Project's building site or sites, showing the grades and lines of streets, pavements and adjoining properties; the rights, restrictions, easements, boundaries and contours of the site or sites; reports from any borings, test pits; chemical, mechanical or other tests; photographs and information as to water, sewer, electricity, steam, gas, telephone and other services; and data and drawings regarding existing buildings.



**ARTICLE 4: PROSECUTION AND PROGRESS OF BASIC SERVICES**

The Designer shall perform the following specific tasks in the following phases:

**4.1 Design Phase Services.**

- i. Upon receipt of a Design from the City of Waltham, the Designer and its appropriate Consultants shall meet with agents of the City of Waltham to arrive at a mutual understanding of the requirements of the Study or Program furnished by the City of Waltham.
- ii. The Designer shall submit a proposed design work plan for the Designer's Services pursuant to this Contract including anticipated tasks and submittals. The Designer shall submit a proposed Contract Schedule consistent with any project schedule included in the Study or Scope of Services referenced in Attachment A. The schedule shall contain dates for submittals, deliverables, actions, milestones, design workshops, meetings and the critical path through all design service activities. It shall include allowances of time for the City of Waltham's review and approval of submittals and for necessary submissions for Permits in connection with the Project. When Approved by the City of Waltham the work plan and the Contract Schedule shall govern the Designer's duties hereunder. The work plan shall also include a work plan schedule of values consistent with the payment schedule for the Basic Fee specified in Section 8.2, which shall be the basis of which payments of the Basic Fee within each phase shall be made. The work plan schedule of values shall identify deliverables within each phase and percentages of the phase fee payable upon completion of such deliverable. When Approved by the City of Waltham the work plan schedule of values shall govern the timing of payments of the Basic Fee upon completion of deliverables within each phase and as each phase progresses.
- iii. The design phase drawings, specifications, Construction Cost Estimates and other submittals shall be subject to the written Approval of the City of Waltham. Unless a lesser number is requested by the City of Waltham, the Designer shall submit to the City of Waltham for approval six (6) copies of design drawings, specifications, cost estimates, and other submittals.

**4.2 Design Development Phase Services.**

- i. Upon receipt of a Notice to Proceed with the Design Development Phase, the Designer and its Consultants shall meet regularly and as necessary with agents of the City of Waltham and shall update and refine items submitted during the design phase, and shall submit, on or before the date specified in the Contract Schedule, and on the basis of the Approved design phase documents:
  - (a) an updated work plan and Project Schedule;
  - (b) a list of all Permits required to implement the design and a schedule of target dates for the procurement of such Permits, which list and schedule shall be regularly updated during the term of this Contract;
  - (c) information and documentation within the technical expertise of the Designer and its Consultants that is necessary for the City of Waltham to file Environmental Notification Forms, Environmental Impact Reports, and any other filings for Permits that must be filed during the design development phase;
  - (d) complete design development drawings, draft specifications indicating any filed sub-bid sections based on the cost of the work and other documents necessary to specify the size and character of the Project and other features;
  - (e) quality control documentation demonstrating without limitation coordination of: ceiling clearances, mechanical room size, and shaft sizes; specifications and drawings;

filed sub-bid work or sections; scheduling; equipment and power; existing and new construction; and phasing;

(f) a Construction Cost Estimate for the design with respect to the Project;

- ii. Such drawings, specifications, cost estimate and other design development submittals shall be subject to the written Approval of the City of Waltham. Unless a lesser number is requested by the City of Waltham, the Designer shall submit to the City of Waltham for approval four (4) copies of design development drawings, specifications, cost estimates, and other submittals.

- iii. **Final Design Completion**

Shall be achieved within **180 days from the date of the Notice-to-Proceed.**

#### **4.21 Ownership of Designer produced documents.**

Upon payment of the designer's fee as specified in Articles 5 and 8, the City becomes the owner of all sketches, prints, drawings, submittals, etc produced as a result of this project.

#### **4.3 Construction Documents Phase Services.**

- i. Upon receipt of a Notice to Proceed with the Construction Documents Phase of the Project from the City of Waltham, the Designer shall meet regularly as necessary with agents of the City of Waltham and based on the submittals Approved in the design development phase of the Project, shall update and refine the items previously submitted and shall submit on or before the date and time specified in the Approved Project Schedule:
  - (a) Shop Drawings
  - (b) Final signal Inspection
- ii. The Designer shall furnish a revised and final Construction Cost Estimate, current as of the date of the final bid document submission, including cost estimates for general conditions, overhead and profit, insurance, bonds, and all other items; provisional allowances for work not sufficiently designed at this phase; and allowances expressed as percentage rates for construction contingencies and escalation to the bid date.
- iii. The Designer shall furnish a final Construction Cost Estimate, current to the date of the final bid document submission. This estimate shall contain overhead and profit and for any further allowances for escalation and other contingencies.
- iv. The Designer shall also submit a summary comparing the final construction drawings and specifications and final Estimated Construction Cost with the Program requirements and submittals made during the design development phase, explaining any significant deviations.
- v. All submittals shall be subject to the written approval of the City of Waltham. Unless a lesser number is requested by the City of Waltham or is provided below in subsection vii, the Designer shall furnish to the City of Waltham for approval six (6) sets of the drawings, specifications Construction Cost Estimates and other submittals. The Designer shall also furnish electronic media copies of the foregoing drawings and documents in such form as is required by the City of Waltham.
- vi. From the Approved construction drawings and specifications, with such changes as the City of Waltham requires, the Designer shall prepare and transmit to the City of Waltham a set of reproducible black and white drawings and original specifications on high quality white bond paper, single-sided, properly packaged, suitable for reproduction, stamped and signed by all disciplines, which documents shall become the property of the City of Waltham. Other suitable methods may be used with the prior Approval of the City of Waltham. One copy of the drawings and specifications shall be submitted with the reproducible drawings and specifications.

- 
- vii. The City of Waltham will copy the construction bid documents, including advertisements, for receipt of proposals from construction contractors, and for execution of a Construction Contract or contracts. The Designer shall assist the Purchasing department with the preparation of all addenda (to include bidders' questions and Designer's responses), subject to the Approval of the City of Waltham. The Designer shall attend the pre-bid conference if one is scheduled, taking note of all questions asked. Relevant questions submitted in writing shall be answered by means of written addenda to the bid documents as required. The Designer shall attend the bid opening and conduct a review of the qualifications of the low filed sub-bidders and general bidder (and of other bidders if necessary) and shall, within five working days of the respective bid opening dates, advise the City of Waltham in writing of the Designer's opinions as to the which general bidder is the responsible and eligible bidder that has submitted the lowest bid
  - ix. If within three (3) months after approval of Construction Documents, in final form, the bids of the lowest responsible and eligible bidders exceed the Fixed Limit Construction Cost, the Designer shall, if so instructed in writing by the City of Waltham, provide such revised construction drawings and specifications and construction cost estimates as the City of Waltham shall require for the purpose of bringing the cost within the Fixed Limit Construction Cost; provided the Designer may in connection with such revision make reasonable

adjustments in the scope of the project subject to the written approval of the Director, which approval shall not be unreasonably withheld. The Designer shall not be paid additional compensation for such services.

#### **4.4 Construction Administration Phase Services.**

- i. Consistent with the standard of care and practice stipulated in Section 3.3 above, upon the award of the Construction Contract the Designer and its Consultants shall, for the purposes of ensuring construction quality, cost control, schedule control, compliance with the City of

Waltham's obligations under the Construction Contract, and protecting the City of Waltham against defects and deficiencies in the work of the Project under the Construction Contract documents:

- (a) be charged with general administration of the Construction Contract to the extent set forth herein;
- (b) furnish the general contractor with engineering information and such large-scale drawings and full-sized detailed drawings as are needed to implement the intent of the Construction Contract documents;
- (c) promptly and in accordance with the requirements of the Construction Contract check, obtain testing where necessary, and approve samples, schedules, shop drawings and other submissions by the general contractor;
- (d) prepare, maintain and update logs for all submittals and changes to the Construction Contract;
- (e) visit the site at intervals appropriate to the stage of construction but not less than weekly, and observe the progress of the work, issue written progress reports, and conduct job meetings, and prepare and distribute meeting minutes to assure that the work is technically correct and is being built in conformance with Approved construction documents;

- 
- (f) report to the City of Waltham weekly in writing on the progress of the work including whether or not the general contractor is keeping as-built drawings updated;
  - (g) on a weekly basis (or more often as may be necessarily), make specific recommendations on rejection of all Project work observed by the Designer that fails to conform to the Construction Contract documents, and review and inspect corrected work;
  - (h) require each Consultant employed in accordance with Article 3 to make visits weekly during the progress of any work to which that Consultant's services relate and to report upon it in writing to the Designer;
  - (i) conduct semi-final and final inspections of the Project and report the results of such inspections in writing to the City of Waltham;
  - (j) observe the balancing of air and water circulation systems and report the results thereof;
  - (k) observe the setting and adjustment of automatic controls and report thereon; (l) in a timely manner, decide all questions regarding interpretation of, or compliance with, the Construction Contract documents, except as the City of Waltham may in writing otherwise determine;
  - (m) furnish electronic versions of the Record Drawings, a final cost report, and other required documents; and
  - (n) assist the City of Waltham in any bid protest hearings, change order appeal hearings requested under M.G.L. c. 30, § 39Q, and any other litigation, except as provided in Article 6.
  - (o) Except as otherwise specifically set forth in the Construction Contract documents, the Designer shall neither have control over or charge of, nor be responsible for, the construction means, methods, techniques, sequences or procedures, or for safety precautions and programs in connection with the Work, since these are solely the Contractor's rights and responsibilities under the Construction Contract documents
- ii. The Designer shall submit to the City of Waltham in a timely manner all requisitions for payment submitted by the general contractor in the form required by the City of Waltham. With respect to each such requisition, the Designer shall certify to the best of its knowledge that the percentage of work included in the requisition is accurate and that the work performed conforms to the Construction Contract documents. In the event the Designer does not approve the requisition exactly as submitted by the general contractor, the Designer shall forward it for payment to the City of Waltham dated and signed with corrections with an accompanying letter of explanation setting forth the Designer's objections and recommended changes. The Designer shall coordinate the required visits to the construction site so as to enable it to submit to the City of Waltham the general contractor's monthly requisition for payment bearing the Resident Engineer's approval or accompanied by the Resident Engineer's letter of exceptions. Timely payments to the contractor are required by M.G.L. c. 30, § 39K; therefore, the Designer shall establish procedures assuring either immediate mail or messenger delivery of the requisition for payment to the City of Waltham, and shall process requisitions for payment within two working days after receipt of the same.
- iii. Before examining the requisition for final payment submitted to the City of Waltham by the general contractor and making any certification in response thereto, the Designer shall obtain from the general contractor As-Built Drawings, including drawings showing the actual installation of the site utilities, plumbing, heating, ventilating and electrical work under the

Construction Contract, and recording all changes. The Designer shall ascertain that changes authorized by change orders are shown on the general contractor's As-Built Drawings. The Designer shall revise the applicable original reproducible drawings and electronic media drawings on the basis of the As Built Drawings and shall submit them as Record Drawings along with two sets of prints to the City of Waltham; which Record Drawings shall become the property of the City of Waltham, all as part of its Basic Fee.

- iv. At the conclusion of the Construction Contract the Designer shall assist the City of Waltham's Authorized Representative in the evaluation of the performance of the general contractor as required by law.
- v. Two suitably bound legible copies of all original design and quantity calculations including those pertinent to change orders and shop drawings if applicable shall be furnished by the Designer to the City of Waltham at the conclusion of the Construction Contract.

#### **4.5 COMPARATIVE EVALUATION CRITERIA**

The City reserves the right to award the contract to the responsive and responsible qualification submittal which best meets the City's needs, taking into account firm qualifications, submittal quality, evaluation criteria and price. The awarding authority's decision or judgment on these matters shall be

final; the committee will use the comparative criterion for each separate rating area, and based upon these criteria, will assign an overall rating to each proposal. Each of the criteria may contain ratings of:

- Unacceptable
- Not Advantageous
- Acceptable
- Advantageous
- Highly Advantageous

#### **The technical section of the RFP is worth 60%**

**An "Unacceptable" rating in any one of the criteria will eliminate the proposal from further consideration.**

Firms must meet the minimum requirements as specified in Section III A. Failure to meet the minimum evaluation criteria will result in immediate rejection of the qualification submittal and will not be subject to further review.

The following criteria will be used in the evaluation of the architectural firm regarding the Technical or Non-Price Proposal in order to be placed on the short list for an interview with the Selection Committee.

**Responding Firms are to address each of the following criteria in a clearly labeled section of their response and in the same order.**

- 1) The Firm Background, Relevant Experience and Capability** to perform all of the aspects of the project, such as programming, building permitting, cost estimating and value engineering and flood mitigation design. Recent with projects comparable to the proposed project. Firm to describe relevant design in this type of project. **(15 Points)**
  - a. Unacceptable:** Less than three (3) years of experience in providing Design services with documented examples of such services. Firm has no permitting or design background in providing this type of facility project. No projects of similar type have been successfully

completed

- b. **Acceptable:** Three (3) to five (5) years of experience in providing Design services with documented examples of such services.
  - c. **Advantageous:** More than five (5) years of experience in providing Design services with documented examples of such services. Firm has prior experience in permitting and design in providing this type of facility project that is current (within the past 5 years). One (1) to Three (3) projects of similar type have been successfully completed.
  - d. **Highly Advantageous:** More than seven (7) years of experience in providing Design services in with documented examples of such services.
  - e. **Highly Advantageous:** Firm has prior experience with permitting and design background in this type of facility project within that is current (within past 5 years). Additional similar work is underway currently within the firm. Three (3) or more projects of similar type have been successfully completed.
- 2) **Current Firm Capacity and References (10 Points).** List significant current work and work completed in the last five (5) years, as well as projects in-house but not yet begun; quantify. Provide references with contact names and valid phone numbers of other clients whereby similar work has been performed.
- a. **Unacceptable:** No or limited current work listed. References are not provided.
  - b. **Not Advantageous:** Firm capacity may be challenged by current work load when taking on this new assignment. References provided are not related to similar project type
  - c. **Advantageous:** Firm capacity appears to be able to handle this assignment with the given work load. More than three (3) references are provided from similar project types
  - d. **Highly Advantageous:** Firm capacity can easily handle this assignment with their given work load. Five or more references are provided for similar project types.
- 3) **Project Discussion & Scope of Work, Project Understanding & Challenges, Project Approach (15 Points)**
- a. **Unacceptable** - Proposal did not adequately convey the Proposers understanding of the project and the firm's approach to completing the project successfully.
  - b. **Not Advantageous** - The response indicates the proposer may understand the Owner's needs, but the plan provided is not clear enough to make a determination. The Proposers approach does not instill confidence in a plan to complete the project in a well thought out manner.
  - c. **Advantageous** - The Scope of Services response provided indicates the proposer will meet the needs of the Owner; and shows the Proposers demonstrated understanding of the project and their approach to the work required to complete a successful project.
  - d. **Highly Advantageous** - The Scope of Services response provided clearly indicates the understanding and ability to successfully meet the needs of the Owner; shows the Proposers demonstrated understanding of the project; their ability to bring leadership to the project and that their approach to the project demonstrates a creative and thorough process
- 4) **Resume of Designers Involved (10 Points)**
- a. **Unacceptable:** No proposed designers.
  - b. **Not Advantageous:** The proposed designers do not instill confidence by the Owner in the firm to be able to complete the project in a well thought out manner.
  - c. **Acceptable:** The proposed designers are less than two and indicate a reduced understanding of the project, its scope and its timeframes for completing the work adequately.
  - d. **Advantageous:** The proposed designers provided are more than two and indicate a good

understanding of the project and the work required.

- e. **Highly Advantageous:** The proposed designers are more than three, including a senior member of the Designer's firm, which indicates a proficient understanding of the project and the work required.

**5) Municipal Experience (10 points)**

- a. **Unacceptable:** No municipal experience provided.
- b. **Not Advantageous:** One to two previous projects completed of similar work.
- c. **Acceptable:** One to three previous projects completed with municipal or government agencies.
- d. **Advantageous:** Two to three previous projects completed with municipal or government agencies.
- e. **Highly Advantageous:** More than three previous projects completed with municipal or government agencies.

**6) Price (40 points)**

**IV RULE FOR AWARD**

The contract shall be awarded to the responsive and responsible proposer submitting the most advantageous proposal, taking into consideration the proposals relative merits and price. **The technical section of the RFP is worth 60% of the award, the Price is worth 40%.**

**ARTICLE 5: DESIGNER'S BASIC FEE**

- 5.1 **Basic Fee.** For the performance of all services required in this contract and excluding those services specified under Articles 6 and 7, the Designer shall be paid a negotiated lump sum Fee.
- 5.2 **Equitable Adjustments to Basic Fee.** If there is a substantial change in the services provided in this Contract as determined by the City of Waltham, the Designer and the City of Waltham will agree to an equitable adjustment in the Designer's Basic Fee. For the purposes of this Contract, a "substantial change" in services shall include:
  - i. a substantial change in the scope of Designer's services that is not the fault of the Designer.
- 5.3 **Manner of Payment.** Payment of the Designer's Basic Fee shall be made in accordance with Article 8.

**ARTICLE 6: OTHER SERVICES**

- 6.1 **Other Services.** With the prior Approval of the City of Waltham, the Designer shall perform all or any of the following services in addition to the Basic Services and shall be included in the base fee:
  - I. attend permit or public hearings and preparing presentation renderings and presentation models in connection therewith that are authorized by the City of Waltham;
  - II. prepare documents for alternate bids requested by the City of Waltham except or alternates required to be prepared by the Designer to adjust the Estimated Construction Cost to within the Fixed Limit Construction Cost;
  - III. provide consultation concerning replacement of any work damaged by accidents or other cause during construction and furnishing professional services of the type set forth in Article 3 as may be required in connection with the replacement of such work;

- 
- IV. provide professional services necessary to evaluate substitutions proposed by the general contractor and preparing subsequent revisions to drawings and other documents resulting there from or furnishing professional services made necessary by the default of the general contractor;
  - V. provide services after final payment to the general contractor, except for services occasioned by the Designer's errors or omissions;
  - VI. prepare special documents for or appearing as a witness in change order appeal hearings in judicial litigation arising out of the Construction Contract, except for litigation arising from the Designer's negligent acts or omissions;
  - VII. prepare change orders and supporting data, except as set forth in Section 6.4;
  - VIII. revise construction drawings and specifications submitted in their final and complete form for which bids were not received within six months after submission;
  - IX. make studies other than those normally required and preparing applications and reports to assist the City of Waltham.

**6.2 Additional Site Visits.** Additional services shall also include additional site visits by the Designer or its Consultants at the request of the City of Waltham during the construction administration phase at no additional cost to the City.

**6.3 Compensation for Other Services.** The services provided pursuant to sections 6.1 and 6.2 of this Article are part of the basic services rendered by the Designer and no additional compensation will be made. The cost of other services, if any, shall be incorporated in the basic fee.

**6.4 Change Orders and Modifications.** The Designer shall be compensated in accordance with the rates negotiated PRIOR to the change order or modifications. Neither the Designer nor its consultants shall be compensated for any services involved in preparing changes that are required for additional work that should have been anticipated by the Designer in the preparation of the bid documents, or that were occasioned by the Designer's errors or omissions, as reasonably determined by the executive head of the City of Waltham. The Designer shall not be compensated for any services involved in preparing changes required to make unit price adjustments due to existing conditions, nor for services involved in change orders for time extensions only. Changes for which the Designer receives no compensation under this Article shall be called "no fee modifications" or "no fee change orders." The fact that the Designer receives no fee shall not waive the City of Waltham's legal remedies regarding such changes.

## **ARTICLE 7: REIMBURSABLE COSTS AND EXPENSES**

**7.1 General.** The Designer shall be reimbursed by the City of Waltham for:

- i. The actual cost to the Designer of special consultants Approved by the City of Waltham but not specified in Article 3 or in the Designer Selection Board's advertisement for the Project. No reimbursement for such expense shall be made unless the rates of compensation for said consultant services shall have been previously approved by the City of Waltham. The City of Waltham will negotiate a lump sum fee.
- ii. Permit filing fees and other actual costs for items not included in the Basic Fee, including special printing, but only when specifically authorized in writing in advance by the City of Waltham. All fees are waived for any city required permits.
- iii. For document copies in excess of 5 copies.

The City of Waltham shall not reimburse the Designer for any telephone or other out-of-pocket expenses unless specifically authorized in advance as provided above.

**7.2 Travel.** The City of Waltham shall not reimburse the Designer for travel expenses under this Contract, provided, however, that in special circumstances and with prior written Approval of the City of



Waltham, the Designer may be reimbursed for out-of-state travel expenses consistent with applicable statutes, rules, and regulations.

#### **ARTICLE 8: PAYMENTS TO THE DESIGNER**

**8.1 Change Orders.** Unless otherwise approved by the City of Waltham, payments to the Designer for a modification or a change order shall be made when the modification or change order has been approved by the City of Waltham and the Designer's services with respect to the same, other than construction administration services, have been completed.

**8.2 Schedule for Payment of Basic Fee.** The lump sum fee under Article 5 above shall be paid in accordance with the Approved work plan schedule of values prepared in accordance with Section 4.1, for performance of all services specified in Articles 3 and 4.

Actual payments can be requisitioned by the Designer upon completion of deliverables within each phase as set for in the Approved work plan schedule of values:

- ii. Twenty-five percent (25%) for the design development phase services;
- iii. Twenty-five percent (25%) for the bid documents;
- iv. Fifty percent (50%) for the construction administration.

The Designer shall submit requisitions on a monthly basis for any deliverables completed within that month. City of Waltham shall not be obliged to pay any claims received more than forty-five days after notification to the Designer of final acceptance of the contractor's work under the Construction Contract.

**8.3 Applications for Payment.** All invoices except for those made under the provisions of Section 8.1 above may be submitted monthly and will be promptly processed by the City of Waltham if they are in conformity with this Contract and properly documented; if not they will be returned to the Designer. No invoice (other than an invoice for the final payment to Designer under this Contract) shall be required to be so submitted or processed when the net amount due is less than \$200. Amounts of less than \$200 shall be added to the subsequent month's invoice. All invoices from the Designer shall be submitted to the City of Waltham accompanied by a completed City of Waltham of Massachusetts Payment Voucher Input Form PV if this is a City of Waltham project, otherwise accompanied by such forms as the City of Waltham may require.

**8.4 Right of Offset.** If the City of Waltham finds that services previously paid for by the City of Waltham contained deficiencies, errors or omissions then the City of Waltham may withhold from any future payment an amount reasonably calculated by the City of Waltham to cover the cost of correcting the deficiency, error or omission until the services have been corrected. The City of Waltham may also offset against any payment due to the Designer the amount of any costs incurred by the City of Waltham arising from the Designer's failure to provide required services, deficiencies, errors or omissions. If the City of Waltham shall discover that the charge for any previously paid-for services was calculated based upon incorrect salary rates or other incorrect information, the City of Waltham may offset any overcharges against any future payment. Any disputes related to offsets taken by the City of Waltham shall be subject to resolution pursuant to Section 3.19 of this Contract. Nothing in this paragraph shall limit any legal remedies of the City of Waltham against the Designer for default, errors, omissions, erroneous claims, false claims, tort claims, or any breach by the Designer of the terms of this Contract or applicable Laws.

---

**ARTICLE 9: TERMINATION**

- 9.1 City of Waltham's Right to Terminate.** By written notice to the Designer, the City of Waltham may terminate this Contract, in whole or in part, at any time for either the City of Waltham's convenience or for the failure of the Designer to fulfill its obligations under this Contract.
- 9.2 Termination by City of Waltham for Convenience.** If any such termination shall occur without the fault of the Designer, all compensation and reimbursable expenses due to the Designer up to the date of termination, in accordance with all Contract terms, including proportionate payment for partially completed work, shall be paid to the Designer by the City of Waltham. The payments to the Designer shall not exceed the fair value of the Designer's work, as the City of Waltham shall determine. No amount shall be allowed for anticipated profit on unperformed services.
- 9.3 Termination by City of Waltham for Cause.** If this Contract is terminated due to the failure of the Designer to fulfill the Designer's obligations under this Contract, the City of Waltham may assume the design work and replace it and/or prosecute the same to completion by contract or otherwise. In such case, the Designer shall be liable to the City of Waltham for any additional cost incurred by the City of Waltham thereby. These rights and remedies of the City of Waltham are in addition to any rights and remedies provided by law or under this Contract.
- 9.4 Termination by Designer.** By written notice to the City of Waltham, the Designer may terminate this Contract (i) if the City of Waltham, within sixty (60) days following written notice to the City of Waltham from the Designer of any default by the City of Waltham hereunder, shall have failed to remove such default, or (ii) if, after the Designer shall have performed all services required of the Designer in the schematic design phase, the design development phase, or the construction documents phase of the Project as described in this Contract, at least six months shall have elapsed without receipt by the Designer of a Notice to Proceed with the next phase of the Designer's services. Upon any such termination by the Designer all compensation and reimbursement payable to the Designer in accordance with this Contract up to and including the date of termination shall be paid to the Designer by the City of Waltham. The payments to the Designer shall not exceed the fair value of the Designer's work, as the City of Waltham shall determine. No amount shall be allowed for anticipated profit on unperformed services.
- 9.5 Designer's Duties upon Termination.** Upon any termination of this Contract the Designer shall deliver to the City of Waltham all data, drawings, specifications, reports, estimates, summaries, and such other information and materials, whether completed or in process, as may have been accumulated by the Designer in performing this Contract.

**ARTICLE 10: RECORDS, DISCLOSURE STATEMENTS, ACCOUNTING CONTROLS, AUDITS**

- 10.1 Records to be Kept for Six Years.** The Designer shall make, and keep for at least six (6) years after final payment, books, records, and accounts which in reasonable detail accurately and fairly reflect the transactions and dispositions of the Designer. [M.G.L. c. 30, §39R(b)(1)-(2)]
- 10.2 Records Open to Inspection.** Until the expiration of six (6) years after final payment, the City of Waltham and any other public official authorized by law, shall have the right to examine any books, documents, papers or records of the Designer or of its Consultants and subcontractors that directly pertain to, and involve transactions relating to, the Designer or its Consultants and subcontractors. [M.G.L. c. 30, §39R(b)(1)-(2); Executive Order 195]
- 10.3 Changes in Method of Accounting.** If this Contract is a contract for an amount exceeding \$10,000 or is a contract for the design of a Project with an Estimated Construction Cost exceeding \$100,000, and if the Designer shall make any change in its method of maintaining records that would materially affect any statements filed by the Designer with the City of Waltham, the Designer shall forthwith deliver to the City of Waltham a written description of such change, the effective date thereof, and

the reasons therefore. The Designer shall submit with such description a letter from the Designer's independent certified public accountant approving or otherwise commenting on the change. [M.G.L. c. 30, §39R(b)(3)] The Designer hereby represents that there have been no such changes to date that have not been so reported to the City of Waltham.

**10.4 LEFT BLANK INTENTIONALLY**

**10.5 Filing of Statement of Management on Internal Accounting Controls.** If this is a Contract for an amount exceeding \$10,000 or is for the design of a Project with an Estimated Construction Cost exceeding \$100,000, the Designer maybe requested to file with the City of Waltham a statement of management as to whether the system of internal accounting controls of the Designer and its subsidiaries reasonably assures that: (1) transactions are executed in accordance with management's general and specific authorization; (2) transactions are recorded as necessary i) to permit preparation of financial statements in conformity with generally accepted accounting principles, and ii) to maintain accountability for assets; (3) access to assets is permitted only in accordance with management's general or specific authorization; and (4) the recorded accountability for assets is compared with the existing assets at reasonable intervals and appropriate action was taken with respect to any difference. The Designer may also be requested to file with the City of Waltham a statement prepared and signed by an independent certified public accountant, stating that the accountant has examined the statement of management on internal accounting controls, and expressing an opinion as to (1) whether the representations of management in response to this section and sections 1 and 2 above are consistent with the result of management's evaluation of the system of internal accounting controls; and (2) whether such representations of management are, in addition, reasonable with respect to transactions and assets in amounts which would be material when measured in relation to the applicant's financial statements. M.G.L. c. 30, §39R(c)]

**10.6 Representation Regarding Audited Financial Statement.** If this is a contract for an amount exceeding \$10,000 or is for the design of a Project having an Estimated Construction Cost exceeding \$100,000, the Designer represents that it has filed prior to the execution hereof and will continue to file annually, an audited financial statement for the most recent completed fiscal year as set forth in section 7 below. [M.G.L. c. 30, §39R(d)]

**10.7 Filing of Annual Statement Required.** The Designer shall annually file with the Commissioner of DCAM during the term of this Contract a financial statement prepared by an independent certified public accountant on the basis of an audit by such accountant. The final statement filed shall include the date of final payment. All statements shall be accompanied by an accountant's report. Such statements shall be made available to the City of Waltham upon request. [M.G.L. c. 30, §39R(d)]

**10.8 Records Not Public.** Records and statements required to be made, kept or filed under the provisions of this Article shall not be public records and shall not be open to public inspection; provided, however, that such records and statements shall be made available pursuant to the provisions of section 10.2 above.

## **ARTICLE 11: RELEASE AND DISCHARGE**

The acceptance by the Designer of the last payment for services paid under the provisions of either Article 8 or Article 9 in the event of termination of this Contract, shall in each instance operate as a release of the City of Waltham and every employee and agent thereof, from all claims of the Designer arising from this Contract, and from liability for any act or omission relating to or affecting the Designer's services hereunder, except for those written claims submitted by the Designer to the City of Waltham with the last payment requisition; and except that such acceptance shall not operate as a release of claims not known to designer, which designer could not reasonably have known about at the time of such acceptance.

**ARTICLE 12: INSURANCE**

**12.1 General Requirements.** The Designer shall purchase and maintain insurance of the type and limits listed in this Article with respect to the services to be performed under this Contract. This insurance shall be provided at the Designer's expense and shall be in force and effect for the full term of the Contract or for such longer period as this Article requires.

All policies shall be issued by companies lawfully authorized to write that type of insurance under the Laws of the City of Waltham with a financial strength rating of "A-" or better as assigned by A.M. Best Company, or an equivalent rating assigned by a similar rating agency acceptable to the City of Waltham, or otherwise acceptable to the City of Waltham.

The Designer shall submit three originals of each certificate of insurance acceptable to the City of Waltham simultaneously with the execution of this Contract. The certificate of Insurance shall have written in the description of Services box, through a policy endorsement, the following language: "**The City of Waltham is a named additional insured for General Liability**". Certificates shall show each type of insurance, insurance company, policy number, amount of insurance, deductibles/self-insured retentions, and policy effective and expiration dates. The Designer shall submit updated certificates prior to the expiration of any of the policies referenced in the certificates so that the City of Waltham shall at all times possess certificates indicating current coverage. Failure by the Designer to obtain all policy renewals and to provide the respective insurance certificates as required shall constitute just cause for termination of Designer's services under this Contract.

Termination, cancellation, or material modification of any insurance required by this Contract, whether by the insurer or the insured, shall not be valid unless written notice thereof is given to the City of Waltham at least thirty days prior to the effective date thereof, which shall be expressed in said notice.

The Designer is responsible for the payment of any and all deductibles under all of the insurance required below. The City of Waltham shall not be responsible for the payment of deductibles, self-insured retentions or any portion thereof.

**12.2 Workers' Compensation, Commercial General Liability, Automobile Liability, and Valuable Papers.**

The Designer shall purchase and maintain at its own expense during the life of this Contract the following insurance:

- i. Workers' Compensation Insurance in accordance with M.G.L. chapter 152.
- ii. Commercial General Liability Insurance, with a minimum limit of \$1,000,000 each occurrence.  
**The City of Waltham is a named additional insured.**
- iii. Automobile Liability Insurance at a limit of not less than \$1,000,000 each accident.
- iv. Valuable Papers insurance in an amount sufficient to assure the restoration of any plans, drawings, computations, field notes, or other similar data relating to the work covered by this Contract in the event of loss or destruction while in the custody of the Designer until the final fee payment is made or all data is turned over to the City of Waltham, and this coverage shall include coverage for relevant electronic media including, but not limited to, documents stored in computer aided design drafting (CADD) systems.

**12.3 Professional Liability.** The Designer shall maintain professional liability insurance covering errors and omissions and negligent acts of the Designer, and of any person or entity for whose performance the Designer is legally liable. Unless an alternate amount is otherwise specified in the documents incorporated by reference into Section 3.1 of this Contract, the minimum amount of such insurance shall equal the lesser of \$5,000,000 or 10% of the Project's Fixed Limit Construction Cost but in no event less than \$250,000 per claim. Unless the Designer is specifically required to provide project

specific insurance in the documents incorporated by reference into Section 3.1, the policy may be in a "claims made" format. If the policy is a "claims made" policy, it shall include a retroactive date that is no later than the effective date of this Contract, and an extended reporting period of at least six years after the earlier of: (1) the date of official acceptance of the completed Project by the City of Waltham; (2) the date of the opening of the Project to public use; (3) the date of the acceptance by the general contractor of a final pay estimate prepared by the City of Waltham pursuant to M.G.L. chapter 30; or (4) the date of substantial completion of the Construction Contract and the taking of possession of the Project for occupancy by the City of Waltham which requirement can be met by providing renewal certificates of professional liability insurance to the City of Waltham as evidence that this coverage is being maintained.

**12.4 Liability of Designer.** Insufficient insurance shall not release the Designer from any liability for breach of its obligations under this Contract. Without limitation, the Designer shall bear the risk of any loss if its valuable papers insurance coverage is insufficient to cover the loss of any work covered by this Contract.

#### **ARTICLE 13: INDEMNIFICATION**

The Designer shall indemnify and hold harmless the City of Waltham and all of their agents and employees from and against all claims, damages, losses and expenses, including but not limited to court costs, reasonable attorneys' fees, interest and costs arising out of or resulting from the wrongful and/or negligent acts or omissions of the Designer in performance of the services covered by this Contract and/or of failure to comply with the terms and conditions of this Contract, whether by Designer or its employees, Consultants or subcontractors, provided that the City of Waltham shall notify the Designer of such suits and claims within a reasonable time after the City of Waltham becomes aware of them. The Designer shall be afforded an opportunity to participate in the defense and/or settlement of all such suits and claims. The Designer shall not be bound by the amount of damages suffered in any litigation or settlement unless the Designer is given the opportunity to participate in negotiations for settlement and/or defense of such litigation or claim.

#### **ARTICLE 14: MISCELLANEOUS LEGAL REQUIREMENTS**

**14.1. Left Blank**

**14.2. Anti-Boycott Covenant [Executive Order #130].** The Designer warrants, represents and agrees that during the time this Contract is in effect, neither it nor any affiliated company, as hereafter defined, will participate in or cooperate with an international boycott, as defined in section 999 (b) (3) and (4) of the Internal Revenue Code of 1954, as amended, or engage in conduct declared to be unlawful by General Laws Chapter 151E, §§2 and 3. If there shall be a breach in the warranty, representation and Contract contained in this section, then without limiting such other rights as it may have the City of Waltham shall be entitled to rescind this Contract. As used herein, an affiliated company shall be any business entity of which at least 51% of the ownership interests are directly or indirectly owned by the contractor or by a person or persons or business entity or entities directly or indirectly owning at least 51% of the ownership interests of the contractor, or which directly or indirectly owns at least 51% of the ownership interests of the contractor.

#### **ARTICLE 15: NON-DISCRIMINATION IN EMPLOYMENT AND AFFIRMATIVE ACTION**

**15.1 Compliance.** The Designer shall comply with all Laws promoting fair employment practices or prohibiting employment discrimination and unfair labor practices and shall not discriminate against any qualified employee or applicant for employment because of race, color, national origin, ancestry,

age sex, religion, physical or mental handicap, or sexual orientation or for exercising any right afforded by Law. The Designer shall comply with all applicable Laws prohibiting discrimination in employment including but not limited to: Title VII of the Civil rights Act of 1964; the Age Discrimination in Employment Act of 1967; Section 504 of the Rehabilitation Act of 1973; M.G.L. c. 151B, s. 4(1); and all relevant administrative orders and executive orders, including Executive Order 227 and Executive Order 246. If a complaint or claim alleging violation of such statutes, rules or regulations is presented to the Massachusetts Commission Against Discrimination (MCAD), the Designer and its agents agree to cooperate fully with MCAD in the investigation and disposition of such complaint or claim. In the event of the Designer's noncompliance with the provisions of this section, the City of Waltham shall impose such sanctions as it deems appropriate, including, but not limited to, withholding of payments due the Designer under this Contract until the Designer complies, and termination or suspension of this Contract.

**15.2 Material Breach.** Any breach of this Article shall be regarded as a material breach and shall be subject to all other sections of this Contract. The City of Waltham shall have access to all records which are necessary to document compliance with this Article.

#### **ARTICLE 16: CHOICE OF LAW**

This Contract shall be construed under and governed by the laws of the City of Waltham of Massachusetts. The Designer, and the agents thereof, agree to bring any federal or state legal proceedings arising under this Contract, in which City of Waltham is a party, in a court of competent jurisdiction within the City of Waltham of Massachusetts. This section shall not be construed to limit any rights a party may have to intervene in any action, in any court or wherever, pending, in which the other is a party.

#### **ARTICLE 17: AMENDMENTS, SEVERABILITY, and WAIVERS**

No amendment to this Contract shall be effective unless it is in writing and is executed by authorized representatives of both parties. If any provision of this Contract is declared or found illegal, unenforceable, or void, then both parties shall be relieved of all obligations under that provision. The remainder of the Contract shall be enforced to the fullest extent permitted by law. The City of Waltham reserves the right to waive any provision or requirement of this Contract if the City of Waltham determines that such waiver is justified and in the public interest. No such waiver shall be effective unless in writing and signed by the Authorized Representative of the City of Waltham. No other action or inaction by the City of Waltham shall be construed as a waiver of any provision of this Article.

#### **ARTICLE 18: NON-APPROPRIATION**

The City of Waltham certifies that at the time of the execution of this Contract, sufficient appropriations exist and shall be encumbered to fund the Contract Price. Payments are subject to appropriation and shall be made only for work performed in accordance with the terms of this Contract. The Designer shall not be obligated to perform, and may not perform, services outside the duration and scope of this Contract without an appropriate amendment to this Contract, and a sufficient appropriation(s) to support such additional services. The City of Waltham may immediately terminate or suspend this Contract in the event that the appropriation(s) funding this Contract is eliminated or reduced to an amount which will be insufficient to support anticipated future obligations under this Contract.

#### **ARTICLE 19: NOTICES, APPROVALS, and INVOICES**

Notices to the Designer shall be deemed given when hand-delivered to the Designer at the

Project site, or when deposited in the U.S. mail addressed to the Designer at the Designer’s address specified in this Contract, when delivered by courier to said address, or when delivered via e-mail or facsimile transmission. Unless otherwise specified in writing by the City of Waltham, notices and deliveries to the City of Waltham shall be effective only when delivered to the City of Waltham at the address specified in this Contract and date-stamped at the reception desk or for which a receipt has been signed by the agent or employee designated by the City of Waltham to receive official notices.

**ARTICLE 20: CERTIFICATIONS OF DESIGNER MADE UNDER PAINS AND PENALTIES OF PERJURY**

No changes shall be made in the matters represented in this Article at any time during the life of this Contract without written notification to the City of Waltham and when required, receipt of written Approval from the City of Waltham. (Attach additional sheets if necessary for each section.)

**20.1 Designer's Beneficial Owners.** By signing this Contract, the Designer certifies under the penalties of perjury that the following named entities and individuals are the legal and beneficial owners of the Designer as of the date of the execution hereof (attach additional sheets if necessary):

CORPORATION: (Names of Officers and Shareholders of Corporation, including their titles,

\_\_\_\_\_  
\_\_\_\_\_

**Federal ID Number:** \_\_\_\_\_

PARTNERSHIP: (Names of all Partners):

\_\_\_\_\_  
\_\_\_\_\_

**Federal ID Number:** \_\_\_\_\_

INDIVIDUAL (Name of Owner):\_\_\_\_\_

\_\_\_\_\_

**20.2 Persons Having an Interest in this Contract.** *"No contract to provide consultant services shall be awarded by the City of Waltham, or by any department, board, commission, or other agency acting in its behalf, unless the person signing such contract on behalf of the party contracting to provide such services files with the Comptroller a statement under the penalties of perjury setting forth the names and addresses of all persons having a financial interest therein, not including, however, any person whose only financial interest therein consists of the holding of one percent or less of the capital stock of a corporation contracting to provide such services."*

NOTE: Individuals who sign this Contract in their individual capacity must also complete the certification below as well as sign this Contract. For the purpose of this directive, the term "person

having a financial interest" will generally refer to any person who, in some direct manner, will benefit financially from a given contractual relationship with the City of Waltham. However, this may not, in every case, preclude the possibility of an existing financial interest within the meaning of the statute where a financial benefit is to be realized in some indirect manner. Where doubts arise in a specific case, it is advisable that names and addresses be included.

By signing this Contract, the individual executing this Contract on behalf of the Designer hereby certifies under the penalties of perjury that the following sets forth the names and addresses of all persons having a financial interest in this Contract, not including any person whose only financial interest herein consists of the holding of one percent or less of the capital stock of Designer if Designer is a corporation, in addition to the persons listed in section 21.1 above:

Name

Address

---

---

---

**20.3 Professional Registrations.** By signing this Contract, the individual executing this Contract on behalf of the Designer certifies under the penalties of perjury that the following named individuals are registered by the City of Waltham as architects, landscape architects, or engineers pursuant to the

provisions of General Laws Chapter 112, §§ 60A - 60O and further that i) if the Designer is an individual the Designer is the individual named below, ii) if the Designer is a partnership, the majority of all the partners are persons who are registered architects, landscape architects, or engineers, iii) if the Designer is a corporation, sole proprietorship or joint stock company or other entity, the majority of the directors or a majority of the stock ownership and the chief executive officer, are persons who are registered architects, landscape architects, or engineers and the person to have the Project in his or her charge is registered in the discipline required for the Project, or iv) if the Designer is a joint venture, each joint venturer satisfies the requirements of the preceding clauses i – iii as the case may be

Name

Title

Mass. Registration

---

---

---

---

---



- 20.4 Resume on File with Designer Selection Board.** By signing this Contract, the Designer certifies under the penalties of perjury that in accordance with the provisions of General Laws Chapter 29, section 29A (4) a resume of the Designer has been filed with the Designer Selection Board.
- 20.5 No Inducements.** By signing this Contract, the Designer certifies under the penalties of perjury that the Designer has not given, offered or agreed to give any person, corporation, or other entity any gift, contribution or offer of employment as an inducement for, or in connection with, the award of the Contract for design services; no consultant to or subcontractor for the Designer has given, offered or agreed to give any gift, contribution or offer of employment to the Designer, or to any other person, corporation, or entity as an inducement for, or in connection with, the award to the consultant or subcontractor of a contract by the Designer; and no person, corporation or other entity, other than a bona fide full-time employee of the Designer has been retained or hired by the Designer to solicit for or in any way assist the Designer in obtaining the Contract for design services upon an Contract or understanding that such person, corporation or other entity be paid a fee or other consideration contingent upon the award of the Contract to the Designer.
- 20.6 Tax Returns.** By signing this Contract, the Designer certifies under the penalties of perjury that pursuant to General Laws Chapter 62C §49A, the Designer has filed all state tax returns, paid all taxes and complied with all Laws of the City of Waltham relating to taxes; and that pursuant to General Laws Chapter 151A, § 19A, the Designer has complied with all Laws of the City of Waltham relating to contributions and payments in lieu of contributions to the Employment Security System.
- 20.7 Existing Government Contracts.** By signing this Contract, the Designer certifies under the penalties of perjury that the following is a listing of all other existing contracts or income derived by Designer from the City of Waltham or any political subdivision thereof or public authority therein, from the Federal Government or any agency thereof, and from the City of Waltham or any governmental source for services rendered.

CONTRACT DESCRIPTION	PRESENT STATUS %	FEE	TOTAL FEE

- 20.8 Annual Reports; Corporate Filings.** By signing this Contract, the Designer certifies under the penalties of perjury that, if the Designer is a corporation, the Corporation has filed with the State of Secretary all certificates and annual reports required by Chapter 156B, §109 (Business Corporation), by Chapter 181, §4 (Foreign Corporation), or by Chapter 180, §26A (Non-Profit Corporation) of the Massachusetts General Laws.
- 20.9 Left blank Intentionally**
- 20.10 Debarment; Suspension.** By signing this Contract, the Designer certifies under the penalties of perjury that the Designer is not currently debarred or suspended by the City of Waltham of Massachusetts, or

any if its entities or subdivisions under any City of Waltham law or regulation, including but not limited to M.G.L. c. 29, § 29F and M.G.L. c. 152, § 25C and that it is not currently debarred or suspended by the Federal Government under any federal law or regulation

**SIGNATURES**

IN WITNESS WHEREOF, the parties hereto have executed this Contract as of the date of its execution by the City of Waltham of Massachusetts below, first written above and the individual executing this Contract on behalf of the Designer makes the representations and certifications set forth in this Design Contract under the pains and penalties of perjury.

**DESIGNER:** \_\_\_\_\_

By: \_\_\_\_\_, Date: \_\_\_\_\_

Its:  
Hereunto duly authorized

**CITY OF WALTHAM:**

By: \_\_\_\_\_ Date: \_\_\_\_\_

Its: Mayor, Jeannette McCarthy  
Hereunto duly authorized

By: \_\_\_\_\_ Date: \_\_\_\_\_

Its: Chief Procurement Officer, Joseph Pedulla  
Hereunto duly authorized

By: \_\_\_\_\_ Date: \_\_\_\_\_

Its: Traffic Engineer, Michael Garvin  
Hereunto duly authorized

By: \_\_\_\_\_ Date: \_\_\_\_\_

Its: Auditor, Paul Centofanti  
Hereunto duly authorized

**As To Form Only**

By: \_\_\_\_\_ Date: \_\_\_\_\_

Its: Assistant City Solicitor, Luke Stanton

**ATTACHMENT A****SCOPE OF SERVICES**

This project involves the Design of a new traffic signal equipment (mast arms, signal posts, controller, cabinet, etc.) at the intersection of Beaver Street and Warren Street. Also, part of the design shall include ADA compliant wheel chair ramp(s) and crosswalks as showing. The Designer shall deliver the 100% of the completed design within **One hundred and eighty (180) days** from the date of the Notice-to-Proceed

Submit **5 copies of your response** bound with a single staple and printed single sided.

Consultant shall be responsible for a limited bidding involvement consisting of:

- a. Submit to the purchasing department drawings, specifications (Calibri font size 11) and bid price sheet
- b. Attending the pre bid meeting
- c. Answering technical questions
- d. Reviewing bidders' responses, checking bid calculations and checking references
- e. Making recommendation for award to the Chief Procurement Officer.

---

**ATTACHMENT B**  
**CERTIFIED AVERAGE HOURLY RATES OF  
DESIGNER'S AND DESIGNER'S CONSULTANTS' PERSONNEL**

(Use additional sheets if necessary. Note: Do not list any support staff.)

**Design Firm Principal:**

**Design Firm Associate:**

**Design Firm Project Manager:**

**Design Firm Project Architect:**

**Design Firm CAD Operator:**

---

**[The following categories are to be completed for each Consultant.]**

**Name of Consultant Firm:**

**Consultant Principal:**

**Consultant Associate:**

**Consultant Project Manager:**

**Consultant Project Engineer:**

**Consultant CAD Operator:**

---

**Name of Consultant Firm:**

**Consultant Principal:**

**Consultant Associate:**

**Consultant Project Manager:**

**Consultant Project Engineer:**

---

**Consultant CAD Operator:**

---

**Name of Consultant Firm:**

**Consultant Principal:**

**Consultant Associate:**

**Consultant Project Manager:**

**Consultant Project Engineer:**

**Consultant CAD Operator:**

---

**Name of Consultant Firm:**

**Consultant Principal:**

**Consultant Associate:**

**Consultant Project Manager:**

**Consultant Project Engineer:**

**Consultant CAD Operator:**

---

**Name of Consultant Firm:**

**Consultant Principal:**

**Consultant Associate:**

**Consultant Project Manager:**

**Consultant Project Engineer:**

**Consultant CAD Operator:**

**“WET” SIGNATURE IS REQUIRED**

**ATTACHMENT C**

**DESIGNER'S TRUTH-IN-NEGOTIATIONS CERTIFICATE**

The Designer for design services for:

\_\_\_\_\_, hereby certifies  
and agrees to the following:

- a) The Designer certifies that the wage rates and other costs used to support the Designer’s compensation are accurate, complete, and current at the time of contracting; and
- b) The Designer agrees that the original contract price and any additions to the contract may be adjusted within six years of completion of the contract to exclude any significant amounts if the City of Waltham determines that the fee was increased by such amounts due to inaccurate, incomplete, or noncurrent wage rates or other costs.

Designer Firm:

\_\_\_\_\_

By: \_\_\_\_\_  
Duly authorized

Print Name \_\_\_\_\_

Date: \_\_\_\_\_

**“WET” SIGNATURE IS REQUIRED**

**NON-COLLUSION FORM AND TAX COMPLIANCE FORM**

**CERTIFICATE OF NON-COLLUSION**

The undersigned certifies under penalties of perjury that this bid or proposal has been made and submitted in good faith and without collusion or fraud with any other person. As used in this certification, the word “person” shall mean any natural person, business, partnership, corporation, union, committee, club, or other organization, entity or group of individuals. The undersigned certifies that no representations made by any City officials, employees, entity, or group of individuals other than the Purchasing Agent of the City of Waltham was relied upon in the making of this bid

\_\_\_\_\_  
(Authorized Signature)

\_\_\_\_\_  
Date

\_\_\_\_\_  
(Name of business)

**“WET” SIGNATURE IS REQUIRED**

**TAX COMPLIANCE CERTIFICATION**

Pursuant to M.G.L. c. 62C, & 49A, I certify under the penalties of perjury that, to the best of my knowledge and belief, I am in compliance with all laws of the Commonwealth relating to taxes, reporting of employees and contractors, and withholding and remitting child support.

\_\_\_\_\_  
(Authorized Signature)

\_\_\_\_\_  
Date

\_\_\_\_\_  
Name of business

**NOTE**

Failure to submit any of the required documents, in this or in other sections, with your bid response package may cause the disqualification of your proposal.

**“WET” SIGNATURE IS REQUIRED**

**CERTIFICATE OF VOTE OF AUTHORIZATION**

Date:

I \_\_\_\_\_, Clerk of \_\_\_\_\_ hereby certify that at a meeting of the Board of Directors of said Corporation duly held on the \_\_\_\_\_ day of \_\_\_\_\_ at which time a quorum was present and voting throughout, the following vote was duly passed and is now in full force and effect:

VOTED: That \_\_\_\_\_ (*name*) is hereby authorized, directed and empowered for the name and on behalf of this Corporation to sign, seal with the corporate seal, execute, acknowledge and deliver all contracts and other obligations of this Corporation; the execution of any such contract to be valid and binding upon this Corporation for all purposes, and that this vote shall remain in full force and effect unless and until the same has been altered, amended or revoked by a subsequent vote of such directors and a certificate of such later vote attested by the Clerk of this Corporation.

I further certify that \_\_\_\_\_ is duly elected/appointed \_\_\_\_\_ of said corporation

SIGNED:

(Corporate Seal)

\_\_\_\_\_  
Clerk of the Corporation:

Print Name: \_\_\_\_\_

---

COMMONWEALTH OF MASSACHUSETTS

County of \_\_\_\_\_

Date:

Then personally appeared the above named and acknowledged the foregoing instrument to be their free act and deed before me, \_\_\_\_\_

Notary Public;

My Commission expires: \_\_\_\_\_



**“WET” SIGNATURE IS REQUIRED**

**CORPORATION IDENTIFICATION**

The bidder for the information of the Awarding Authority furnishes the following information.

**If a Corporation:**

Incorporated in what state \_\_\_\_\_  
President \_\_\_\_\_  
Treasurer \_\_\_\_\_  
Secretary \_\_\_\_\_  
Federal ID Number \_\_\_\_\_

**If a foreign (out of State) Corporation** – Are you registered to do business in Massachusetts?

Yes \_\_\_\_\_, No \_\_\_\_\_

If you are selected for this work you are required under M.G.L.ch. 30S, 39L to obtain from the Secretary of State, Foreign Corp. Section, State House, Boston, a certificate stating that you Corporation is registered, and furnish said certificate to the Awarding Authority prior to the award.

**If a Partnership:** (Name all partners)

Name of partner \_\_\_\_\_  
Residence \_\_\_\_\_  
Name of partner \_\_\_\_\_  
Residence \_\_\_\_\_

**If an Individual:**

Name \_\_\_\_\_  
Residence \_\_\_\_\_

**If an Individual doing business under a firm’s name:**

Name of Firm \_\_\_\_\_  
Name of Individual \_\_\_\_\_  
Business Address \_\_\_\_\_  
Residence \_\_\_\_\_  
Date \_\_\_\_\_

Name of Bidder \_\_\_\_\_

By \_\_\_\_\_  
Signature \_\_\_\_\_

Title \_\_\_\_\_

Business Address \_\_\_\_\_ (POST OFFICE BOX NUMBER NOT ACCEPTABLE)

City State Telephone Number Today’s Date

**PROVIDE THREE (3) SERVICE APPROPRIATE REFERENCES**

1. Company Name:

Address:

Contact Name:

Phone #

Type of service/product provided to this Company:

Dollar value of service provided to this Company:

2. Company Name:

Address:

Contact Name:

Phone #

Type of service/product provided to this Company:

Dollar value of service provided to this Company:

3. Company Name:

Address:

Contact Name:

Phone #

Type of service/product provided to this Company:

Dollar value of service provided to this Company:

**NOTE**

**Failure to submit any of the required documents, in this or in other sections, with your bid response package will be cause for the disqualification of your company.**

**“WET” SIGNATURE IS REQUIRED**

**DEBARMENT CERTIFICATION**

In connection with this bid and all procurement transactions, by signature thereon, the respondent certifies that neither the company nor its principals are suspended, debarred, proposed for debarment, declared ineligible, or voluntarily excluded from the award of contracts, procurement or non procurement programs from the Commonwealth of Massachusetts, the US Federal Government and /or the City of Waltham. “Principals” means officers, directors, owners, partners and persons having primary interest, management or supervisory responsibilities with the business entity.

Vendors shall provide immediate written notification to the Purchasing Agent of the City of Waltham at any time during the period of the contract of prior to the contract award if the vendor learns of any changed condition with regards to the debarment of the company or its officers. This certification is a material representation of fact upon which reliance will be placed when making the business award. If at any time it is determined that the vendor knowingly misrepresented this certification, in addition to other legal remedies available to the city of Waltham, the contract will be cancelled and the award revoked.

---

Company Name \_\_\_\_\_

Address \_\_\_\_\_

City \_\_\_\_\_, State \_\_\_\_\_, Zip Code \_\_\_\_\_

Phone Number (\_\_\_\_) \_\_\_\_\_

E-Mail Address \_\_\_\_\_

Signed by Authorized Company Representative:

\_\_\_\_\_

Print name \_\_\_\_\_,

Date \_\_\_\_\_

---

**M.G.L. A. 156C § 67. CERTIFICATION OF AUTHORITY TO ACT FOR A LIMITED LIABILITY COMPANY (LLC) Complete only if your company is an LLC.**

Limited Liability corporations are required to file with the City a certificate showing they have the authority to contract.

Any person who is identified on the certificate of organization, as amended, of a domestic limited liability company, or on the application for registration, as amended, of a foreign limited liability company, as a manager or as a person who is authorized to execute any documents to be filed with the office of the state secretary, is required to certify as to the incumbency of any manager or member and as to the authority of any person, whether or not such person is identified on the certificate of organization or on the application for registration, to act for the limited liability company, including without limitation with respect to the matters referred to in section sixty-six, and any such certification shall be binding on the limited liability company in favor of a person relying in good faith on such certification, notwithstanding any inconsistent provisions of the operating agreement, side agreements among the members, the managers or both, by-laws or rules, resolutions or votes of the limited liability company.

**“WET” SIGNATURE IS REQUIRED**

**(Fill out if an LLC)**

**CERTIFICATE OF AUTHORITY LIMITED LIABILITY COMPANY**

The undersigned, being (a/the) duly elected, qualified and active (member/ manager) of \_\_\_\_\_, a Massachusetts limited Liability Company (hereinafter “the Company”)

Does Hereby Certify that:

1. The Articles of Organization of the Company were duly filed with the Office of the Secretary of State of the State of Massachusetts on \_\_\_\_\_ and the Articles of Organization have not been (further) amended.
2. The Company has complied with the publication requirements contained in Section 67 of the Limited Liability Company Law.
3. There exists an Operating Agreement of the Company and that the said Operating Agreement has not been amended or repealed and that the said Operating Agreement remains in full force and effect as of this date.
4. Neither the Articles of Organization nor the Operating Agreement (as amended) require any further act to be taken or a meeting to be held by its members other than as follows:
5. All said requirements, whether as contained in the Articles of Organization or in the Operating Agreement or by operation of law as to the transaction of \_\_\_\_\_, 20\_\_ have been met.
6. The following person or persons has/have been duly authorized by the Company to execute all documents in connection with said transaction and that the signature appearing to the right of their name(s) is his/her genuine signature.

NAME	OFFICE HELD	SIGNATURE
_____	_____	_____
_____	_____	_____

IN Witness Whereof, the undersigned has executed this Certificate of Authority this

\_\_\_\_\_ day of \_\_\_\_\_, 20\_\_\_\_\_.

\_\_\_\_\_  
(Signature)

STATE OF MASSACHUSETTS, COUNTY OF \_\_\_\_\_

On the \_\_\_\_\_ day of \_\_\_\_\_, 20\_\_ , before me, the undersigned personally appeared \_\_\_\_\_, personally known to me or proved to me on the basis of satisfactory evidence to be the individual(s) whose name(s) is (are) subscribed to the within instrument and acknowledged to me that he/she/ they executed the same in his/her/their capacity(ies), and that by his/her/their signature(s) on the instrument, the individual(s), or the person upon behalf of which the individual(s) acted, executed the instrument.

Notary Public: \_\_\_\_\_

My Commission Expires: \_\_\_\_\_ Notary Stamp:

**“WET” SIGNATURE IS REQUIRED**

**Beaver Street & Warren Street.**  
**DESIGN, New Traffic Signal**

**PRICE SHEET**

**(40 POINTS OF THE TOTAL AWARD VALUE)**

**My company offers the not too exceed, fixed,**

**Base DESIGN Price:** \$: \_\_\_\_\_

**Price for construction administration** \$: \_\_\_\_\_

**Total:** \$: \_\_\_\_\_

**My Company Acknowledges receipt of addenda #: \_\_\_\_\_.**

**Company:** \_\_\_\_\_

**Authorized Signature:** \_\_\_\_\_

**Print Name:** \_\_\_\_\_

**Phone:** \_\_\_\_\_, **Date:** \_\_\_\_\_

**E-Mail Address:** \_\_\_\_\_

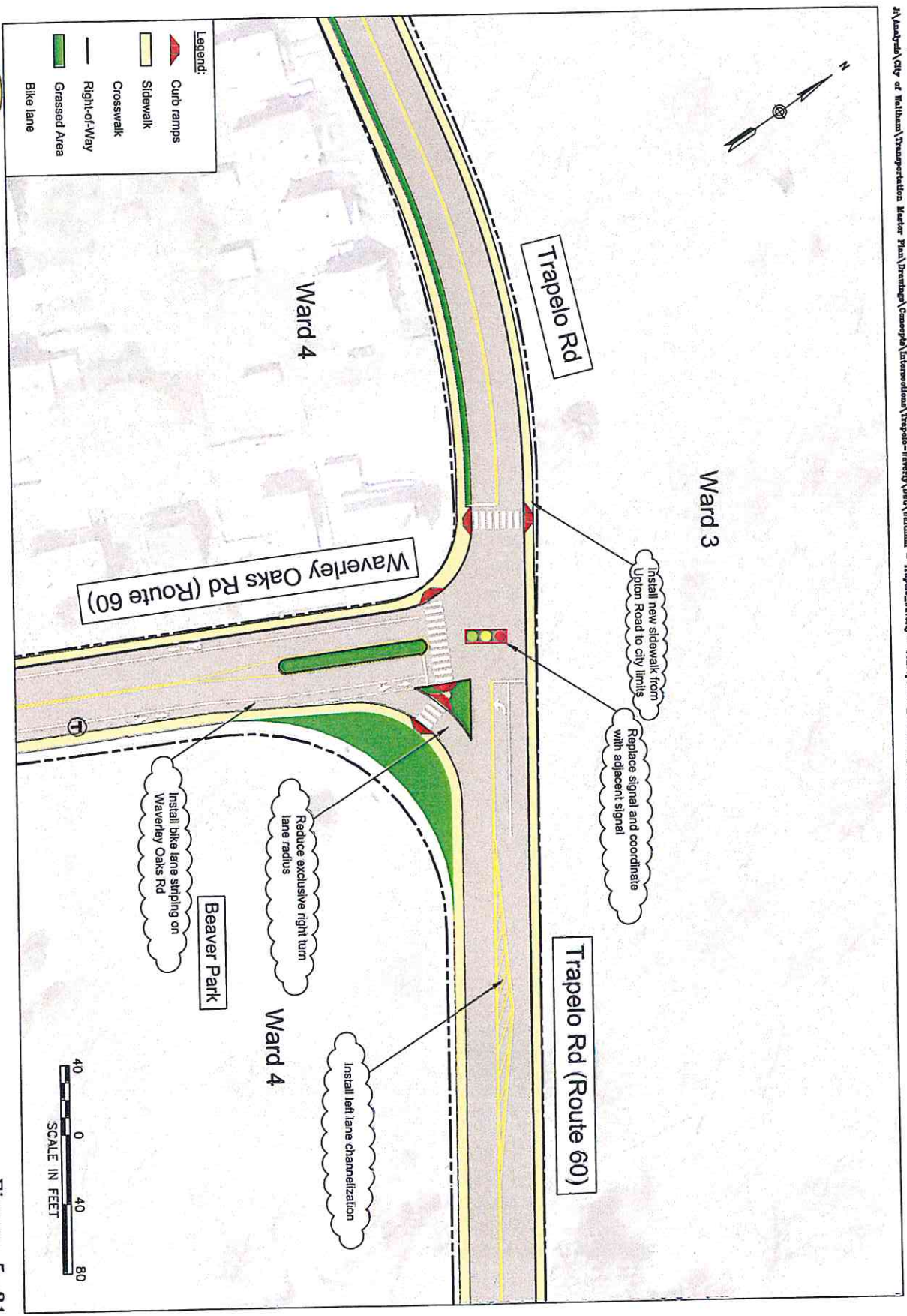

Trapelo Road at Waverly Oaks Road Preferred Concept  
City of Waltham Transportation Master Plan  
Waltham, Massachusetts

Figure 5-31



**Study Name** 6- Trapelo Rd and Waverly Oaks Rd TMC  
**Start Date** Wednesday, November 05, 2013 7:00 AM  
**End Date** Wednesday, November 05, 2013 6:00 PM  
**Site Code**

### Report Summary

Time Period	Vehicle Class	Westbound			Northbound			Eastbound			Crosswalk						
		Count	%	Approach %	Count	%	Approach %	Count	%	Approach %	Count	%	Approach %				
Peak 1 Specified Period 7:00 AM - 9:00 AM One Hour Peak One Hour Peak 7:30 AM - 8:30 AM	Car	449	96%	0%	99	94%	0%	174	97%	0%	528	97%	0%	2043	96%	0%	0
	Medium	18	4%	1%	7	7%	0%	3	2%	1%	8	2%	0%	55	2%	0%	4
	Heavy	0	0%	0%	0	0%	0%	2	1%	0%	1	0%	0%	4	0%	0%	0
	Bus	0	0%	0%	0	0%	0%	0	0%	0%	5	1%	0%	0	0%	0%	0
	Motor Bike (Road)	0	0%	0%	0	0%	0%	2	1%	0%	2	0%	0%	0	0%	0%	0
	Motor Bike	1	0%	0%	0	0%	0%	0	0%	0%	1	0%	0%	0	0%	0%	0
	Total	468	524	0	106	407	703	179	544	0	723	574	2122	0.91	0.77	0.91	0.77
	PHF	0.74	0.86	0	0.78	0.92	0.85	0.83	0.94	0	0.91	0.77	0.91	0.77	0.91	0.77	0.91
	Approach %			47%		15%	33%				34%	27%					
	Peak 2 Specified Period 4:00 PM - 6:00 PM One Hour Peak One Hour Peak 5:00 PM - 6:00 PM	Car	513	99%	0%	296	95%	0%	130	99%	0%	340	99%	0%	2252	99%	0%
Medium		1	0%	0%	2	1%	0%	1	1%	0%	0	0%	0%	12	0%	0%	4
Heavy		1	0%	0%	0	0%	0%	0	0%	0%	1	0%	0%	6	0%	0%	0
Bus		0	0%	0%	1	0%	0%	0	0%	0%	0	0%	0%	0	0%	0%	0
Motor Bike (Road)		0	0%	0%	0	0%	0%	0	0%	0%	2	0%	0%	2	0%	0%	0
Motor Bike		1	0%	0%	0	0%	0%	0	0%	0%	1	0%	0%	3	0%	0%	0
Total		516	433	0	299	857	564	131	344	0	475	815	2281	0.89	0.96	0.89	0.96
PHF		0.94	0.87	0	0.97	0.96	0.88	0.91	0.84	0	0.89	0.96	0.95	0.89	0.96	0.95	0.95
Approach %				42%		38%	25%				21%	36%					