

City of Waltham  
Purchasing Department  
Waltham, Massachusetts 02452  
**ADDENDUM NO. 6**

Plans & Specifications for: Elsie Turner Field & Graverson Playground, Waltham, MA

TO: ALL PLAN HOLDERS

This Addendum No. 6 is to modify, correct and/or supplement the Plans and Specifications.

Bidders are hereby informed that Plans and Specifications for the above-mentioned project are modified, corrected and/or supplemented as follows and that Addendum No. 6 becomes a part of the Contract Documents. Addendum No. 6 consists of Item 1 and attachment SK-2.

**THE FOLLOWING REVISIONS ARE MADE A PART OF THIS CONTRACT. RECEIPT OF THIS ADDENDUM AND ALL ADDENDA MUST BE ACKNOWLEDGED AS RECEIVED IN THE FORM FOR GENERAL BID SECTION 00310**

**ITEM 1: DELETE and REPLACE**

**DELETE** the bid due date of Thursday Dec. 7, 2017 at 10.00 AM and **REPLACE** with Wednesday Dec.13, 2017 at 10.00AM

**ITEM 2: REVISION**

**Elsie Turner:** Revise trench drain piping, trench drain rim elevation & spot grades are shown in SK-2, attached

**ITEM 3: THE PERIOD FOR QUESTIONS IS CLOSED**

The period for written questions is now closed. The City will not entertain further written questions for this project.

**END OF ADDENDUM 6**

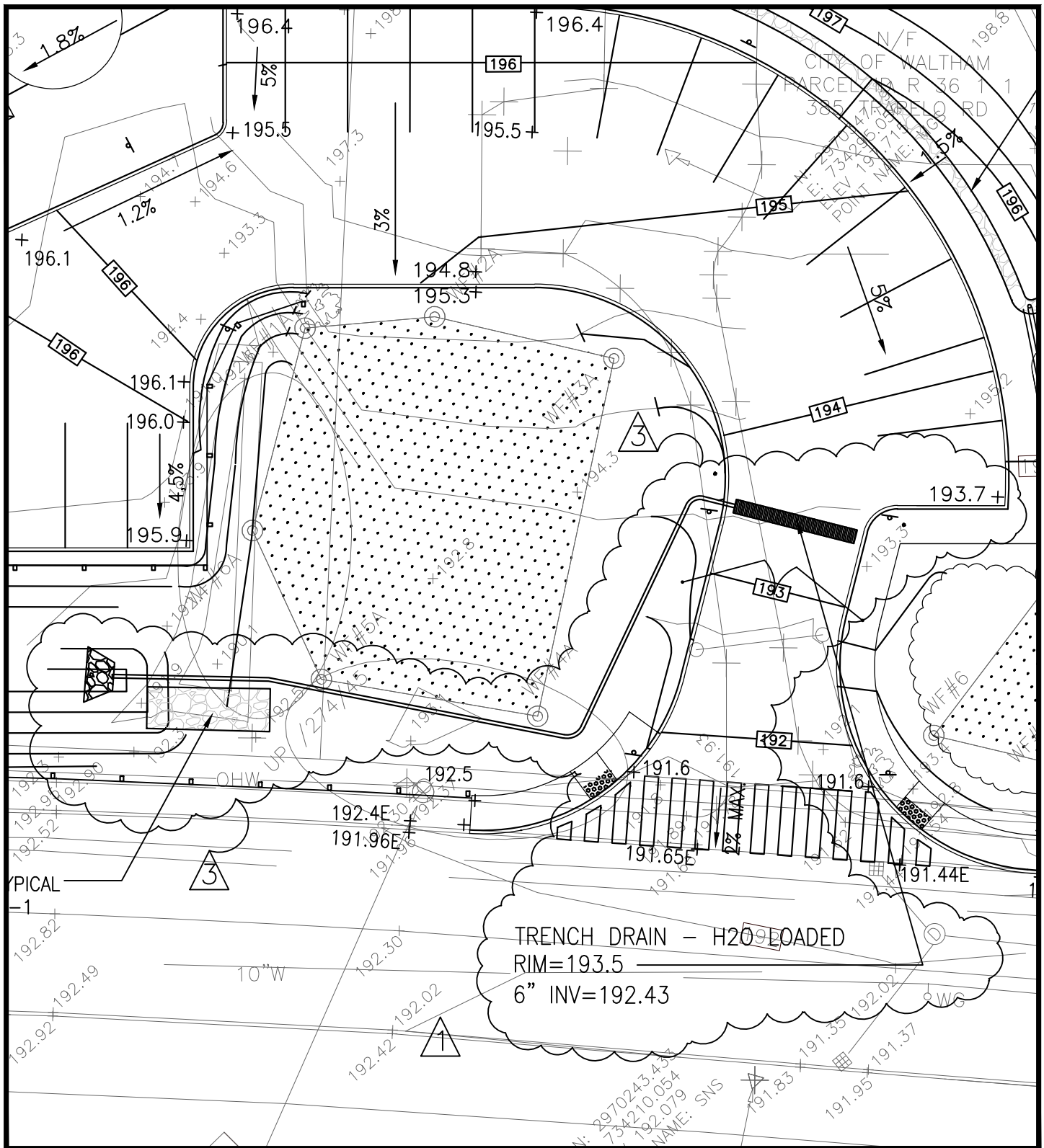

Project Title  
 ELSIE TURNER FIELD – ADDENDUM #6

Project Number  
 1710

Drawn By  
 CCC

Drawing Title  
 REVISION TO TRENCH DRAIN PIPING/GRADE REVISION

Scale  
 1"=20'

Date  
 12/04/2017

**Carolyn Cooney and Associates**

13 Elm Street, Milford, Massachusetts 01757  
 Telephone 508.478.8426, Fax 508.478.8607

Landscape Architecture

Drawing Number  
 SK\_2