

City of Waltham  
Purchasing Department  
Waltham, Massachusetts 02452

**ADDENDUM NO. 2**

Plans and Specifications for: Waltham Park Improvements Project : Logan Park  
Location: Waltham, MA

In accordance with documents prepared by: Carolyn Cooney & Associates

TO: ALL PLAN HOLDERS

This Addendum No. 2 is to answer the following questions asked at the pre-bid site walk, and to modify, correct and/or supplement the Plans and Specifications.

Bidders are hereby informed that Plans and Specifications for the above-mentioned project are modified, corrected and/or supplemented as follows and that Addendum No. 2 becomes a part of the Contract Documents. Addendum No. 2 consists of answers to Prebid Questions, Specification changes described in Items 1 and 2, and Drawing changes shown in SK L-1 through SK L-6. Bidders are required to acknowledge receipt of all addenda in Section 00300- Form for General Bid

Prebid Questions:

Q1. What is the required disposition of the salvaged climber?

*A1. The work of the Contract shall include transportation of the salvaged climber to a location within the City of Waltham to be designated by the City.*

Q2. When will the existing tree to be removed by others be removed?

*A2. The City will make an effort to remove the tree prior to the work of this Contract, however that schedule cannot be guaranteed.*

Q3. Does the 45 day schedule for completion of the work allow for the possible 6 to 8 week order time associated with the playground and site furniture in the contract?

*A3. Completion of the project within this time frame is important to the City, however the City recognizes that after ordering, the delivery time of materials is not within the control of the Contractor. If the Contractor places a timely order, the City will not enforce penalties related to late completion due the delivery time of these materials.*

Q4. What is the size of plant materials noted on Layout and Materials Plan?

A4. *Refer to Plant Schedule included as SKL-5.*

Q5. The spec requires the sign fabricator to do the installation. Would it be acceptable to have the Contractor do this work?

A5. *The City requires that the sign fabricator do the installation.*

Q6. For the precast concrete curbing at the new play area, is a precast angle piece acceptable?

A6. *A precast angle piece is acceptable. CCA has provided a layout plan with angles. Refer to SKL-6.*

Q7. Does the Jenswing manufacturer sell a harness replacement kit?

A7. *Yes.*

The following revisions are made a part of this Contract:

Item 1: Revision to specifications SECTION 10430, EXTERIOR SIGNS & PLAQUES

1.02 REQUIREMENTS INCLUDED, B.1. **Delete** the words “on relocated and salvaged”.

Item 2: Revision to specifications SECTION 10430, EXTERIOR SIGNS & PLAQUES

**Delete** Paragraph 2.03A Granite Posts.

**Add** the following:

“2.03 GRANITE POSTS

- A. Granite shall be furnished by the sign vendor.
- B. Granite shall be “Woodbury Grey” as supplied by Swenson Granite Works, 10 Main Street Route 109, Medway, Massachusetts 02053, (508)-533-2882 (Fax 508-533-344), or “Chelmsford Gray” as supplied by Fletcher Granite Company, 534 Groton Road, Westford, MA 01886, (978)-251-4031 (Fax 978-251-8773), or approved equal. Granite shall be supplied by a source approved by the Architect.
- C. Granite shall conform to the requirements of ASTM C 515, Architectural Grade and NBGA Specifications except as modified herein.
- D. Granite shall be standard grade, free of cracks, seams, starts, or other defects which may impair its strength, durability, or appearance. Exposed surfaces shall be free from spots, spalls, chips, stains, discoloration, or other defects which would affect its appearance. Color, texture, and finish shall be within the range of samples approved by the Architect.”

END OF ADDENDUM NO. 2

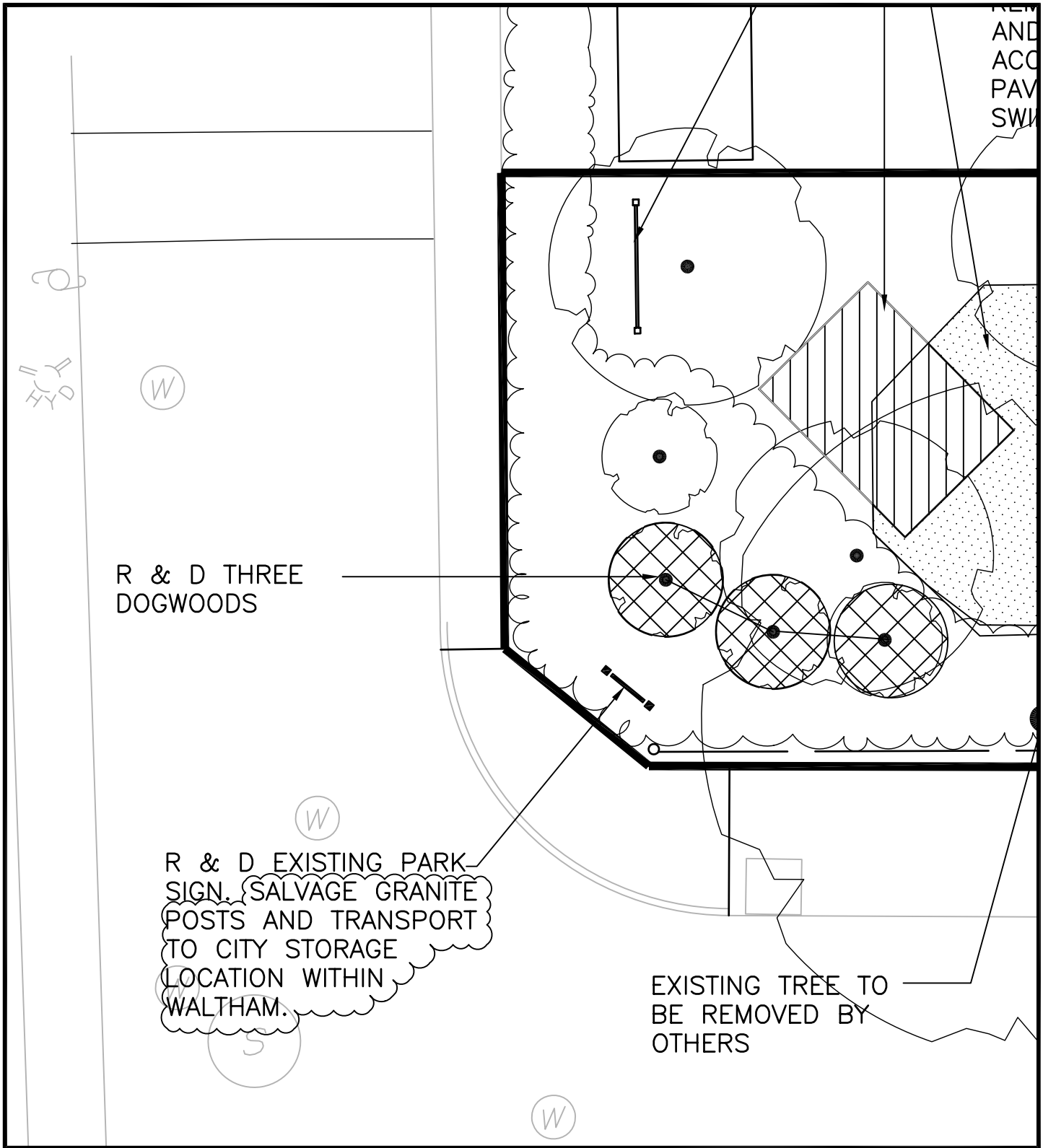

Project Title  
 LOGAN PARK IMPROVEMENTS – CITY OF WALTHAM

Project Number  
 1201.00

---

Drawing Title  
 REVISION TO L-2 SITE PREPARATION PLAN

Drawn By  
 CCC

Scale  
 1' = 10'

Date  
 8-24-2012

Drawing Number

**Carolyn Cooney and Associates**

13 Elm Street, Milford, Massachusetts 01757  
 Telephone 508.478.8426, Fax 508.478.8607

Landscape Architecture

SK L-1

# MARTYN

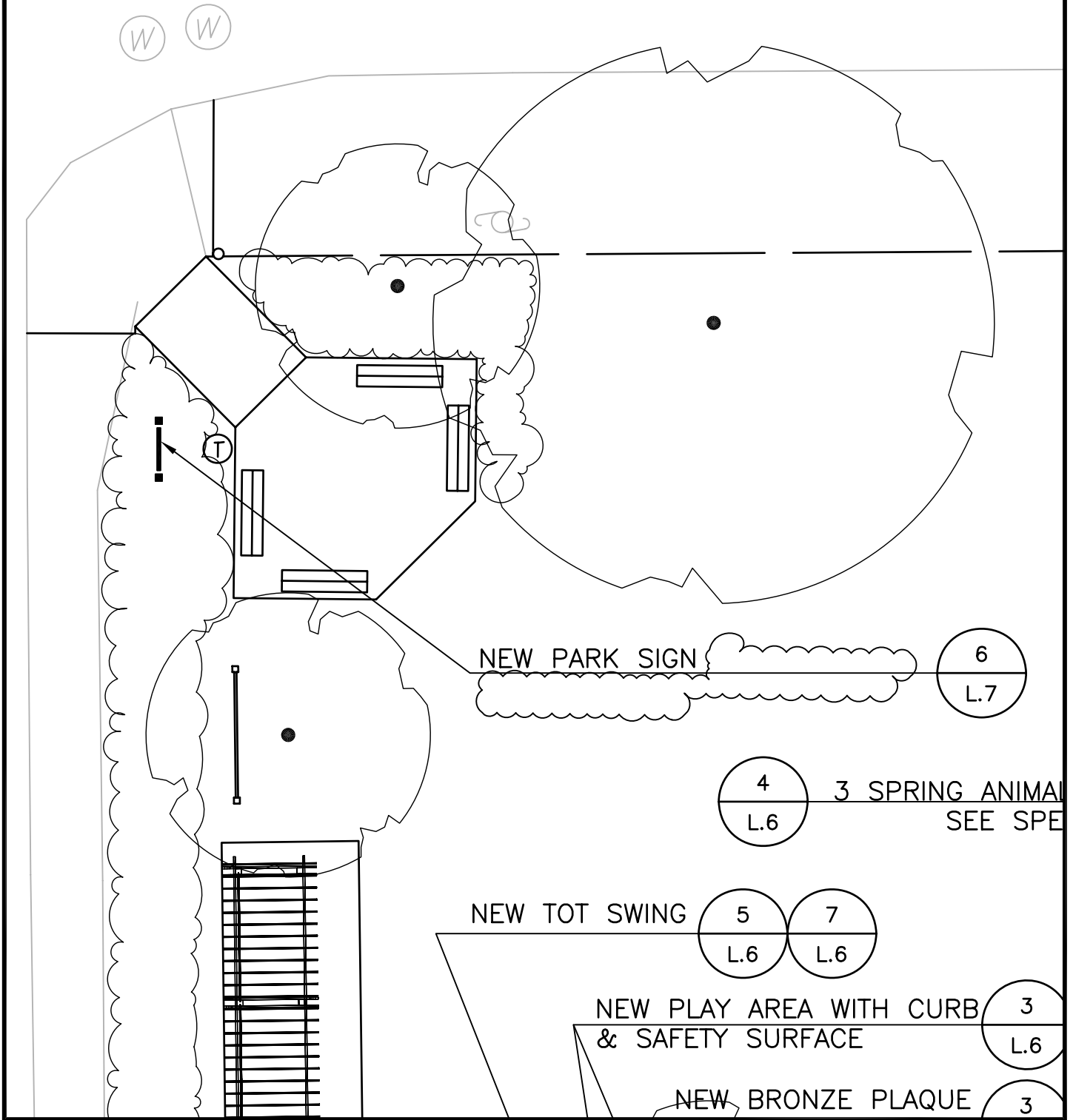

Project Title  
LOGAN PARK IMPROVEMENTS – CITY OF WALTHAM

Project Number  
1201.00

Drawing Title  
REVISION TO PARK SIGN

Drawn By  
CCC

Scale  
1"=10'

Date  
8-24-2012

Drawing Number

**Carolyn Cooney and Associates**

Landscape Architecture

13 Elm Street, Milford, Massachusetts 01757  
Telephone 508.478.8426, Fax 508.478.8607

SK L-2

<b>PLANT SCHEDULE</b>					
SCIENTIFIC NAME	COMMON NAME	SIZE	QUANTITY	SPACING	COMMENTS
<b>TREES</b>					
Ulmus americana "Valley Forge"	Hybird American Elm	4"-4-1/2" Cal.	1	See Plan for Location	B&B;6'-8" lowest branch height
Prunus serrulata "Kwanzan"	Kwanzan Cherry	3"-3-1/2" Cal.	1	See Plan for Location	B&B

Project Title Project Number  
 LOGAN PARK IMPROVEMENTS – CITY OF WALTHAM 1201.00

---

Drawing Title  
 PLANT SCHEDULE

Drawn By CCC  
 Scale NTS  
 Date 8-24-2012  
 Drawing Number

**Carolyn Cooney and Associates**

13 Elm Street, Milford, Massachusetts 01757  
 Telephone 508.478.8426, Fax 508.478.8607

Landscape Architecture

SK L-3

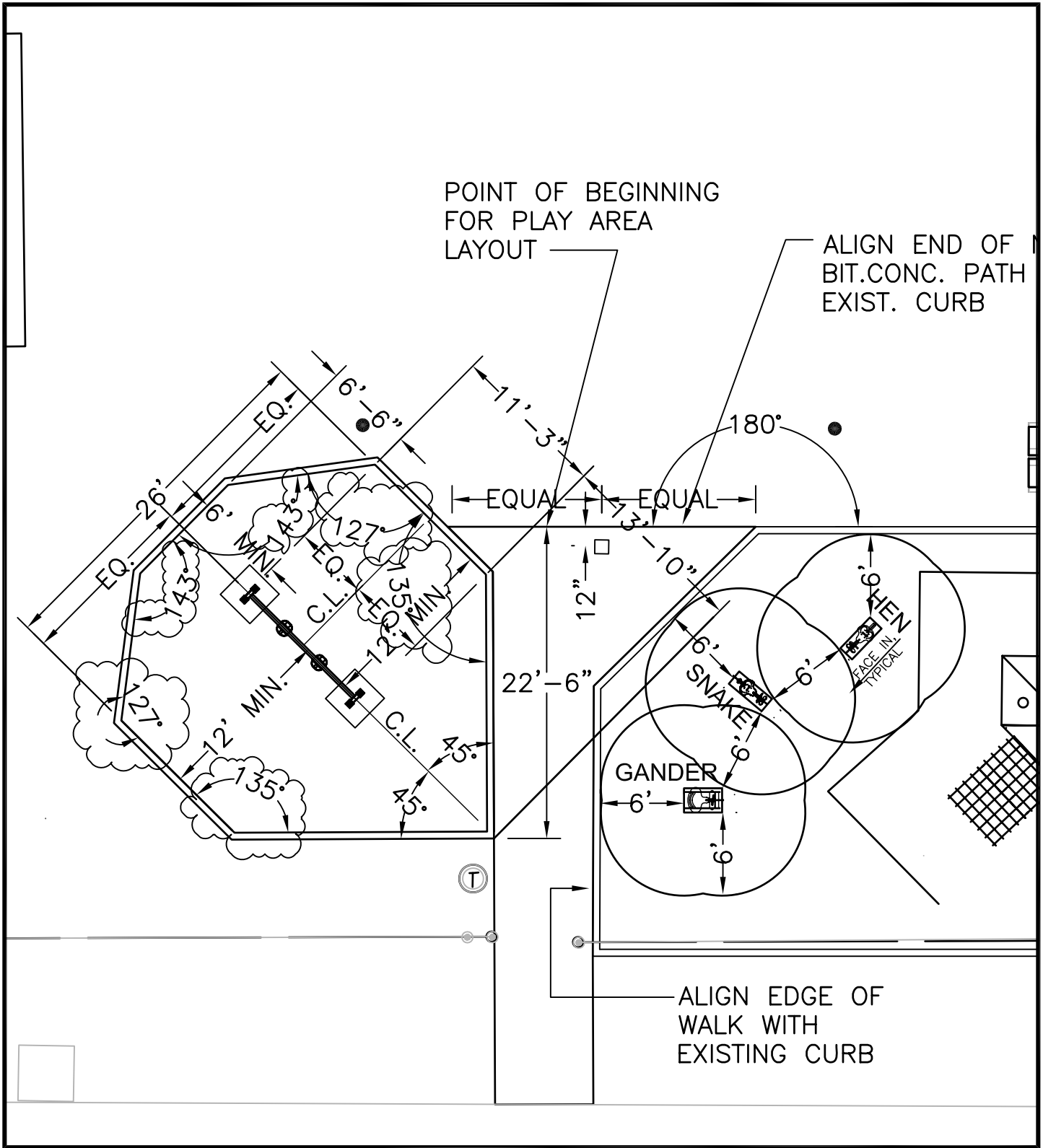

Project Title  
 LOGAN PARK IMPROVEMENTS – CITY OF WALTHAM

Project Number  
 1201.00

Drawn By  
 CCC

Drawing Title  
 REVISION TO L-4 LAYOUT PLAN: ADDITION OF  
 ANGULAR DIMENSIONS AT PLAY AREA

Scale  
 1" = 10'

Date  
 8-24-2012

Drawing Number

**Carolyn Cooney and Associates**

Landscape Architecture

SK L-4

13 Elm Street, Milford, Massachusetts 01757  
 Telephone 508.478.8426, Fax 508.478.8607

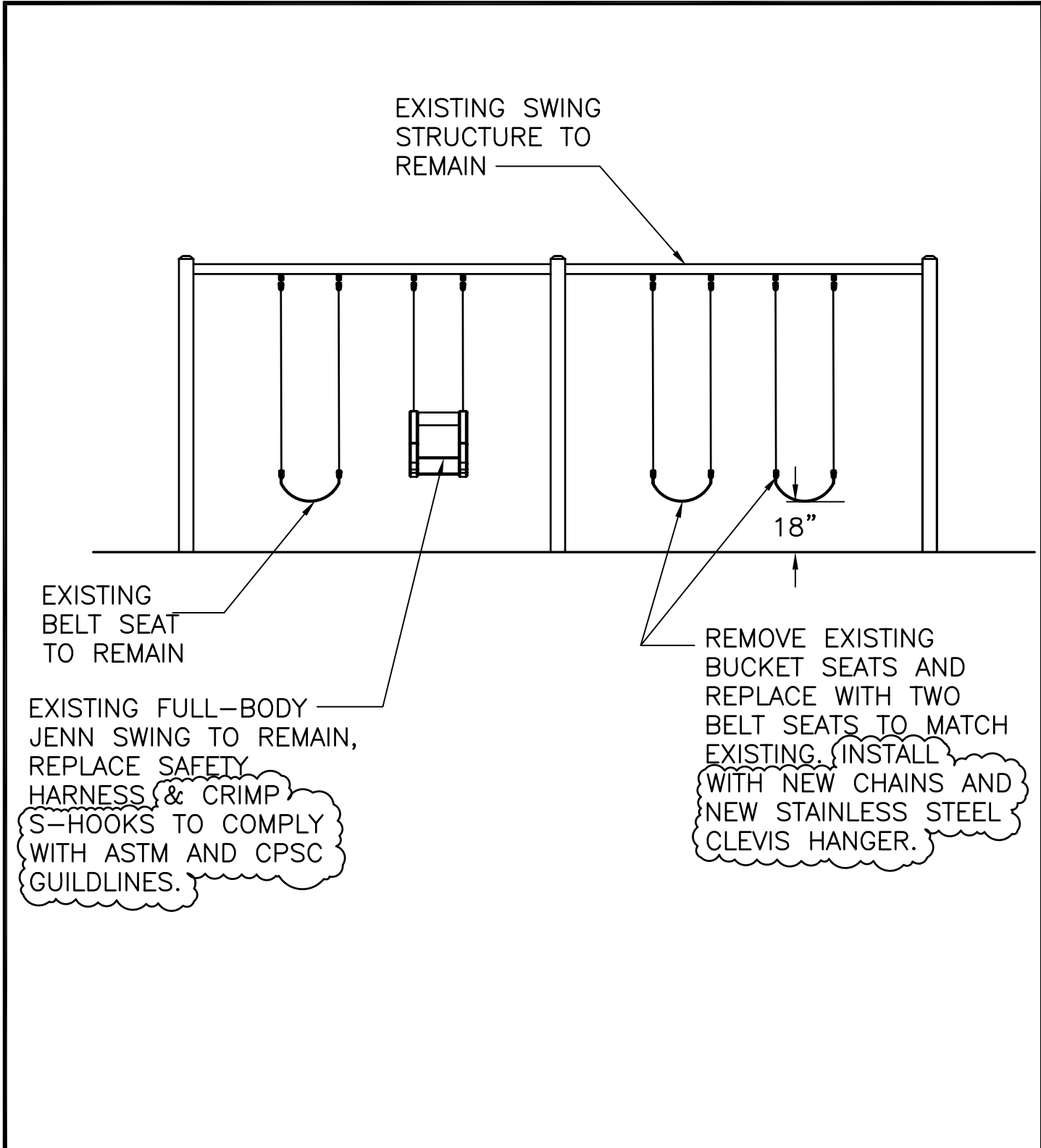

Project Title  
 LOGAN PARK IMPROVEMENTS – CITY OF WALTHAM

Project Number  
 1201.00

Drawn By  
 CCC

Drawing Title  
 REVISION TO L-6, DETAIL 6, MODIFICATION OF EXISTING  
 SWING STRUCTURE

Scale  
 1/4"=1'-0"

Date  
 8-24-2012

Drawing Number

**Carolyn Cooney and Associates**  
 13 Elm Street, Milford, Massachusetts 01757  
 Telephone 508.478.8426, Fax 508.478.8607

Landscape Architecture

**SK L-5**

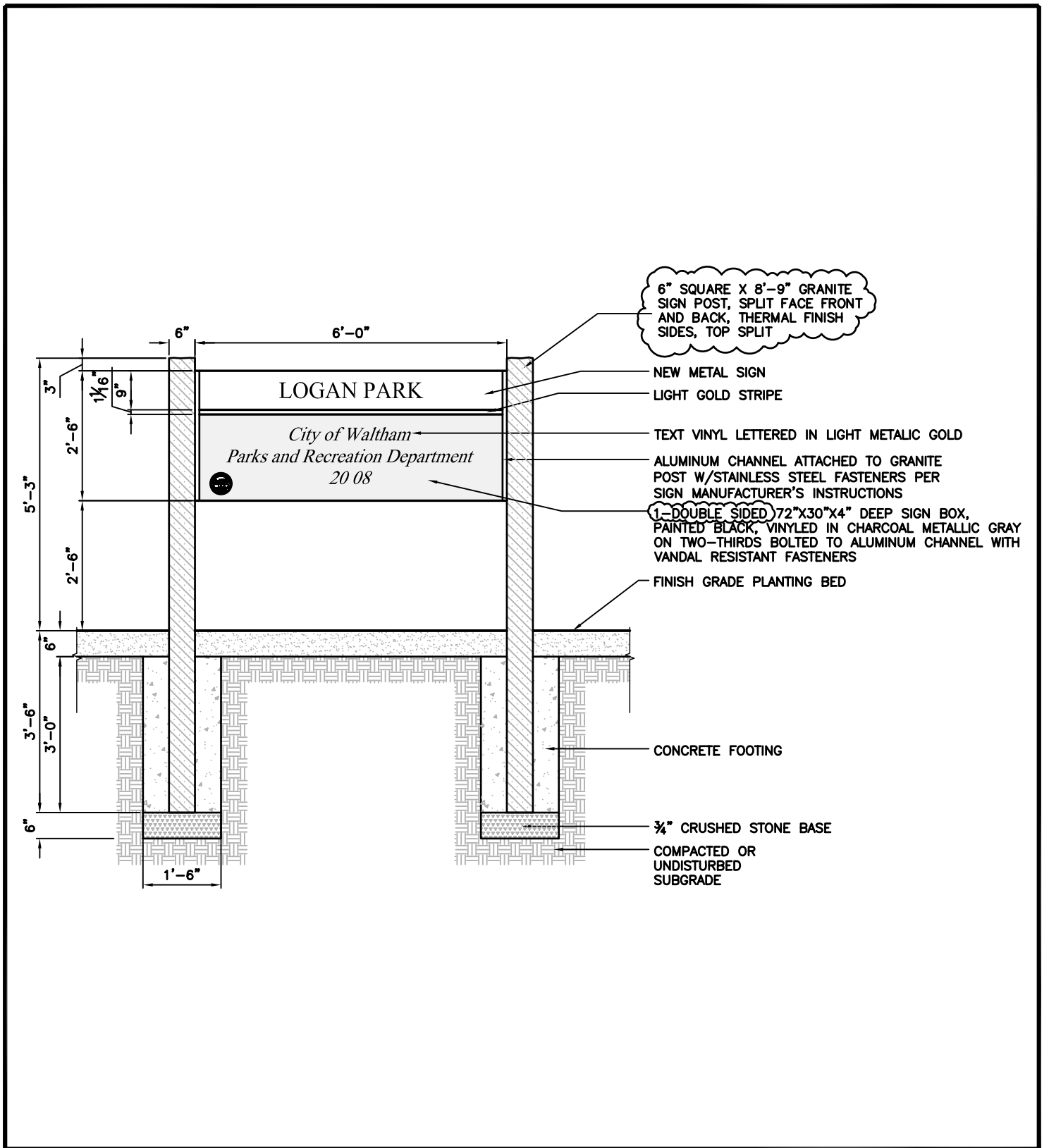

Project Title  
 LOGAN PARK IMPROVEMENTS – CITY OF WALTHAM

Project Number  
 1201.00

---

Drawing Title  
 REVISION TO L-7 DETAIL 6 – PARK SIGN & FOOTING

Drawn By CCC

Scale 3/8" = 1'

Date 8-24-2012

Drawing Number

Carolyn Cooney and Associates

Landscape Architecture

SK L-6

13 Elm Street, Milford, Massachusetts 01757  
 Telephone 508.478.8426, Fax 508.478.8607