

City of Waltham  
Purchasing Department  
Waltham, Massachusetts 02452

**ADDENDUM NO. 1**  
**12/11/2015**

Plans & Specifications for: Drake Playground, Waltham, MA

In accordance with documents prepared by: Carolyn Cooney & Associates

TO: ALL PLAN HOLDERS

This Addendum No. 1 is to modify, correct and/or supplement the Plans and Specifications.

Bidders are hereby informed that Plans and Specifications for the above-mentioned project are modified, corrected and/or supplemented as follows and that Addendum No. 1 becomes a part of the Contract Documents. Addendum No. 1 consists of Items 1 through 10, Drawing changes shown on SKL-1, L-1A, L-2, and L-7 and revised Bid Form, attached.

The following revisions are made a part of this Contract

**ITEM NO. 1**      **Revision to Bid Form to add Allowance for Big Belly Lease Payment.** See attached revised Bid Form.

**ITEM NO. 2**      **Revision to Specification Section 01010 Summary of Work**  
*Paragraph 1.02.A.3: Delete the words "Big Belly Kiosk".*

**ITEM NO. 3**      **Revision to Specification Section 01020 Allowances**

*Add Paragraph 1.03A & B as follows:*

"1.03    BIG BELLY ALLOWANCE

- A. The Contractor shall include as a line item in his/her bid, an allowance in the amount of \$25,000 for payment of a 5 year service agreement to be made between the City of Waltham and Big Belly, for subscription for 3 Big Belly Kiosks (Big Belly, 150A Street, Suite 103, Newton, MA; Contact Joe Nardello 617-340-6357).
- B. The City of Waltham will work directly with Big Belly in reviewing and signing the service agreement. Payment to Big Belly by the Contractor for the cost of the service agreement is to proceed only upon direction by the City, which will be given after the City has signed the agreement with Big Belly.
- C. The allowance and reimbursement for the cost of the service agreement does not include any provisions for Contractor time, overhead and profit or other expense related to the payment for the agreement, other than the direct cost of the service agreement charged by Big Belly.

- D. If the amount of the service agreement is more or less than the Allowance, the Contract sum shall be adjusted accordingly by Change Order.

**ITEM NO. 4 Revision to Specifications Section 02590 Color Coating & Crack Sealing.**

*1.02 Scope of Work. Add the word "crack-sealing" to Item 1.02.B.2 revised to read as follows:*

- "2. Crack-sealing and color coating of existing spray park over existing color-coating, with new colors and pattern."

**ITEM NO. 5 Revision to Drawing L-2 to add crack sealing of existing spray park.**

**ITEM NO. 6 Revision to Specifications Section 02800 Site Furnishings**

*Revise Paragraph 1.02.C.1 as follows:*

*Delete the words "Big Belly Kiosk" and replace with the following:*

- "1. The Contractor shall be responsible for constructing concrete pads for the Big Belly Kiosks as detailed on the Drawings. Installation of the Big Belly Kiosks, including delivery to the site, will be by Others, namely Big Belly, Newton, MA.
  - a. The Contractor shall be responsible for any coordination necessary to the installation by Others. "

*Paragraph 2.02: Delete in its entirety.*

**ITEM NO. 7 Revision to Specifications Section 02810 Irrigation System, 2.02. A. PE Irrigation Pipe.**

*Revise "SIDR" to "IDR" and revise "Oil Creek" to "Charter Plastics", revised to read as follows:*

- "2.02.A Irrigation pipes shall be polyethylene (PE3408) pipe, IDR 15, Class 100, Type III, Grade 3, Class C conforming to ASTM P2239, with a minimum pressure rating of 100 psi as manufactured by Charter Plastics or equal. Polyethylene pipe shall only be used in landscape areas."

**ITEM NO.8 Revision to Specifications Section 02930 Sodded Athletic Field, 3.03 Maintenance of Sodded Areas.**

*Revise 3.03.E. to read as follows:*

- "E. Watering shall be provided through use of the new irrigation system. Where sodded areas are outside of the irrigated zone, watering shall be accomplished by the use of a temporary watering system connected to the irrigation system."

**ITEM NO. 9 Revision to Drawing L-1A**

Revision to note existing benches (2) and existing trash receptacle (1) at Basketballcourt, and baseball backstop and athletic benches to remain and be protected. Refer to attached drawing L-1A.

**ITEM NO. 10    Revision to Drawing L-7**

*Size of irrigation main revised to 3" diameter. See revised L-7 attached.*

**ATTACHED:**

**Revised Bid Form**

**SKL-1**

**Drawing L-1A Revised**

**Drawing L-2 Revised**

**Drawing L-7 Revised**

**END OF ADDENDUM NO. 1**

**Drake Playground, Improvements**

**SECTION 00310**

**FORM FOR GENERAL BID**

**DRAKE PLAYGROUND, IMPROVEMENTS  
WALTHAM, MASSACHUSETTS**

**General Bid Opening Date: 10 AM Thursday December 17, 2015**

Joseph Pedulla, CPO  
City of Waltham  
610 Main Street  
Waltham, MA 02452

**A. Base Price**

The undersigned:

\_\_\_\_\_  
(Please type or print the business name of the bidding firm)

having visited the site of the above project and having familiarized myself with the local conditions affecting the cost of the work and with the contract documents, including Amendments and Addenda No's.

\_\_\_\_\_, \_\_\_\_\_, \_\_\_\_\_, \_\_\_\_\_ hereby proposes to furnish all labor (including Sub Bids), materials, tools, equipment, insurance, permits and taxes, and to do and lawfully perform all things as provided in the specifications, all in accordance with the contract documents, for the sum of:

**BASE Bid (in words) \_\_\_\_\_, Dollars, \$ \_\_\_\_\_ (a)**

<b>POLICE DETAIL ALLOWANCE.....</b>	<b>\$ 5,000.00</b>	<b>(b)</b>
<b>ENVIRONMENTAL REMEDIATION ALLOWANCE.....</b>	<b>\$75,000.00</b>	<b>(c)</b>
<b>PURCHASE OF 5 YEAR LEASE FOR 3 SOLAR BIG BELLIES .....</b>	<b>\$25,000.00</b>	<b>(d)</b>

**GRAND TOTAL (a + b + c + d) \$ \_\_\_\_\_**

- B.** The undersigned agrees that, if s/he is selected as General Contractor, s/he will within five days, Saturdays, Sundays and legal holidays excluded, after presentation thereof by the Awarding Authority, execute a contract in accordance with the terms of this bid and furnish a performance bond and also a labor and materials or payment bond, each issued by a surety company qualified to do business under the laws of the Commonwealth and satisfactory to the Awarding Authority and each in the sum of the contract price, the premiums for which are to be paid by the General Contractor and are included in the contract price.
- C.** The undersigned certifies that s/he is able to furnish labor that can work in harmony with all other elements of labor employed or to be employed in the work and that s/he will comply fully with all laws and regulations applicable to awards made subject to section forty-four A.
- D.** The undersigned as Bidder certifies that if this proposal is accepted, s/he will furnish to the City of Waltham with the invoice for the material or equipment supplied two copies of any and all Material Safety Data

**Drake Playground, Improvements**

Sheets applicable to such material or equipment, as required by M.G.L. Chapter 111F, so called "Right to Know Law".

- E. The undersigned certifies under penalties of perjury that this bid is in all respects bona fide, fair and made without collusion or fraud with any other person. The word "person" shall mean any natural person, joint venture, partnership, corporation, or other business or legal entity.
  
- F. Substantial Completion
  - 1. The work of the Contract shall be Substantially Completed in one hundred and twenty **(120) calendar days from the date of the Notice-to-Proceed (NTP) or no later than one hundred and twenty (120) days from April 15, 2016.**
  
- G. In accordance with M.G.L. 30, 39M, the undersigned certifies that all employees to be employed at the worksite will have successfully completed a course in construction safety and health approved by OSHA that is at least 10 hours in duration at the time the employee begins work and shall furnish documentation of successful completion of said course with the first certified payroll report for each employee.

Sincerely,

\_\_\_\_\_  
(Bidder)

\_\_\_\_\_  
(Address of Bidder)

By: \_\_\_\_\_  
(Title - Owner\*, Partner\*)

(Seal, if Corporation)

By: \_\_\_\_\_  
(If Corporation - Name and Office)

\* If the business owned by the individual or partnership is conducted under a trade or assumed name, a certified copy of doing business under an assumed name should be annexed.

**DEMOLITION LEGEND**

- REMOVE & DISPOSE OF BITUMINOUS CONCRETE PAVING
- REMOVE & DISPOSE OF EXIST PLAY AREA: EQUIPMENT, FOOTINGS AND SURFACING
- REMOVE & DISPOSE OF CONCRETE PAVING
- EXISTING WOODS. CLEAR AND GRUB AS NECESSARY TO INSTALL NEW IMPROVMENTS. REFER TO SECTIONS 1,2/L-12
- REMOVE & DISPOSE OF SOIL IN OUTFIELD TO A DEPTH OF 8" BELOW PROPOSED FINISHED GRADE
- REMOVE & DISPOSE OF 4" DEPTH OF EXISTING INFIELD MIX OR SOIL
- REMOVE & DISPOSE OF CHAIN LINK FENCE & FOOTINGS
- REMOVE & DISPOSE OF EXISTING TREE AND STUMP
- REMOVE & DISPOSE OF EXISTING STUMP
- STRAW WATTLE EROSION CONTROL
- EXISTING TREE TO REMAIN
- EXISTING TREE TO REMAIN WITH TRUNK PROTECTION

REFER TO SITE PREPARATION PLAN 1B FOR GENERAL & SPECIAL NOTES, AND TEMPORARY SITE FENCING.

REMOVE & DISPOSE OF BITUMINOUS CONCRETE PAVING

APPROX. LOCATION OF EX. ELECTRICAL LINE FROM NSTAR UTILITY POLE #4 ON FARNSWORTH STREET TO SPRAY PARK ELECTRICAL CABINET. EXACT LOCATION UNKNOWN.

APPROX. AREA OF EXISTING WOODS. CLEAR & GRUB AS NECESSARY TO INSTALL NEW CHAIN LINK FENCE, INCLUDING STUMPS OF ANY REMOVED TREES. REMOVE UNDERGROWTH & SAPLING TREES AS DESCRIBED IN DETAILS 1,2/L-12.

REMOVE & DISPOSE OF CHAIN LINK FENCE & FOOTINGS

REMOVE & DISPOSE OF CONCRETE SIDEWALK PAVING TO NEAREST JOINT EAST OF ELECTRIC POLE. REMOVE & DISPOSE OF GRANITE CURBING & ROADWAY PAVING AS NECESSARY TO INSTALL NEW CURB TO NEAREST JOINT BEYOND EASTERN EDGE OF HC RAMP,

EX. CHAIN LINK FENCING TO REMAIN & BE PROTECTED

REMOVE & DISPOSE OF EXISTING CABINET, BACKFLOW PREVENTER AND APPURTENANCES, CONCRETE SLAB AND IRRIGATION CONTROLLER. SALVAGE SS CONTROLLER PEDESTAL FOR REUSE. MAINTAIN EXISTING ELECTRICAL SERVICE AND WATER SERVICE FOR CONNECTION TO NEW IRRIGATION SYSTEM

APPROXIMATE LOCATION OF ELECTRICAL LINE  
30" DRAINLINE - PROTECT FROM CONSTRUCTION ACTIVITIES

EXISTING TREES TO REMAIN AND BE PROTECTED, TYP. (3 L.18)

REMOVE & DISPOSE OF NET CLIMBER & FOOTINGS, MULCH & CURBING.

OUTLINE OF AREA OF NEW PAVING

REMOVE & DISPOSE OF TRASH RECEPTACLE & FOOTING

REMOVE & DISPOSE OF BITUMINOUS CONCRETE PAVING, TYPICAL, SAWCUT AT LIMIT OF REMOVAL

REMOVE & SALVAGE EXISTING 10 X 20 SHADE SHELTER, AND 2 BENCHES, FOR REINSTALLATION AT PROSPECT HILL PARK. R&D FOOTINGS. REFER TO SECTION 02800, SITE FURNISHINGS.

REMOVE & DISPOSE OF PORTION OF BITUMINOUS CONCRETE PAVING, SAW-CUT AT LIMIT OF REMOVAL

REMOVE & DISPOSE OF PORTION OF CHAIN LINK FENCING & FOOTINGS

REMOVE & DISPOSE OF ALL EXISTING STUMPS, TYP.

REMOVE & DISPOSE OF EXISTING TREE & STUMP, TYP. (3 L.18)

BENCHES & TRASH RECEPTACLE TO REMAIN & BE PROTECTED

REMOVE & DISPOSE OF TWO BASKETBALL STANDARDS, BACKBOARDS & GOALS. SAW-CUT EXISTING PAVING TO DIMENSION NECESSARY AND REMOVE FOOTINGS IN THEIR ENTIRETY.

INSTALL CATCH BASIN SILT BAG AT EXISTING CATCH BASIN TO BE REPLACED. DO NOT DEMOLISH EX. CB. UNTIL NEW CB. UNIT IS ONSITE AND INSTALLATION CAN PROCEED IMMEDIATELY. (5 L.23)

REFER TO SHEET L.1B FOR ADDITIONAL TREE & SHRUB REMOVAL

REMOVE & DISPOSE OF CONCRETE SIDEWALK PAVING - GRANITE CURB TO REMAIN & BE PROTECTED

EXCAVATE & DISPOSE OF SOIL FROM OUTFIELD TO A DEPTH OF 8" BELOW PROPOSED FINISHED GRADE, AND R&D EXISTING IRRIGATION SYSTEM

SAWCUT OR REMOVE TO NEAREST JOINT, TYP.

IN INFIELD, EXCAVATE AND DISPOSE OF 8" BELOW PROP. FIN. GRADE

STRAW WATTLE CONTINUOUS AT LIMIT OF GRADING (4 L.23)

BACKSTOP, BENCHES, & WALKWAY TO REMAIN & BE PROTECTED

CITY OF WALTHAM  
N/F WALTHAM  
ELEMENTARY SCHOOL  
PLYMOUTH

CONC. WALK  
BIT. WALK  
GRASS

CONC. WALK  
BIT. WALK  
GRASS

CONC. WALK  
BIT. WALK  
GRASS

CONC. WALK  
BIT. WALK  
GRASS

CONC. WALK  
BIT. WALK  
GRASS

CONC. WALK  
BIT. WALK  
GRASS

CONC. WALK  
BIT. WALK  
GRASS

CONC. WALK  
BIT. WALK  
GRASS

CONC. WALK  
BIT. WALK  
GRASS

CONC. WALK  
BIT. WALK  
GRASS

	ELEMENTS TO REMAIN	12/11/15
	ELEMENTS TO REMAIN	12/11/15
No.	Description	Date

REVISIONS

North

Project:  
**CITY OF WALTHAM  
 DRAKE PLAYGROUND  
 3 HAZEL STREET  
 WALTHAM, MA 02451**

Prepared For:  
**CITY OF WALTHAM  
 DEPARTMENT OF RECREATION  
 510 MOODY STREET  
 WALTHAM, MA 02453**

TITLE:  
**SITE PREPARATION  
 PLAN 1**

Scale 1" = 20' Date NOV 10, 2015  
 Drawn By CCC  
 Checked By DRB  
 Approved By CCC  
 Project No. 1313.00

DWG No. **L-1A**

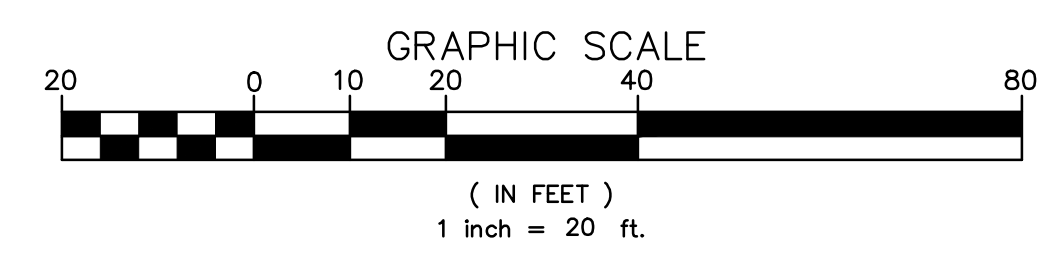



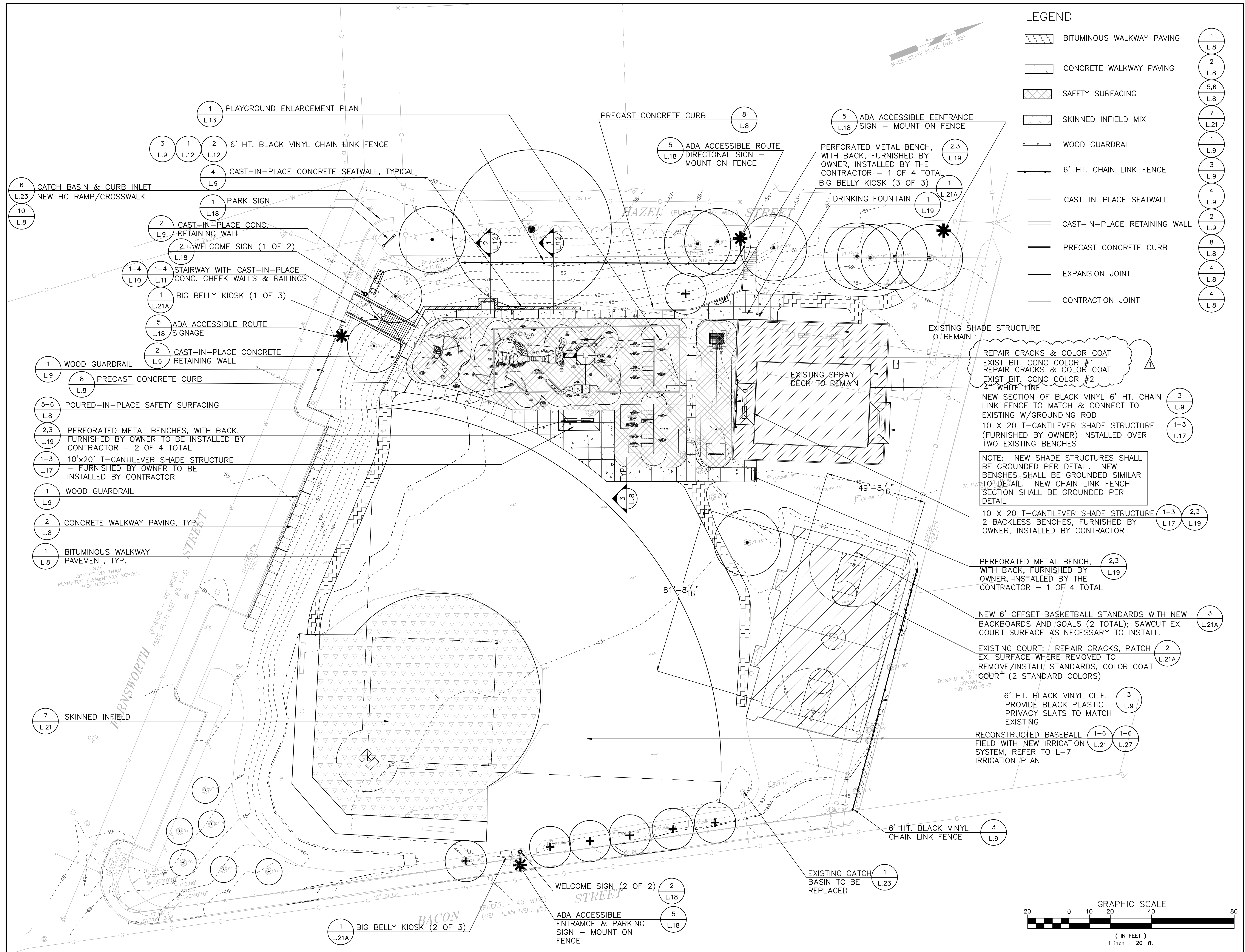

**LEGEND**

[Symbol]	BITUMINOUS WALKWAY PAVING	1
[Symbol]	CONCRETE WALKWAY PAVING	L.8
[Symbol]	SAFETY SURFACING	2
[Symbol]	SKINNED INFIELD MIX	L.8
[Symbol]	WOOD GUARDRAIL	5,6
[Symbol]	6' HT. CHAIN LINK FENCE	L.8
[Symbol]	CAST-IN-PLACE SEATWALL	7
[Symbol]	CAST-IN-PLACE RETAINING WALL	L.21
[Symbol]	PRECAST CONCRETE CURB	1
[Symbol]	EXPANSION JOINT	L.9
[Symbol]	CONTRACTION JOINT	3
[Symbol]		L.9
[Symbol]		4
[Symbol]		L.9
[Symbol]		2
[Symbol]		L.9
[Symbol]		8
[Symbol]		L.8
[Symbol]		4
[Symbol]		L.8
[Symbol]		4
[Symbol]		L.8

**Carolyn Cooney & Associates**

Site Engineering Consultants, Inc.  
CONSULTING CIVIL ENGINEERS

**alpha**  
SURVEYING AND ENGINEERING INC.

ALPHA SURVEYING AND ENGINEERING INC.  
695 WAREHAM STREET  
MIDDLEBOROUGH, MASSACHUSETTS 02346  
(508) 295-5505

No.	Description	Date
1	CRACK REPAIR AT SPRAY PARK	12/11/15

REVISIONS

[North Arrow]	[Professional Seal]
---------------	---------------------

Project:

**CITY OF WALTHAM  
DRAKE PLAYGROUND  
3 HAZEL STREET  
WALTHAM, MA 02451**

Prepared For:

**CITY OF WALTHAM  
DEPARTMENT OF RECREATION  
510 MOODY STREET  
WALTHAM, MA 02453**

TITLE:

**MATERIALS PLAN**

Scale 1" = 20' Date NOV 10, 2015  
 Drawn By CCC  
 Checked By DRB  
 Approved By CCC  
 Project No. 1313.00

DWG No. **L-2**

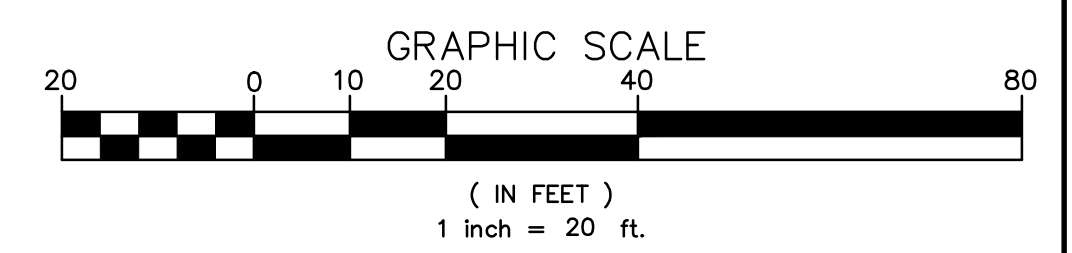



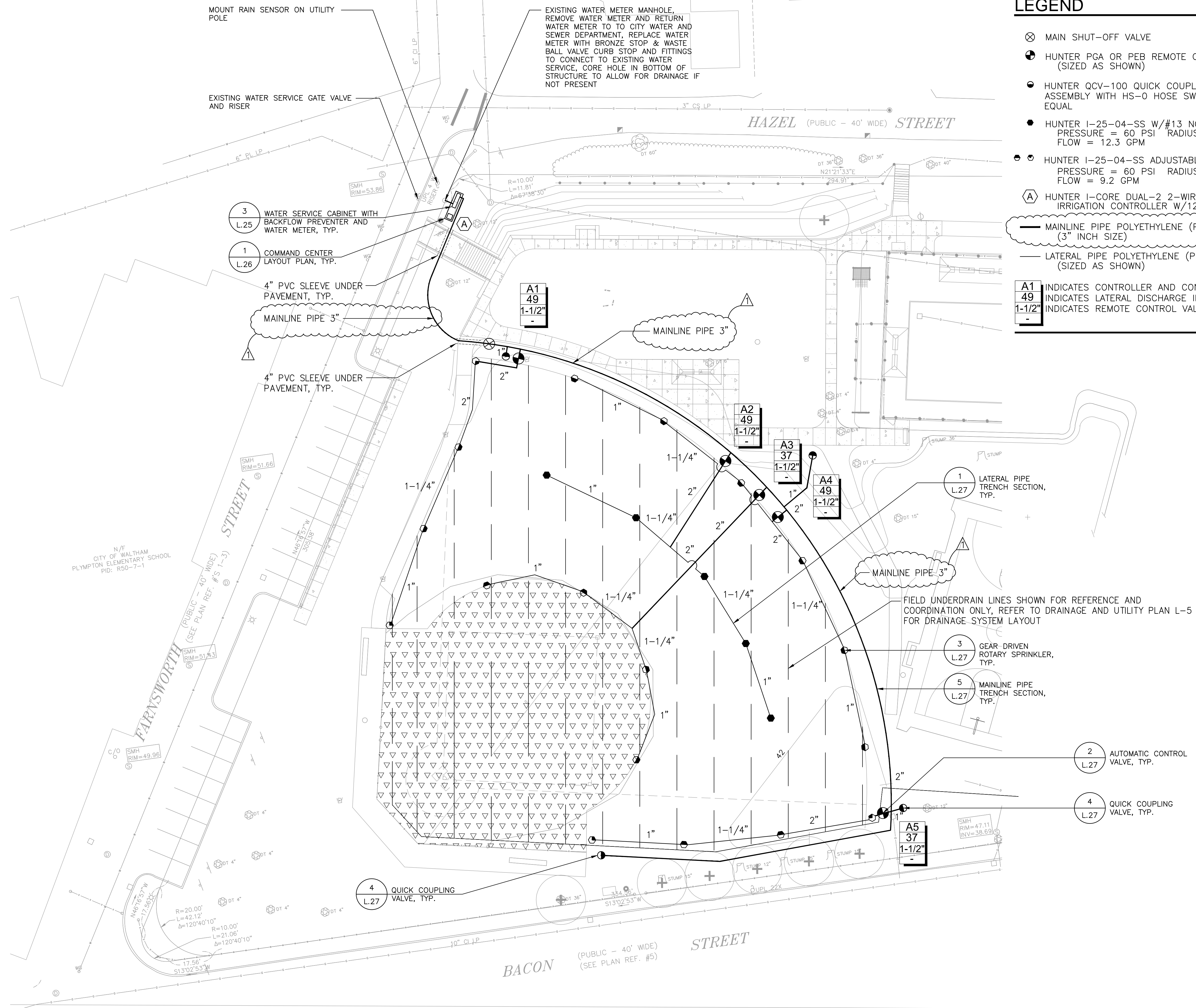

**LEGEND**

Symbol	Description	Quantity
⊗	MAIN SHUT-OFF VALVE	1
⊕	HUNTER PGA OR PEB REMOTE CONTROL VALVE (SIZED AS SHOWN)	5
⊙	HUNTER QCV-100 QUICK COUPLING VALVE AND KEY ASSEMBLY WITH HS-0 HOSE SWIVEL ADAPTOR, OR EQUAL	4
●	HUNTER I-25-04-SS W/#13 NOZZLE FULL CIRCLE PRESSURE = 60 PSI RADIUS = 54 FEET FLOW = 12.3 GPM	5
⊖	HUNTER I-25-04-SS ADJUSTABLE ARC W/#8 NOZZLE PRESSURE = 60 PSI RADIUS = 50 FEET FLOW = 9.2 GPM	14
⊕	HUNTER I-CORE DUAL-2 2-WIRE IRRIGATION CONTROLLER W/12 STATIONS	1
—	MAINLINE PIPE POLYETHYLENE (PE) (3" INCH SIZE)	
—	LATERAL PIPE POLYETHYLENE (PE) (SIZED AS SHOWN)	
A1 49 1-1/2"	INDICATES CONTROLLER AND CONTROLLER STATION NUMBER INDICATES LATERAL DISCHARGE IN GPM 1-1/2" INDICATES REMOTE CONTROL VALVE SIZE	

**Carolyn Cooney & Associates**

Landscape Architecture / Planning  
19 Elm Street, Milford, MA 01757  
Telephone 508 478 8426, Facsimile 508 478 8607

**Site Engineering Consultants, Inc.**  
55 Grape Shot Road  
Sharon, Massachusetts 02067  
TEL: (781) 784-0326  
FAX: (781) 784-0492  
CONSULTING CIVIL ENGINEERS

**alpha**  
SURVEYING and  
ENGINEERING INC.

**ALPHA SURVEYING AND ENGINEERING INC.**  
695 WAREHAM STREET  
MIDDLEBOROUGH, MASSACHUSETTS 02346  
(508) 295-5505

C:\Users\Carolyn\Desktop\CCC\_Stamp.jpg

ADDENDUM NO. 1 12/11/15

No.	Description	Date

REVISIONS

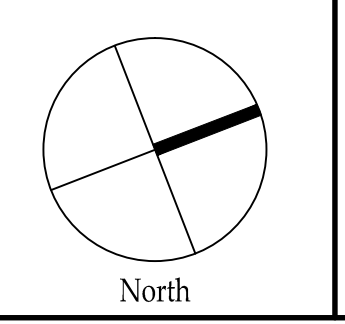

Project:  
**CITY OF WALTHAM  
DRAKE PLAYGROUND  
3 HAZEL STREET  
WALTHAM, MA 02451**

Prepared For:  
**CITY OF WALTHAM  
DEPARTMENT OF RECREATION  
510 MOODY STREET  
WALTHAM, MA 02453**

TITLE:  
**IRRIGATION  
PLAN**

Scale 1" = 20' Date NOV 10, 2015  
Drawn By CCC/AS  
Checked By DRB  
Approved By AS  
Project No. 1313.00

DWG No. **L-7**

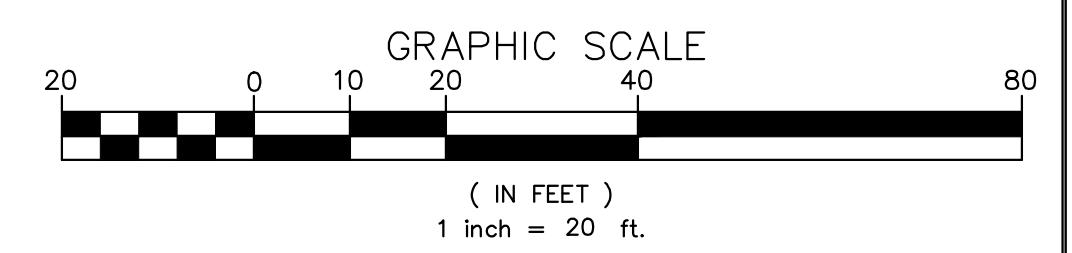



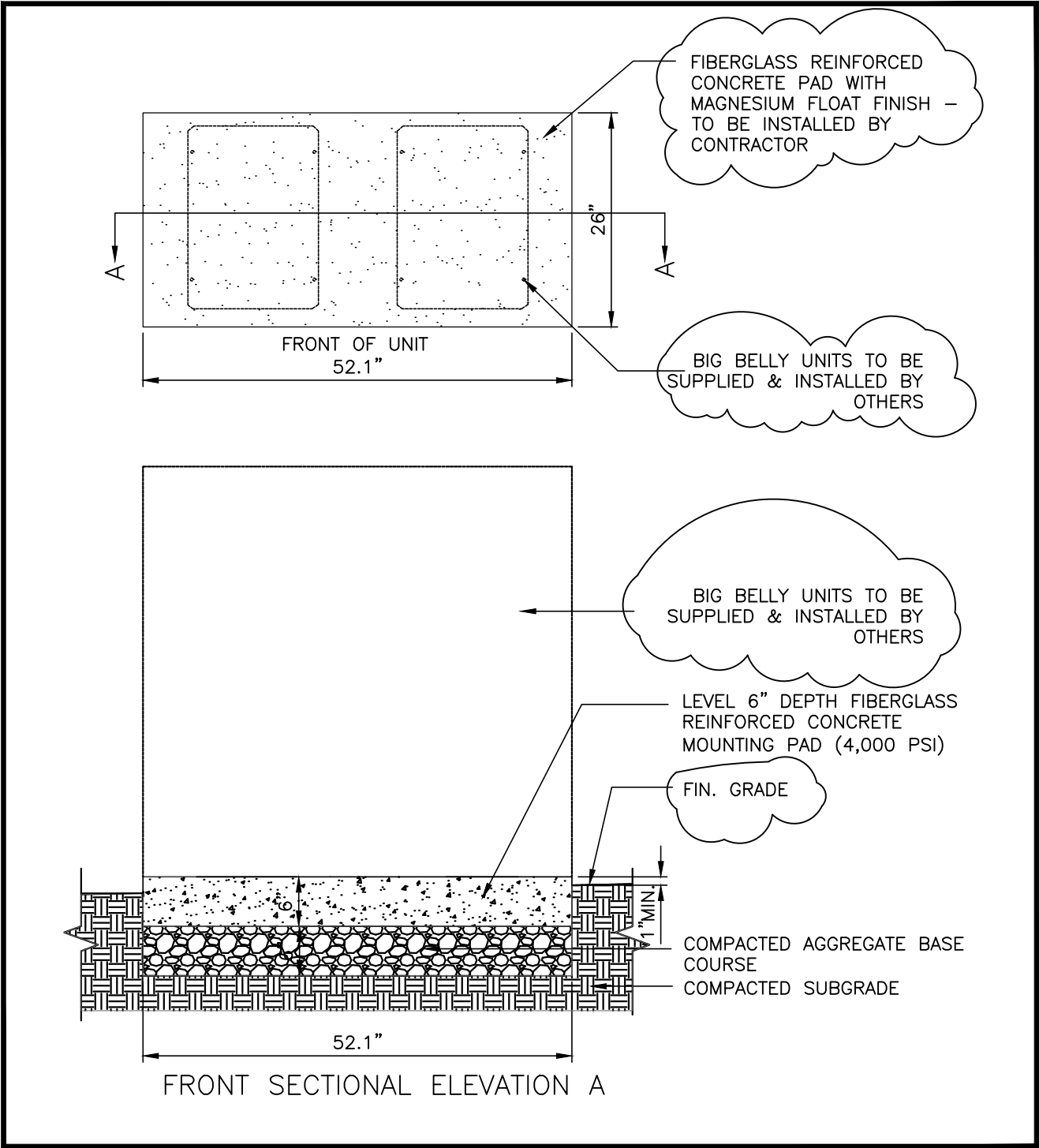

Project Title  
 DRAKE PLAYGROUND ADDENDUM NO. 1

Project Number  
 1313.00

Drawn By  
 CCC

Drawing Title  
 REVISION\_TO\_DETAIL\_1/L21A BIG\_BELLY\_KIOSK\_DETAIL

Scale  
 NTS

Date  
 12-11-2015

Drawing Number

**Carolyn Cooney and Associates**

13 Elm Street, Milford, Massachusetts 01757  
 Telephone 508.478.8426, Fax 508.478.8607

Landscape Architecture

SKL-1