

CONTINUED BELOW

- NOTES:
- FOR GENERAL TMP NOTES AND LEGEND, SEE SHEET CZSP-1.
 - TRAFFIC SIGNALS SHALL BE RESTORED TO NORMAL OPERATION DURING NON-WORK HOURS.
 - ALL SIDEWALK ADJACENT TO EXCAVATION SHALL BE PROTECTED BY SAFETY FENCE FOR THE ENTIRE LENGTH OF WORK ZONE.
 - PROVIDE PEDESTRIAN DETOUR AS SHOWN ON THE PEDESTRIAN DETOUR DETAIL ON SHEETS CZSP-4, 25-28.
 - CONTRACTOR SHALL REPLACE TRAFFIC LOOP DETECTORS AND RESTORE TRAFFIC SIGNAL OPERATIONS IMMEDIATELY AFTER COMPLETING THE WORK.
 - WORK AT THIS LOCATION SHALL OCCUR BETWEEN 8:00 PM AND 6:00 AM. WORK SHALL NOT OCCUR ON WEEKENDS.

FOR ALL WORK AT OR SOUTH OF LINCOLN STREET, MAINTAIN TWO-WAY TRAVEL ON LEXINGTON STREET NORTH OF LINCOLN STREET

ONE LANE OF TRAFFIC SHALL BE MAINTAINED IN THE SOUTHBOUND DIRECTION. MINIMUM LANE WIDTH SHALL BE 11 FEET EXCLUDING WIDTH OF DRUMS OR OTHER BARRIERS

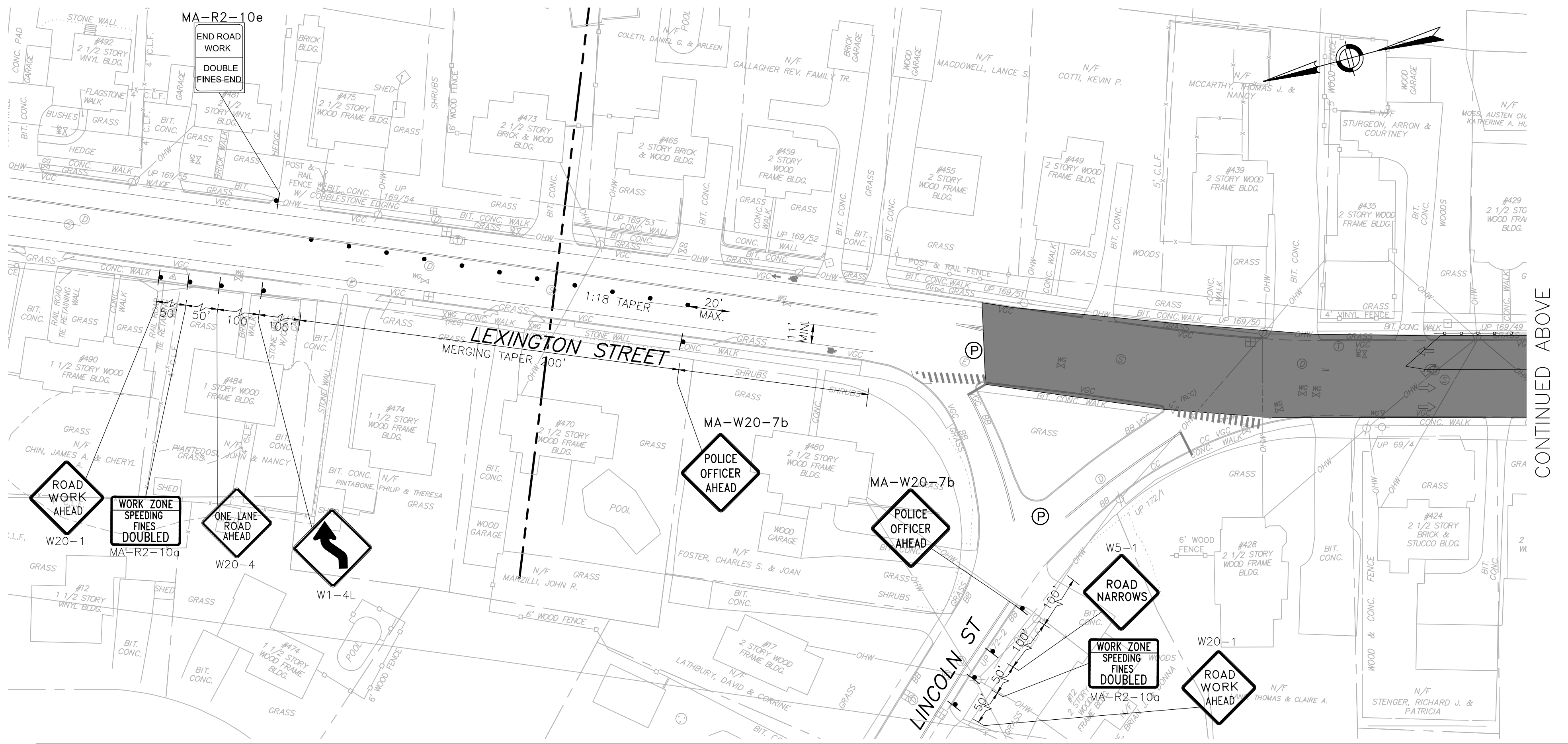
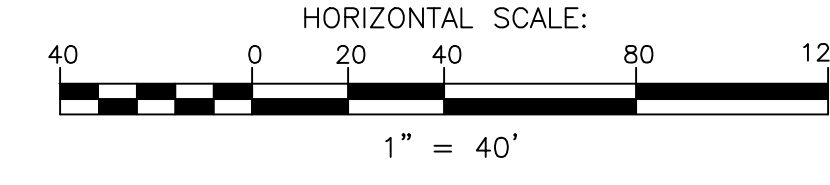
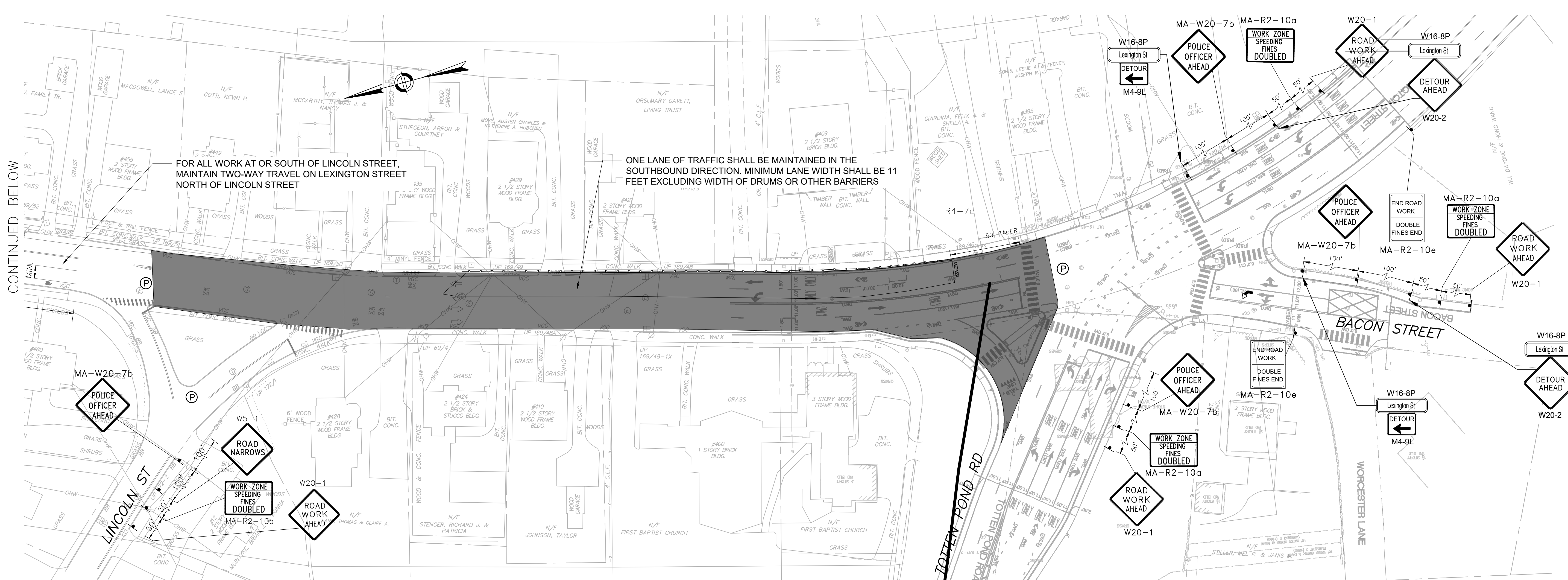

CONTINUED ABOVE

NO.	DATE	BY	CHK'D	REVISION

CONTRACT NO. :	CAD FILE NO. :
ACCESSION NO. : 705547	SECTION NO. : 101
DATE:	DESIGNED BY: SM
SCALE:	DRAWN BY: LB
	CHECKED BY: SM
	APPROVED BY: SMS

MASSACHUSETTS WATER RESOURCES AUTHORITY

PREPARED BY: GREEN INTERNATIONAL AFFILIATES, INC.
CIVIL & STRUCTURAL ENGINEERS
100 AMES POND DRIVE, SUITE 200
TEWKSBURY, MASSACHUSETTS

SECTION 101 EXTENSION

CONSTRUCTION ZONE SAFETY PLAN
LEXINGTON STREET AND TOTTEN POND ROAD
WORK ZONE AND SOUTHBOUND PATTERN

DRAWING NO. CZSP ADD-01
1 OF 3

APPROX. N

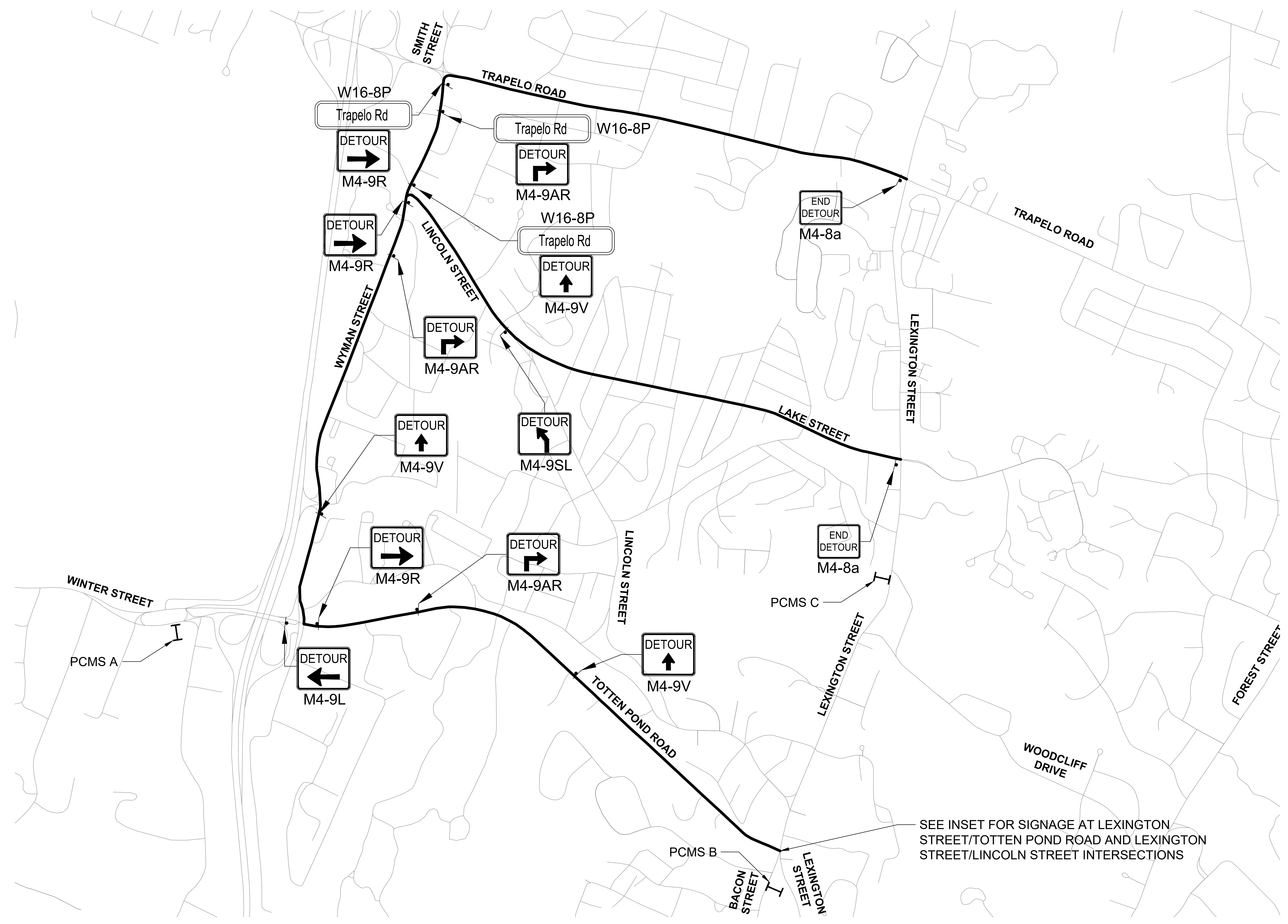
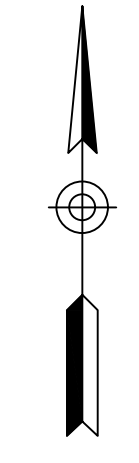

PCMS ADVANCE NOTIFICATION MESSAGES - PCMS A,B	
MESSAGE 1	MESSAGE 2
LEXINGTON ST N-BND CLOSURE	MM/DD TO MM/DD

ADVANCE NOTIFICATION SHALL BE SHOWN FOR TWO WEEKS IN ADVANCE OF CLOSURE.

PCMS MESSAGES DURING DETOUR - PCMS A,B	
MESSAGE 1	MESSAGE 2
LEXINGTON ST N-BND CLOSURE	AT NIGHT FOLLOW DETOUR

PCMS ADVANCE NOTIFICATION MESSAGES - PCMS C	
MESSAGE 1	MESSAGE 2
LEXINGTON ST LANE CLOSURE	MM/DD TO MM/DD

ADVANCE NOTIFICATION SHALL BE SHOWN FOR TWO WEEKS IN ADVANCE OF CLOSURE.

PCMS MESSAGES DURING DETOUR - PCMS C	
MESSAGE 1	MESSAGE 2
LEXINGTON ST LANE CLOSURE	ROADWAY NARROWS

NOTE:

- CONTRACTOR SHALL COORDINATE WITH MASSDOT REGARDING PLACEMENT OF TEMPORARY TRAFFIC CONTROL DEVICES ON WINTER STREET, WYMAN STREET OR TRAPELO ROAD IN VICINITY OF THE I-95 / WINTER STREET INTERCHANGES
- TRAFFIC CONTROL DEVICES SHOWN ON THIS SHEET SHALL BE IMPLEMENTED CONCURRENTLY WITH THE ITEMS SHOWN ON LEXINGTON STREET NORTHBOUND DETOUR PLAN 2.

SEE INSET FOR SIGNAGE AT LEXINGTON STREET/TOTTEN POND ROAD AND LEXINGTON STREET/LINCOLN STREET INTERSECTIONS

LEXINGTON STREET NORTHBOUND DETOUR PLAN 1

NOT TO SCALE

- LEGEND:**
- WORK ZONE
 - SIGN
 - TYPE III BARRICADE
 - PORTABLE CHANGEABLE MESSAGE SIGN (PCMS)

NO.	DATE	BY	CHK'D	REVISION

CONTRACT NO. :	CAD FILE NO. :
ACCESSION NO. :	SECTION NO. : 101
DATE:	DESIGNED BY: SM
SCALE:	DRAWN BY: LB
	CHECKED BY: SM
	APPROVED BY: SMS

MASSACHUSETTS WATER RESOURCES AUTHORITY

PREPARED BY: GREEN INTERNATIONAL AFFILIATES, INC.
CIVIL & STRUCTURAL ENGINEERS
100 AMES POND DRIVE, SUITE 200
TEWKSBURY, MASSACHUSETTS

SECTION 101 EXTENSION

CONSTRUCTION ZONE SAFETY PLAN
LEXINGTON STREET AND TOTTEN POND ROAD
LEXINGTON ST NORTHBOUND DETOUR 1

DRAWING NO.
CZSP
ADD-02

2 OF 3

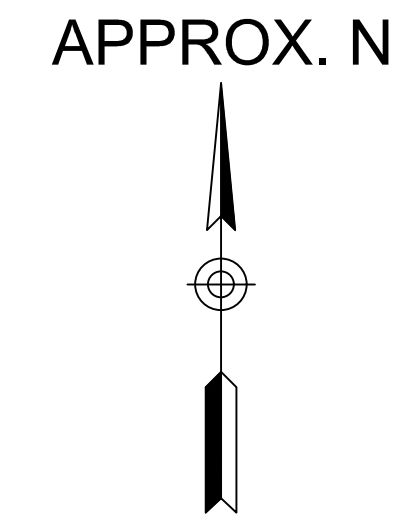
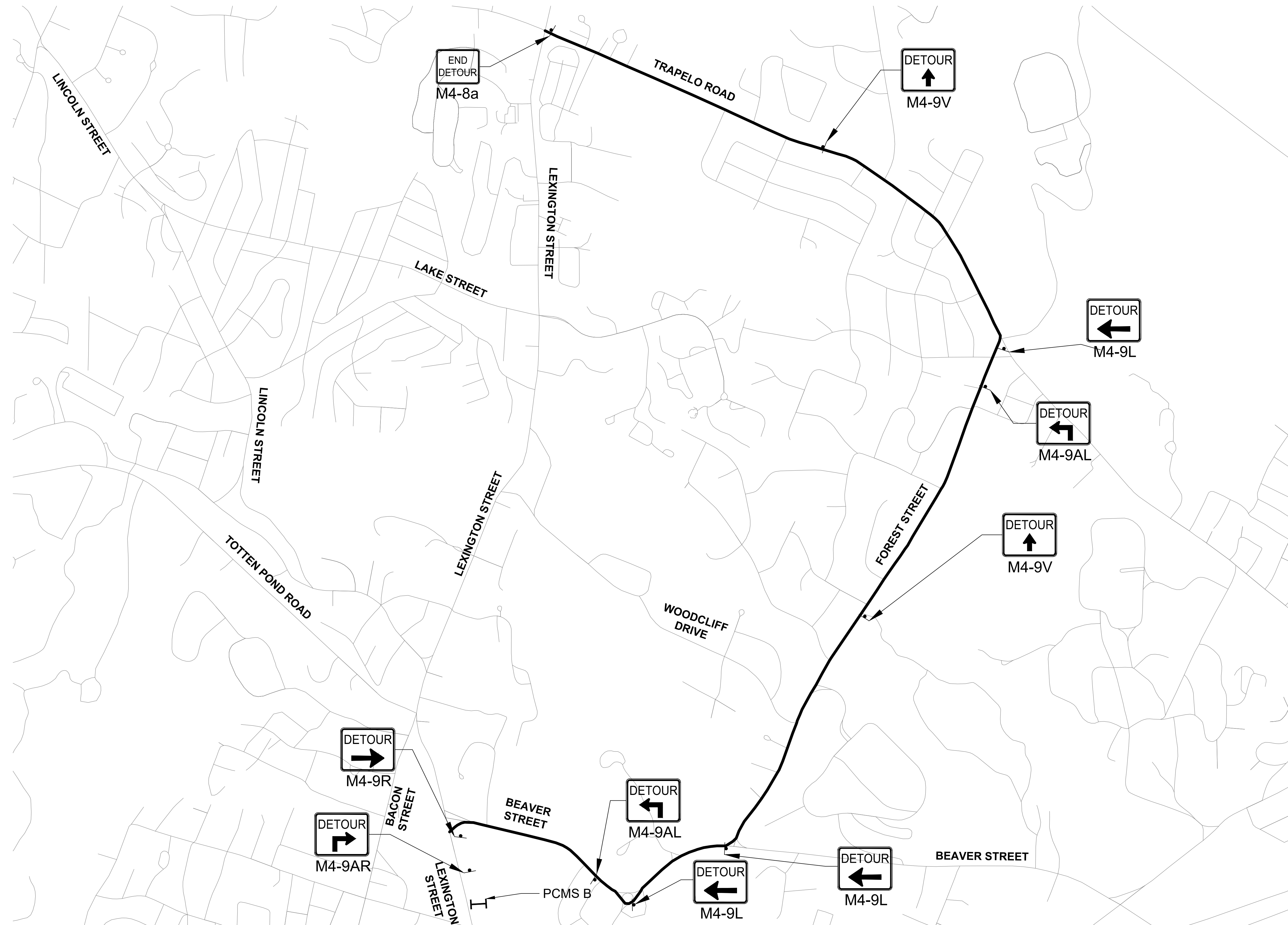

PCMS ADVANCE NOTIFICATION MESSAGES - PCMS D	
MESSAGE 1	MESSAGE 2
LEXINGTON ST N-BND CLOSURE	MM/DD TO MM/DD

ADVANCE NOTIFICATION SHALL BE SHOWN FOR TWO WEEKS IN ADVANCE OF CLOSURE.

PCMS MESSAGES DURING DETOUR - PCMS D	
MESSAGE 1	MESSAGE 2
LEXINGTON ST N-BND CLOSURE	DETOUR VIA BEAVER

NOTE:

1. TRAFFIC CONTROL DEVICES SHOWN ON THIS SHEET SHALL BE IMPLEMENTED CONCURRENTLY WITH THE ITEMS SHOWN ON LEXINGTON STREET NORTHBOUND DETOUR PLAN 2.

LEXINGTON STREET NORTHBOUND DETOUR PLAN 2

NOT TO SCALE

- LEGEND:**
- WORK ZONE
 - SIGN
 - TYPE III BARRICADE
 - PORTABLE CHANGEABLE MESSAGE SIGN (PCMS)

NO.	DATE	BY	CHK'D	REVISION

CONTRACT NO. :	CAD FILE NO. :
ACCESSION NO. :	SECTION NO. : 101
DATE:	DESIGNED BY: SM
SCALE:	DRAWN BY: LB
	CHECKED BY: SM
	APPROVED BY: SMS

MASSACHUSETTS WATER RESOURCES AUTHORITY

PREPARED BY: GREEN INTERNATIONAL AFFILIATES, INC.
CIVIL & STRUCTURAL ENGINEERS
100 AMES POND DRIVE, SUITE 200
TEWKSBURY, MASSACHUSETTS

SECTION 101 EXTENSION

CONSTRUCTION ZONE SAFETY PLAN
LEXINGTON STREET AND TOTTEN POND ROAD
LEXINGTON ST NORTHBOUND DETOUR 2

DRAWING NO.
CZSP
ADD-03

3 OF 3